

# ±18,600 SF (TWO BUILDINGS) METAL AND OFFICE BUILDINGS ON ±4.4 ACRES OF INDUSTRIAL LAND

## 23447 CAJALCO ROAD, PERRIS, CA











**Voit**

REAL ESTATE SERVICES

**SHY ASSAR**, MBA, MRED, SIOR  
Senior Vice President, Partner  
(909) 545-8091  
sassar@voitco.com  
Lic. # 01964667

**BRADEN SPRENGER**, MSRE  
Associate  
(909) 545-8012  
bsprengr@voitco.com  
Lic. # 02190434

## SPECIFICATIONS

	<b>Address</b>	23447 Cajalco Rd. Perris, CA
	<b>Land</b>	±4.4 AC (±192,800 SF)
	<b>Building</b>	<ul style="list-style-type: none"> <li>• Metal Building: ±16,442 SF</li> <li>• Office Building: ±2,158 SF</li> </ul>
	<b>Clear Height</b>	18'-30' (Verify)
	<b>Ground Level Door(s)</b>	Two (2) Oversized Doors
	<b>Zoning</b>	M-SC Manufacturing - Service Commercial
	<b>Parking Spaces</b>	20
	<b>Property Type</b>	Industrial - Light Manufacturing
	<b>Year Built</b>	1998



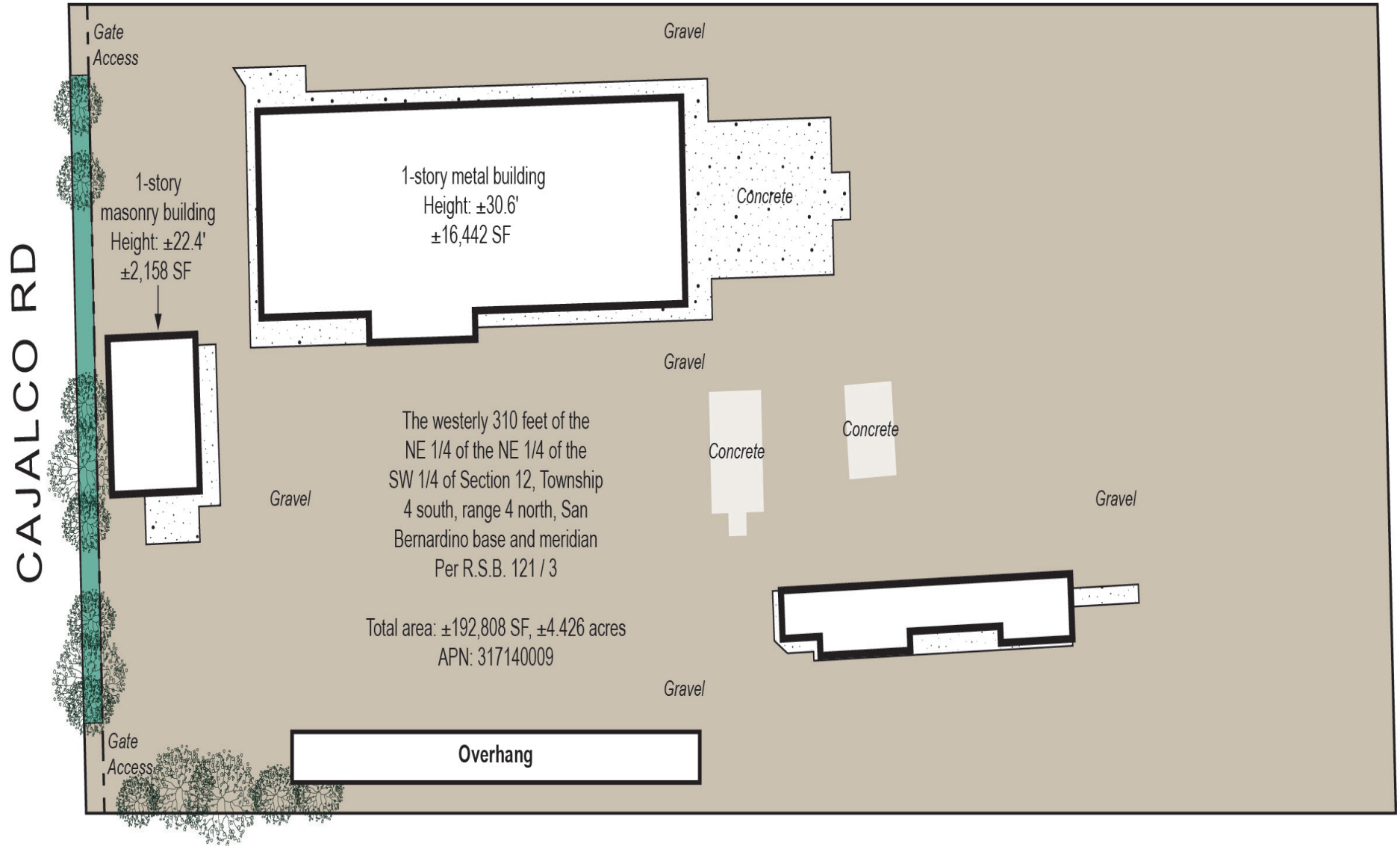



±18,600 SF (TWO BUILDINGS) METAL AND OFFICE  
BUILDINGS ON ±4.4 ACRES OF INDUSTRIAL LAND

23447 CAJALCO ROAD, PERRIS, CA

Cajalco Rd

*For More Information, Please Contact:*

**Voit**

REAL ESTATE SERVICES

**SHY ASSAR**, MBA, MRED, SIOR  
Senior Vice President, Partner  
(909) 545-8091  
sassar@voitco.com  
Lic. # 01964667

**BRADEN SPRENGER**, MSRE  
Associate  
(909) 545-8012  
bsprengr@voitco.com  
Lic. # 02190434

3280 E. Guasti Road Suite 100, Ontario, CA 91761 • 909.545.8000 • 909.354.3253 Fax | [www.voitco.com](http://www.voitco.com)

The information contained herein has been obtained from sources we deem reliable. While we have no reason to doubt its accuracy, we do not guarantee it. Licensed as Real Estate Salespersons by the DRE.  
©2026 Voit Real Estate Services, Inc. All Rights Reserved. License #01991785.