

173.1 acres
divisible to 8.3 Acres

CONNECT₄₇₀



Industrial Zoned Land Fronting E-470

Access to significant infrastructure for
high power industrial uses

Outside storage available

SEC of Jewell & E-470



Site Highlights

- ✕ Site size: ±173.1 acres (divisible to ±8.3 acres)
- 🏠 Over 2 million SF buildable
- 🛣️ Over 4,000ft of highway frontage along E-470
- 🚗 50,000 vehicles per day on E-470
- 📍 Zoning: Airport district
- 🎯 County: Arapahoe County
- 📍 City: Aurora
- ⚡ Xcel Transmission System Interconnection (application made December 2025)
- ✅ Application has been submitted for up to 500MW for high power manufacturing and data center uses
- 🏠 Potential for outside storage uses



Infrastructure



Current

- Existing 24" water main
- Xcel 230kV transmission line runs along SEC of site
- Multiple options for location of regional storm water detention
- Master drainage plan completed and approved



In-Progress

to be completed
end of 2026

- 18' sanitary main permitted and will commence construction in Q1 2025
- Gun Club road improvements
- Sewer interceptor under construction
- Option for on-site substation to dramatically increase MW capacity



Location Highlights

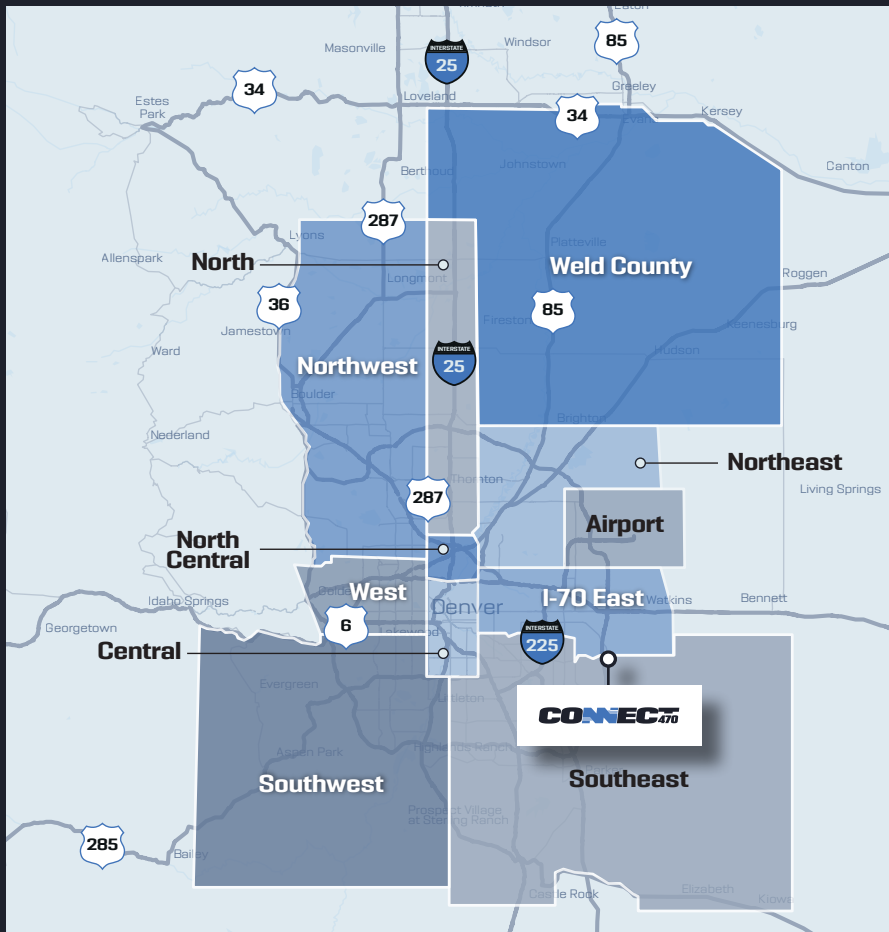

At the
crossroads
between
the Southeast
and I-70 East
submarkets

- Situated on the border of the **Southeast** and **I-70/East** submarkets with connectivity throughout the entire **Denver Metro Area**
- Boasts highway frontage with direct access to **E470** and **Jewell Avenue**
- Potential for a dedicated exit from **E470**
- Just 20 minutes from the **Denver Tech Center** and 24 minutes from **Downtown Denver**
- Immediate proximity to **Buckley Space Force Space** who contributes over \$2.5 Billion to the local economy
- Less than 10 minutes from **Southlands Mall**, which is the largest mall in Denver
- Neighbors with Denver's top **labor demographics**

Drive Times



I-70:

5.4 miles/
6 minutes



DIA:

16.6 miles/
14 minutes



Denver Tech Center:

12 miles/
20 minute



I-225:

8.8 miles/
12 minutes



Downtown Denver:

23 miles/
24 minutes

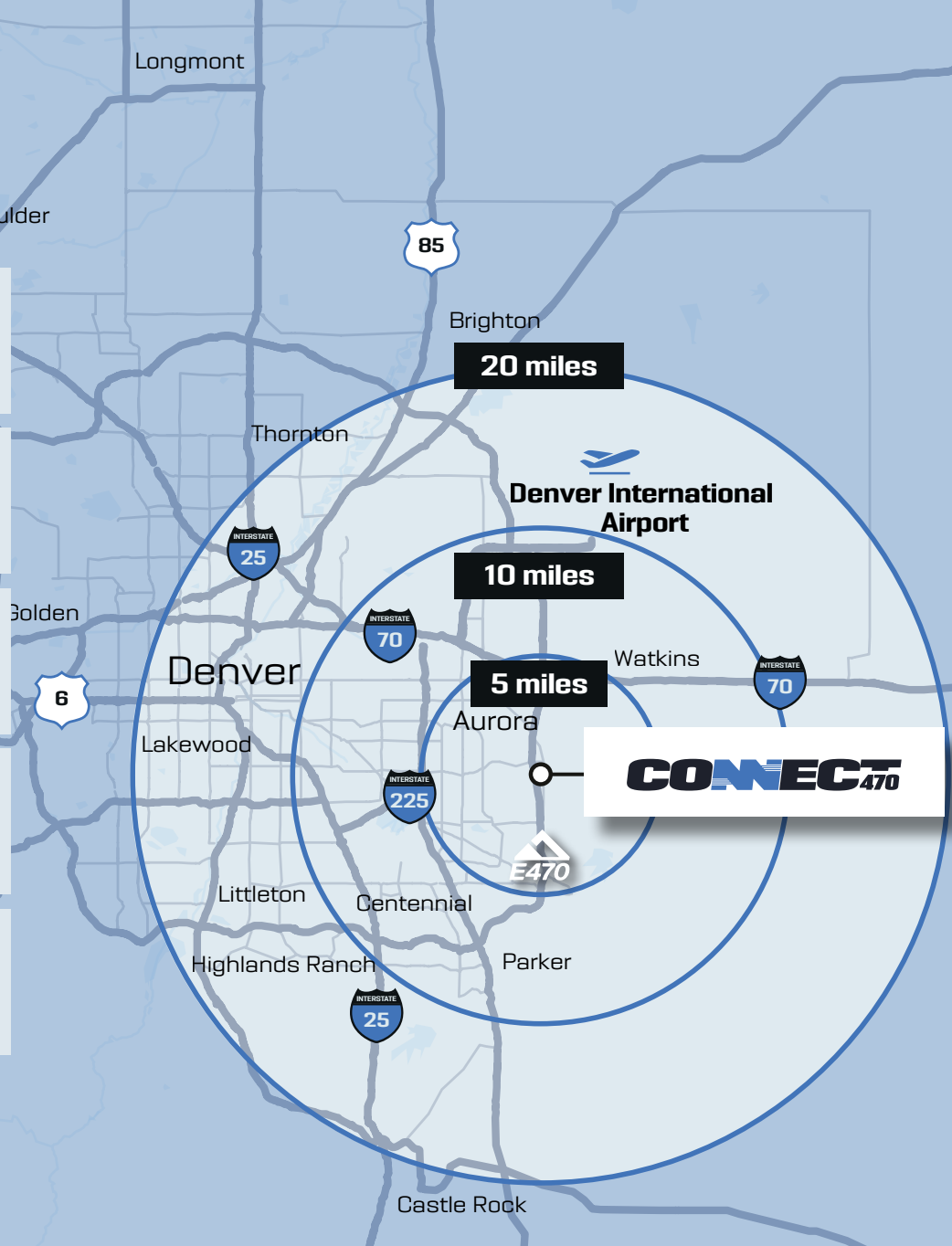

▶ Arapahoe County, Co

▶ Douglas County, Co



Population

672,666 (2024)

393,715 (2024)



Population
Groth Rate

**1.01%
annual growth rate**

**1.66%
annual growth rate**



Median Age

37

39



Average
Household Income

\$138,737

\$183,603



Median
Household Income

\$97,738

\$145,412

Immediate Proximity to

Buckley Space Force & Southeast Denver

► Buckley Space Force Base



Generated **\$2.6 billion**
in regional economic impact
in 2024



20,000+ jobs
driven by base operations

► Raytheon
2,500
employees

► Northrop Grumman
400
employees

► Centennial Airport



3rd busiest
general aviation airport

► Denver Tech Center Office Market



Largest office
submarket in Denver
totaling 35MSF



Flexible Build-to-Suit Options

Site Plan Example

Build-to-suit options
for lease and sale

Divisible to 8.3 acres

32'-36' clear height

Outside storage available

High power industrial uses

Lot	Acerage
Lot 1	± 26.8
Lot 2	± 15.9
Lot 3A	± 14.4
Lot 3B	± 5.0
Lot 4	± 17.9
Lot 5	± 13.5
Lot 6	± 12.6
Lot 7	± 8.3
Lot 8	± 46.8

Building	Square Footage
Building 1	± 249,480
Building 4	± 163,800
Building 7	± 93,600
Building 8A	± 66,560
Building 8B	± 66,560
Building 8C	± 66,560
Building 8D	± 66,560
Building 8E	± 66,560

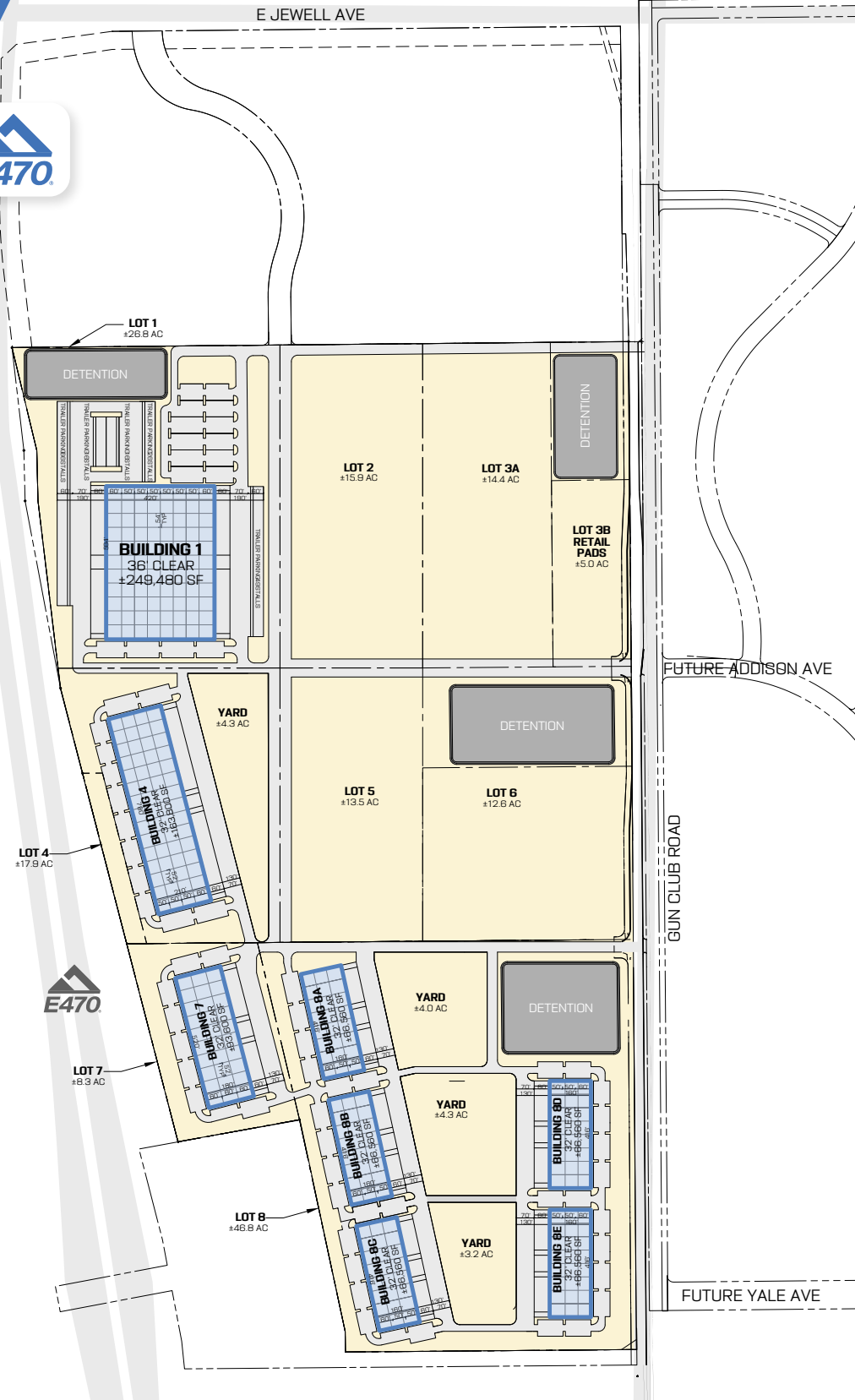



Harvest Mile Substation (3 miles)

Southlands Mall

Denver Tech Center

E470

Aurora Open Space

Gun Club Road



Walmart

E Jewel Ave

CONTACTS

Jason Addlesperger
+1 720-217-3403
jason.addlesperger@jll.com

David Lee
+1 720-217-7223
david.lee1@jll.com

Philip Lee
+1 303-257-5915
philip.lee1@jll.com

Although information has been obtained from sources deemed reliable, JLL does not make any guarantees, warranties or representations, express or implied, as to the completeness or accuracy as to the information contained herein. Any projections, opinions, assumptions or estimates used are for example only. There may be differences between projected and actual results, and those differences may be material. JLL does not accept any liability for any loss or damage suffered by any party resulting from reliance on this information. If the recipient of this information has signed a confidentiality agreement with JLL regarding this matter, this information is subject to the terms of that agreement. (C)2025 Jones Lang LaSalle Brokerage, Inc. All rights reserved.

