

PINEDA PLAZA AT SUNTREE, A COMMERCIAL CONDOMINIUM PHASE ONE

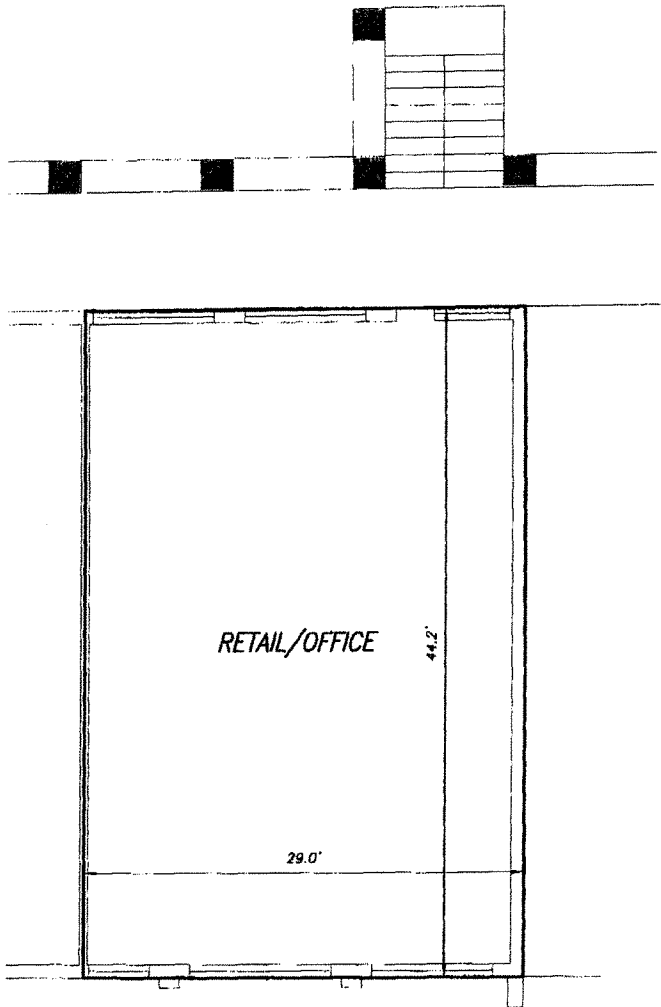

UNIT 214

SCALE: 1"=10'



SURVEYOR'S NOTES:

1. ——— INDICATES THE LIMITS OF THE UNIT.
2. ALL AREAS AND IMPROVEMENTS EXCLUSIVE OF THE UNIT ARE COMMON ELEMENTS OF THE CONDOMINIUM.
3. THE UNIT PLAN SHOWN IS REPRESENTATIONAL. THE DIMENSIONS MAY VARY SLIGHTLY.
4. UNIT 214 CONTAINS 1283 SQUARE FEET ±.

ALLEN ENGINEERING, INC.
106 DIXIE LANE
COCOA BEACH, FLORIDA
OCTOBER 7, 2005

EXHIBIT "A"

SHEET 36 OF 38