



TOP FLOOR FURNISHED SUBLEASE AVAILABLE



BETHESDA ROW SUBLEASE

7255 WOODMONT AVE
BETHESDA, MD 20814

17,000 SF

SPACE HIGHLIGHTS

Available immediately

Flexible term available (2-8 yrs)

On-site parking to convey with sublease

Fully built out – high end space with glass, open ceiling concepts, and modern finishes

Open space plan with multiple conference rooms, offices, phone rooms, and two kitchenettes

Adjacent to 4-story public parking garage if extra parking is needed

4-minute walk from Bethesda Metro Station

Steps away from Bethesda Row retail and dining amenities

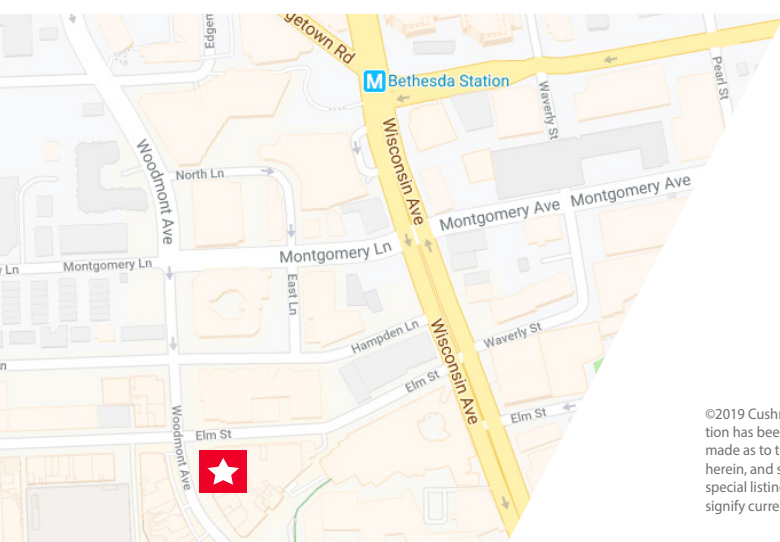

GWEN FRAKER

Director

+1 301 634 2383

gwen.fraker@cushwake.com

2 Bethesda Metro Center, Suite 860 | Bethesda, MD 20814
Main +1 301 654 9700
cushmanwakefield.com

©2019 Cushman & Wakefield. All rights reserved. The information contained in this communication is strictly confidential. This information has been obtained from sources believed to be reliable but has not been verified. No warranty or representation, express or implied, is made as to the condition of the property (or properties) referenced herein or as to the accuracy or completeness of the information contained herein, and same is submitted subject to errors, omissions, change of price, rental or other conditions, withdrawal without notice, and to any special listing conditions imposed by the property owner(s). Any projections, opinions or estimates are subject to uncertainty and do not signify current or future property performance.



BETHESDA ROW SUBLEASE

7255 WOODMONT AVE, BETHESDA, MD

17,000 SF

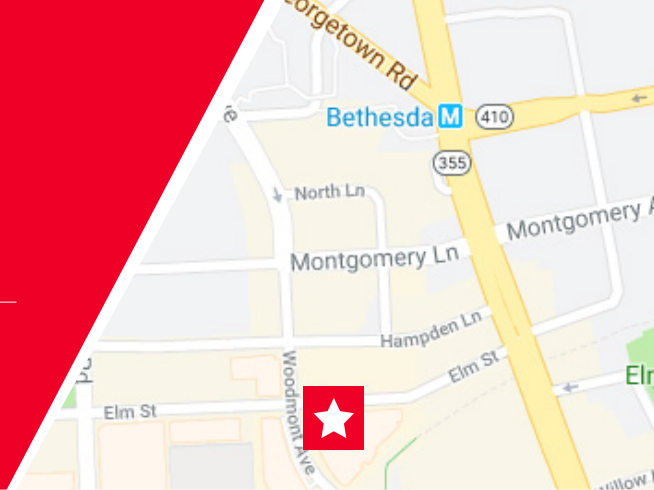

FLOOR PLAN (SPACE IS FURNISHED)

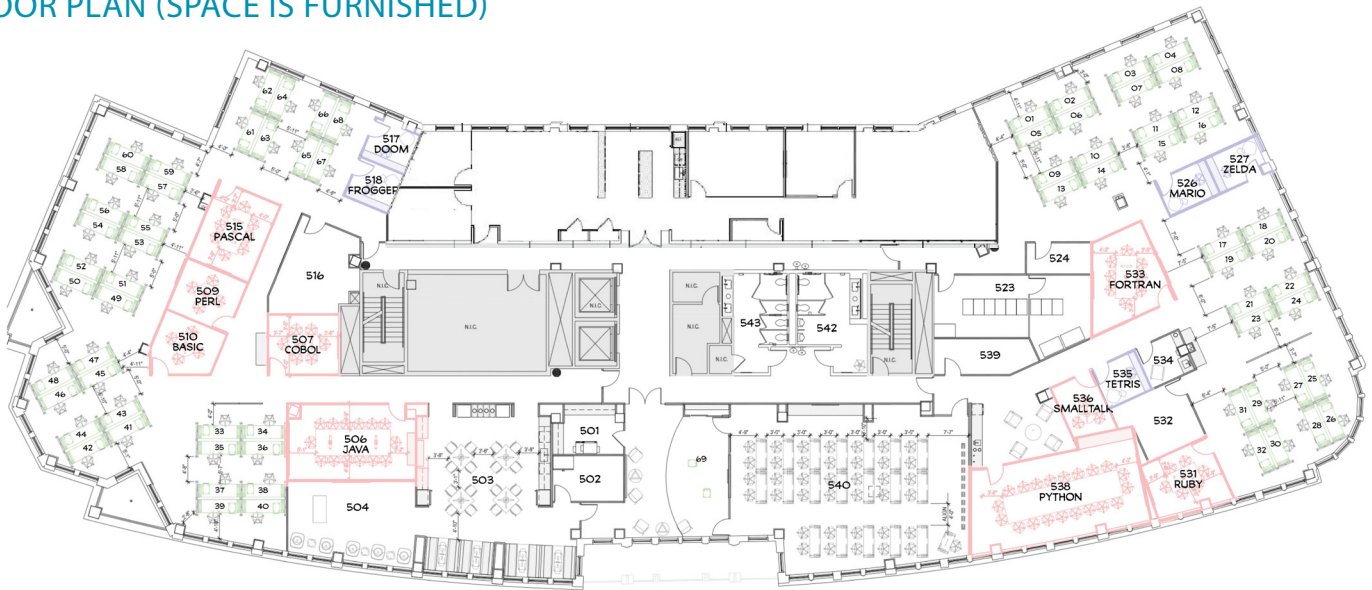

INTERIOR PHOTOS



GWEN FRAKER
Director
+1 301 634 2383
gwen.fraker@cushwake.com

2 Bethesda Metro Center,
Suite 860
Bethesda, MD 20814
Main +1 301 654 9700
cushmanwakefield.com

