

±66,870 SF

**8385 Eastgate Road, Suite 140 & 150**  
**Henderson, NV 89015 USA**

Prologis Henderson  
 Distribution Center 1

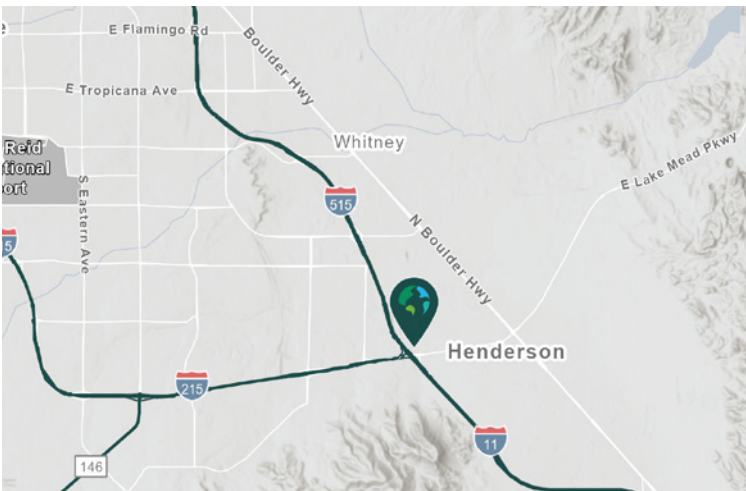

- Desirable Henderson location at the intersection of Eastgate Road & Lake Mead Parkway
- Quick access to US-95 and I-215 freeways
- Zoned: General Industrial (I-G)
- City of Henderson jurisdiction
- Professionally owned and managed by Prologis
- Functional design, turn-key unit
- ±0.3mi from I-11 and I-215 freeways

## Property Features

Available Space	±66,870 SF
Office SF	±3,422 SF
Clear Height	31'
Dock Doors	9
Drive-in Doors	3
Pit Levelers	7
Warehouse Cooling	Evaporative
Parking Spaces	0.86/1,000 SF
Sprinkler	ESFR
Lighting	LED
Power	800 A, 277/480 V, 3-Phase



Unlock the full potential of your warehouse with one strategic, single-source partner.



Suite 140 & 150

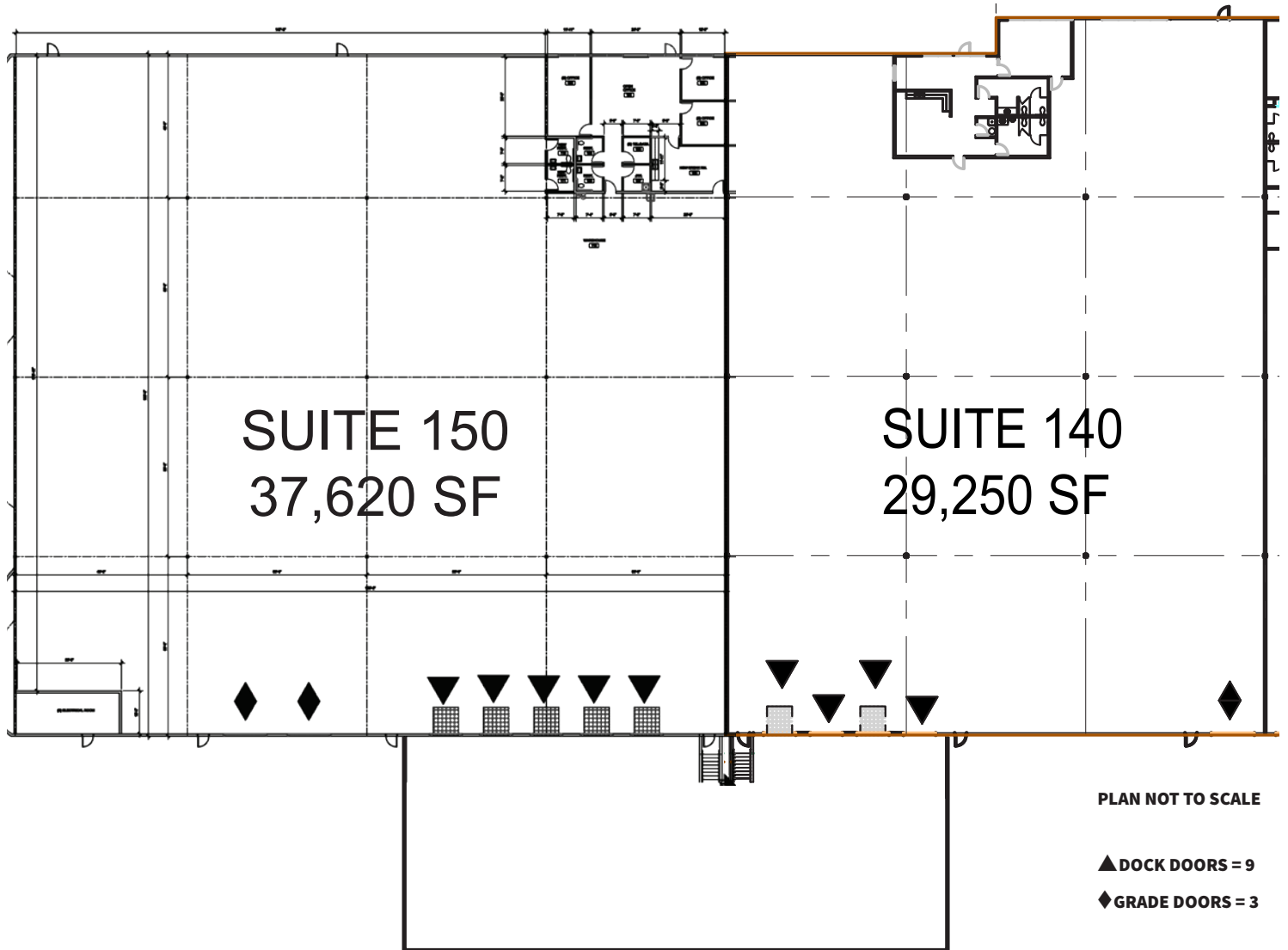

PLAN NOT TO SCALE

▲ DOCK DOORS = 9

◆ GRADE DOORS = 3



**CBRE**  
**Jake Higgins, SIOR**  
 Executive Vice President  
[jake.higgins@cbre.com](mailto:jake.higgins@cbre.com)  
 1 702 369 4844  
 NV LIC. #S.0176473

**CBRE**  
**Kelsey Higgins**  
 Senior Associate  
[kelsey.higgins@cbre.com](mailto:kelsey.higgins@cbre.com)  
 1 702 369 4812  
 NV LIC. #S.0192524

**Prologis**  
**Johana Gonzalez**  
 Leasing Associate  
[jgonzalez2@prologis.com](mailto:jgonzalez2@prologis.com)  
 1 702 891 9510  
 NV LIC. #S.0202094



Unlock the full potential of your warehouse with one strategic, single-source partner.



# Racking Solutions

We can provide a custom design that's right for your operation

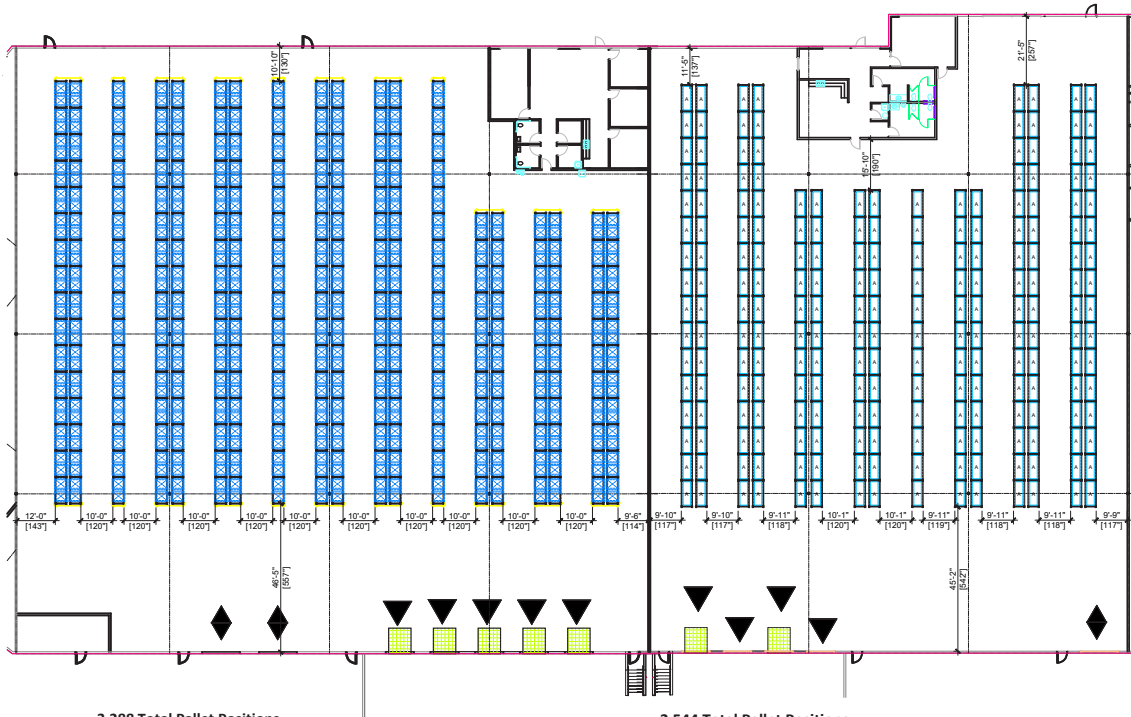

**3,288 Total Pallet Positions**

10'-0" Aisle (Typical)

New and Used Racking Available

**2,544 Total Pallet Positions**

10'-0" Aisle (Typical)

New and Used Racking Available

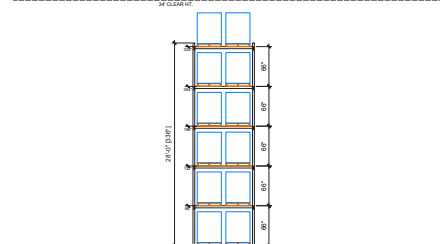
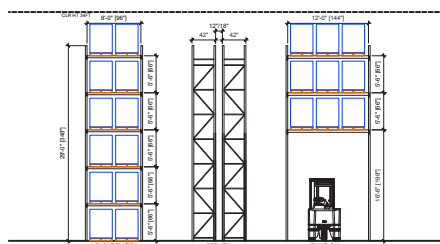

**CBRE**  
**Jake Higgins, SIOR**  
 Executive Vice President  
 jake.higgins@cbre.com  
 1 702 369 4844  
 NV LIC. #S.0176473

**CBRE**  
**Kelsey Higgins**  
 Senior Associate  
 kelsey.higgins@cbre.com  
 1 702 369 4812  
 NV LIC. #S.0192524

**Prologis**  
**Johana Gonzalez**  
 Leasing Associate  
 jgonzalez2@prologis.com  
 1 702 891 9510  
 NV LIC. #S.0202094



Unlock the full potential of your warehouse with one strategic, single-source partner.

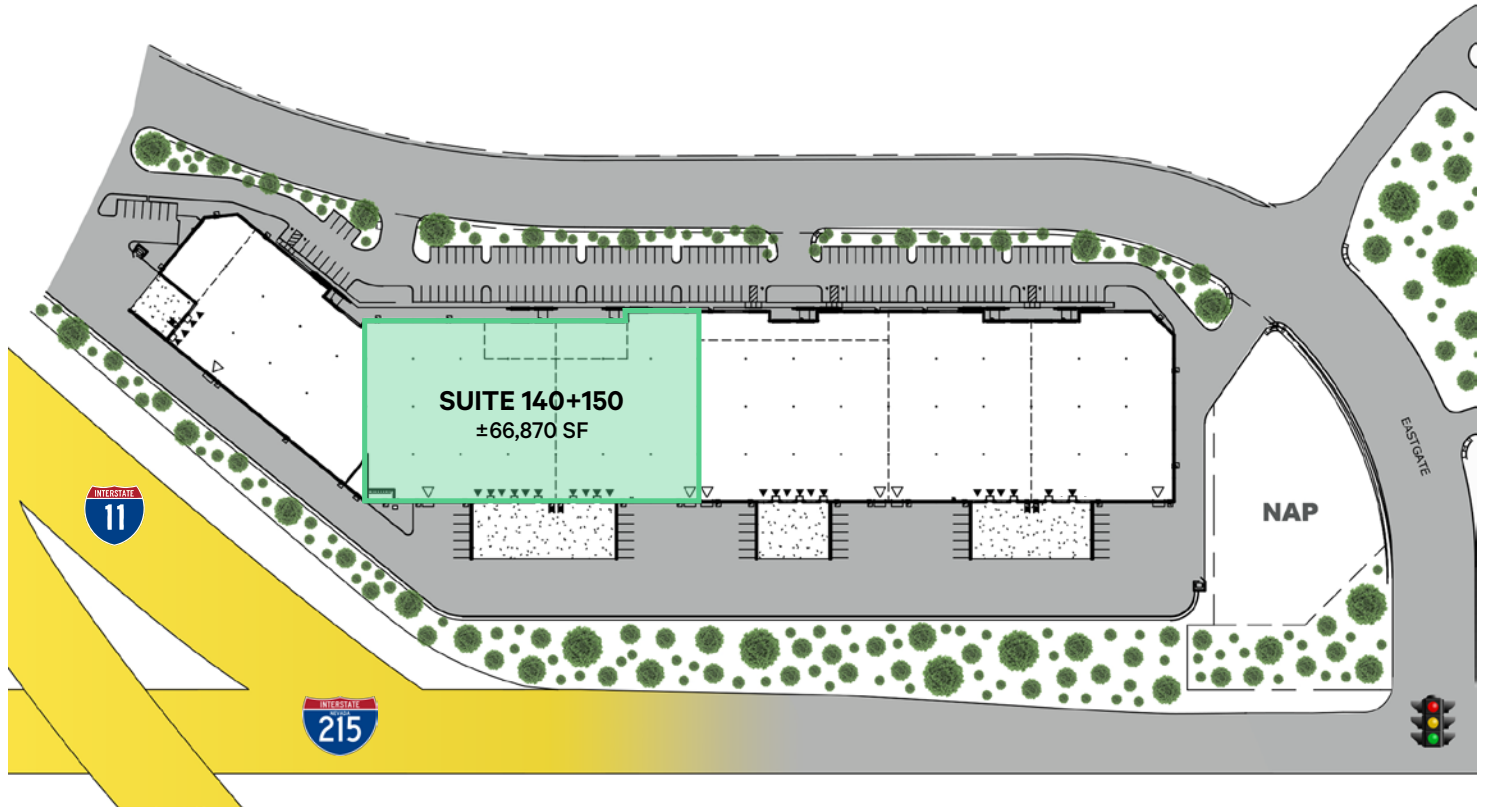

# CBRE

**CBRE**  
**Jake Higgins, SIOR**  
Executive Vice President  
jake.higgins@cbre.com  
1 702 369 4844  
NV LIC. #S.0176473

**CBRE**  
**Kelsey Higgins**  
Senior Associate  
kelsey.higgins@cbre.com  
1 702 369 4812  
NV LIC. #S.0192524

**Prologis**  
**Johana Gonzalez**  
Leasing Associate  
jgonzalez2@prologis.com  
1 702 891 9510  
NV LIC. #S.0202094