



# FOR LEASE

## BRIGHT CREATIVE OFFICE SPACE PARKER PLAZA ATRIUM OFFICE CENTER

### PROPERTY HIGHLIGHTS:

- Local, long-term ownership with flexible terms available
- Expansive ceiling heights with excellent natural light
- Operable windows and skylights plus HVAC
- Secured onsite parking
- Easy Walk to Berkeley Bowl, 900 Greyson, and just upstairs from Tarocco
- On-site security and property management
- Free shuttle to Ashby and MacArthur BART Stations

### LOCATION

2550-2560 Ninth St.  
Berkeley

### OFFERED AT

\$2.25 – \$2.95  
IG/psf /yr

### SIZE

<b>209 A</b>	± 680 sq. ft.	<b>213 A</b>	±1,667 sq. ft.
<b>208 B</b>	±767 sq. ft.	<b>220 B</b>	±1,889 sq ft
<b>317 A</b>	± 850 sq. ft.	<b>102</b>	±2,180 sq ft
<b>205</b>	±1,210 sq. ft.	<b>320</b>	±2,448 sq ft
<b>121</b>	±1,262 sq. ft.	<b>318</b>	±2,524 sq ft
<b>111</b>	±1,432 sq. ft.	<b>114</b>	±2,628 sq. ft.
<b>206</b>	±1,518 sq. ft.	<b>214</b>	±3,968 sq. ft.

**NORHEIM  
& YOST**

732 Addison Street  
Suite "C"  
Berkeley, CA 94710

Elena Holsman  
BRE# 01731812  
eh@noryost.com  
510-527-3400 x11

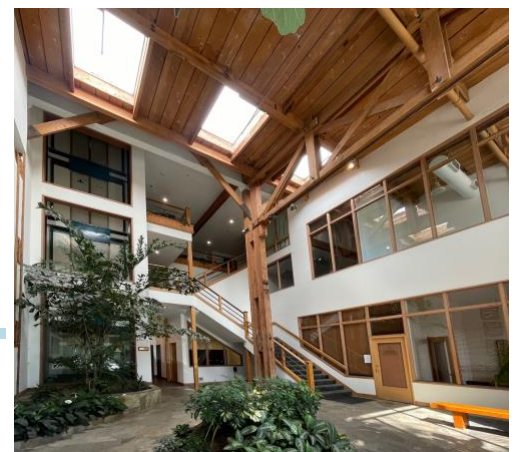

All information furnished herein was provided by sources deemed reliable, but no representation is made or implied as to the accuracy thereof.



