

698

AVAILABLE FOR LEASE

MISSION COURT  
FREMONT, CALIFORNIA



STEVE KAPP, SIOR | 510-543-7822 | [steve.kapp@nrmk.com](mailto:steve.kapp@nrmk.com) | CA RE Lic. #01069911

MATTHEW JEW, | 925-890-0341 | [matthew.jew@nrmk.com](mailto:matthew.jew@nrmk.com) | CA RE Lic. #02213814

NEWMARK

# PROPERTY HIGHLIGHTS

- ◆ High visibility corner location
- ◆ ±54,892 SF total
- ◆ Additional Features
  - ◆ 2,000 amp 480V power service
  - ◆ 1 Dock / 1 Grade
  - ◆ 4/1,000 parking
- ◆ 1st Floor - 27,446 SF
  - ◆ Open shell warehouse
  - ◆ Lobby
  - ◆ Restroom core
- ◆ 2nd Floor - 27,446 SF
  - ◆ Fully built out office area
  - ◆ Conference rooms
  - ◆ Server room
  - ◆ Large break area
  - ◆ 14 private offices
  - ◆ 60 workstations



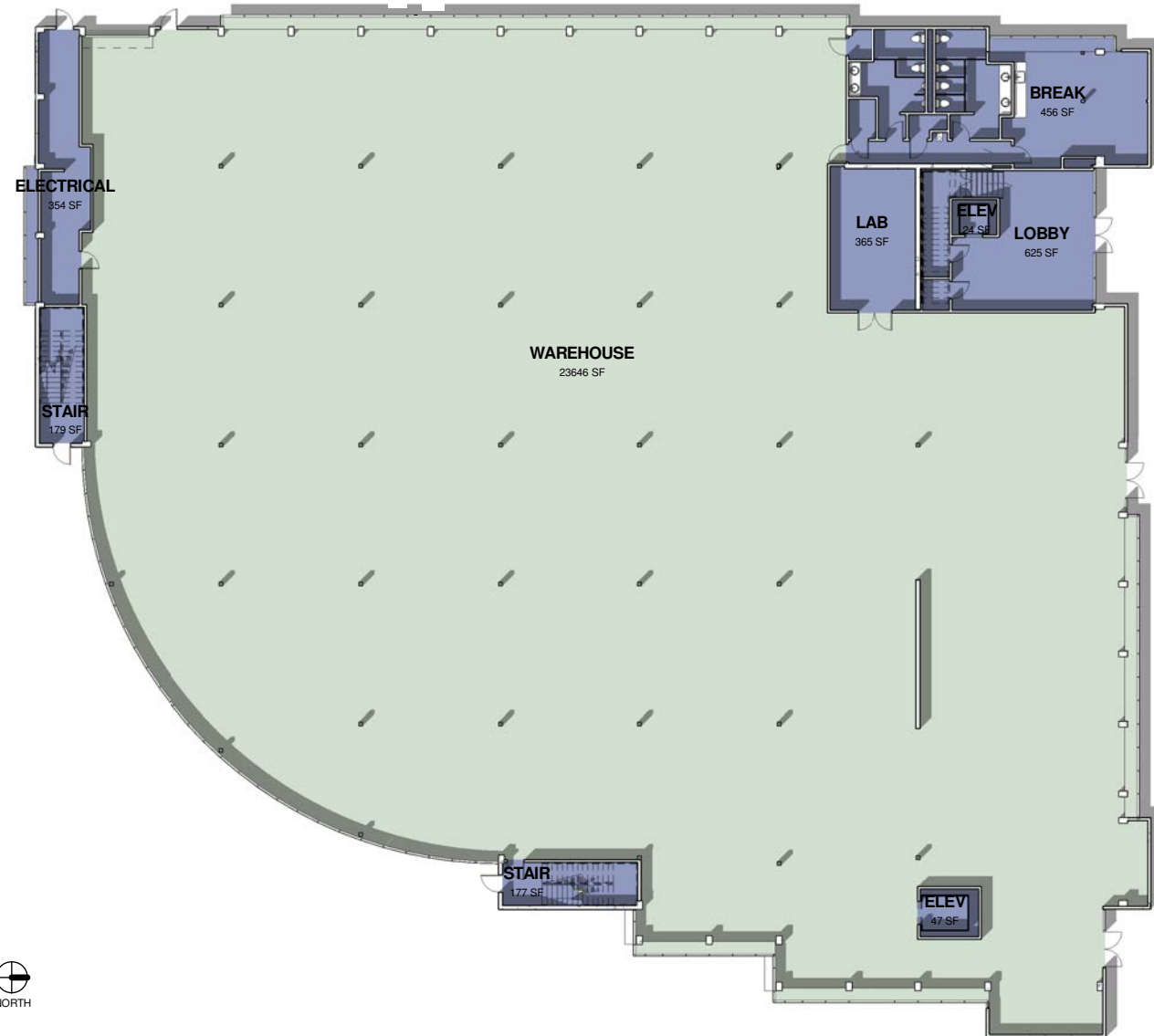

LEGEND

- HARDWALL AREA
- OPEN AREA



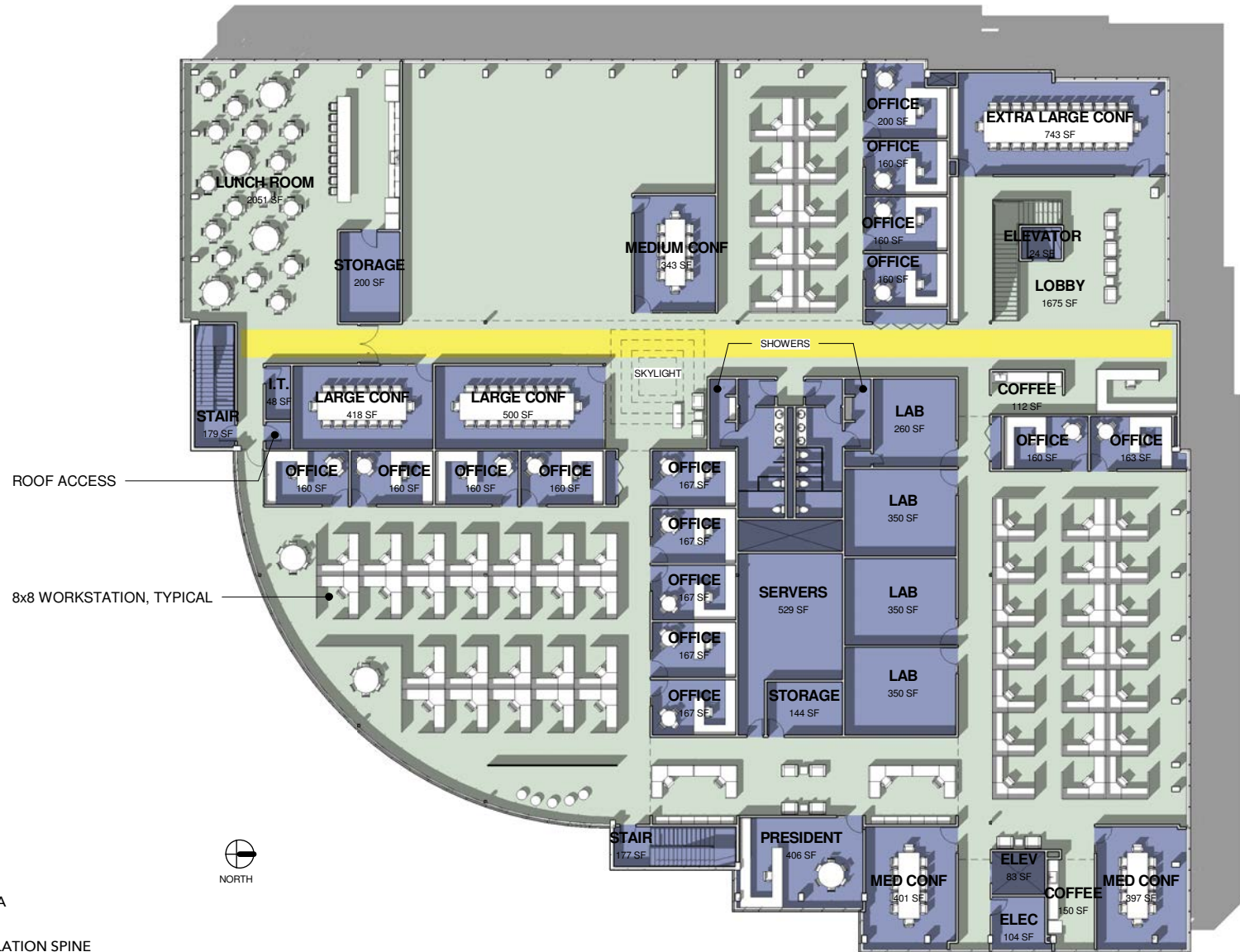

# CORPORATE NEIGHBORS

AUTO MALL

amazon

Western Digital

BART  
ba



TESLA

ThermoFisher  
SCIENTIFIC

668  
MISSION COURT

WARM SPRINGS

MISSION COURT

FM INDUSTRIES, INC.

WARREN AVE

WARREN AVE

# LOCATION MAP

668



668

MISSION COURT

FREMONT, CALIFORNIA



STEVE KAPP, SIOR | 510-543-7822 | [steve.kapp@nrmk.com](mailto:steve.kapp@nrmk.com) | CA RE Lic. #01069911

MATTHEW JEW, | 925-890-0341 | [matthew.jew@nrmk.com](mailto:matthew.jew@nrmk.com) | CA RE Lic. #02213814

**NEWMARK**

The distributor of this communication is performing acts for which a real estate license is required. The information contained herein has been obtained from sources deemed reliable but has not been verified and no guarantee, warranty or representation, either express or implied, is made with respect to such information. Terms of sale or lease and availability are subject to change or withdrawal without notice. 23-0290.05/23