

LOCATION

1700 SOUTH

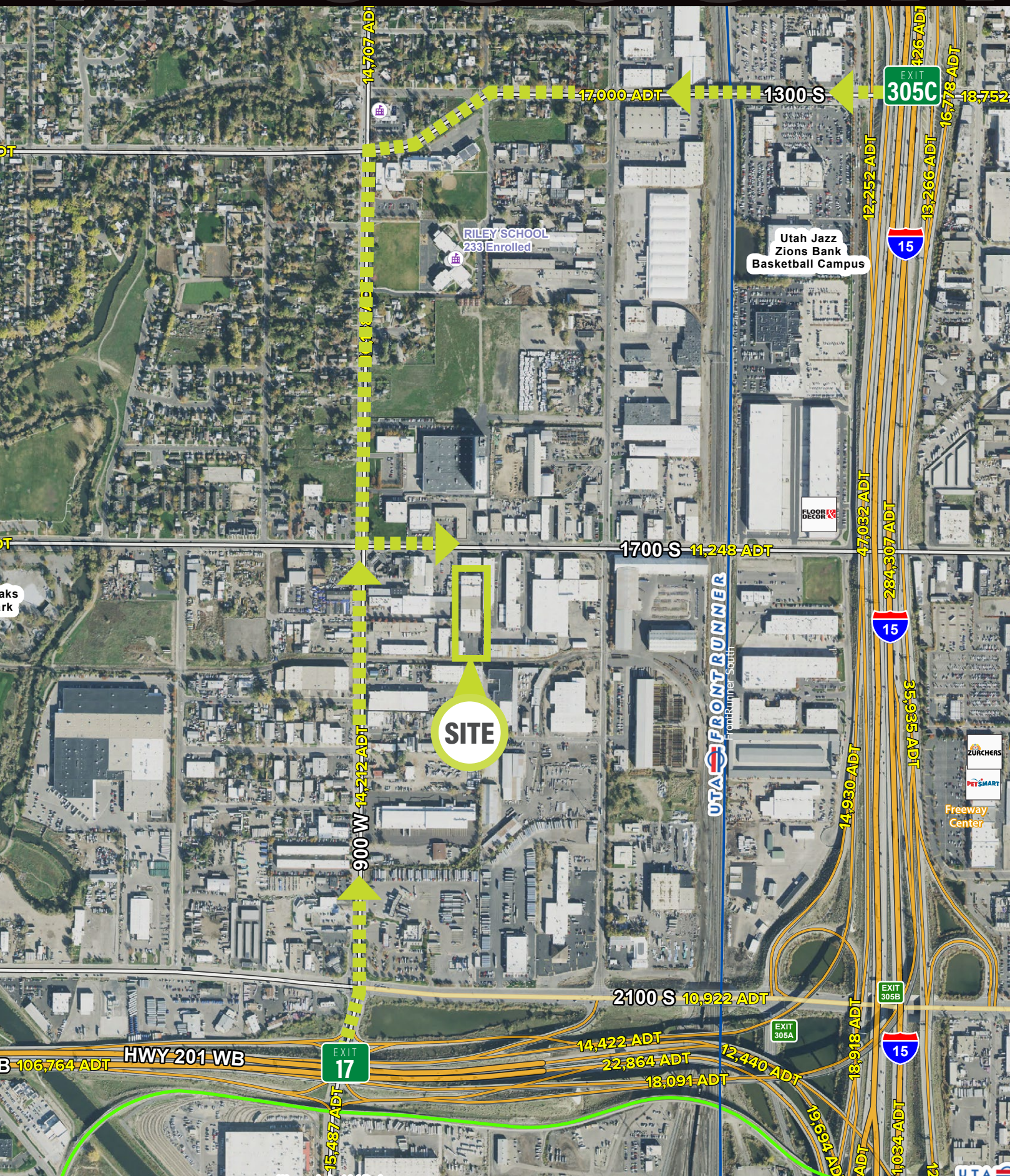

FORMER EAGLE ROCK SUPPLY

815 West 1700 South | Salt Lake City, UT 84104



FOR LEASE
\$0.65 PSF NNN

HIGHLIGHTS

- Total SF: 16,740 SF
- Divisible: 7,812-16,740 SF
- Two (2) 10'x10' docks with outdoor pad
- One (1) 12'x14' grade level door
- Gas forced heaters throughout
- Clear height: 14'-18'
- Zoning: M-1 (Manufacturing)
- Access: easy access from 2100 South exit on I-15 and I-80
- Location: Located in the highly desirable Salt Lake City submarket

SKYLER PETERSON, SIOR

801.656.7354 | speterson@legendcommercial.com

TRE BOURDEAUX, SIOR

801.824.0397 | tbourdeaux@legendcommercial.com

PARKER TAGGART

801.928.1815 | ptaggart@legendcommercial.com

LEGEND
PARTNERS

801.930.6750 | www.legendllp.com
2180 S 1300 E, Suite 240 | Salt Lake City, UT 84106

1700 SOUTH

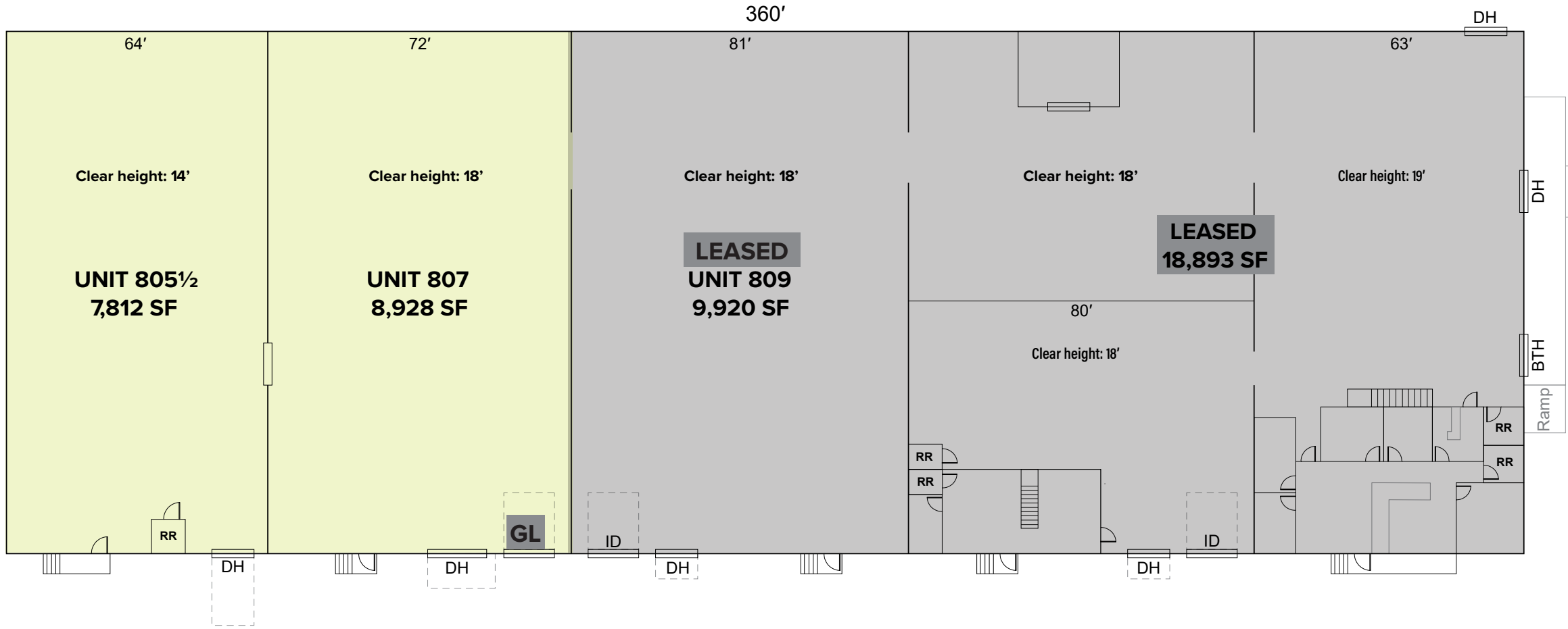

BUILDING 1

- TOTAL SF: 16,740 SF
- DIVISIBLE: 7,812-16,740 SF
- TWO (2) 10'X10' DOCK HIGH DOORS WITH EXTERIOR PAD
- ONE (1) 12'X14' GRADE LEVEL DOOR
- CLEAR HEIGHT: 14'-18'

UNIT	SIZE (SF)
805 1/2	7,812
807	8,928

KEY

- GL - Grade Level Door
- DH - Dock High Door
- BTH - Box Truck Height
- ID - Interior Dock
- RR - Restroom

