

# 0.15 Acres • Guilds Lake Submarket Land

Southwest Corner of NW 22nd Ave and NW Wilson Street • Portland, Oregon

## Price Reduced



## A Rare Paved & Fenced Parking Lot For Sale in Northwest Portland

### Excellent access to Hwy 30 & I-405 at NW Vaughn

- An approximately 6,716 SF commercial lot
- Fully paved and fenced, with gate
- Zoned IG1, and currently used for parking
- Located less than one mile from Montgomery Park
- One block from the Hwy 30 / I-405 Fremont Bridge on- and off-ramps at NW Vaughn and NW 23rd
- Traffic counts\*:
  - Northbound Hwy 30: 84,397 vehicles daily
  - Southbound Hwy 30: 44,745 vehicles daily
  - NW Vaughn St Exit: 14,351 vehicles daily

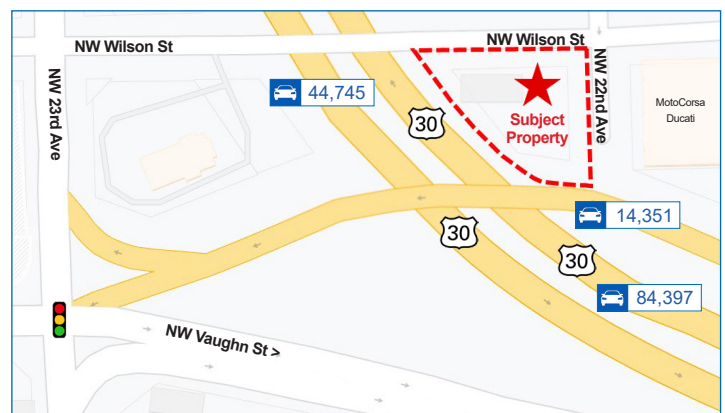

\*MPSI Daily Estimate, 2022 | US Hwy 30 Northbound / Southbound & US Hwy 30 at NW Vaughn Exit

**NOW OFFERED AT \$575,000**

# NEWMARK

For additional information, please contact:

**JACK WARD**

Associate

503.972.5509 • jack.ward@nrmk.com

Licensed Oregon & Washington Real Estate Broker

[www.nrmk.com](http://www.nrmk.com)

Procuring broker shall only be entitled to a commission, calculated in accordance with the rates approved by our principal only if such procuring broker executes a brokerage agreement acceptable to us and our principal and the conditions as set forth in the brokerage agreement are fully and unconditionally satisfied. Although all information furnished regarding property for sale, rental, or financing is from sources deemed reliable, such information has not been verified and no express representation is made nor is any to be implied as to the accuracy thereof and it is submitted subject to errors, omissions, change of price, rental or other conditions, prior sale, lease or financing, or withdrawal without notice and to any special conditions imposed by our principal.