



THALHIMER

RETAIL FOR LEASE
201 Twenty One

201 West 21st Street, Norfolk, VA

201 TWENTY ONE

1,290 SF ENDCAP AVAILABLE



For more information, contact:

ROB WRIGHT
Senior Vice President
757 499 2896
rob.wright@thalhimer.com

The Town Center of Virginia Beach
222 Central Park Ave., Suite 1500
Virginia Beach, VA 23462
www.thalhimer.com

Independently Owned and Operated / A Member of the Cushman & Wakefield Alliance

Cushman & Wakefield | Thalhimer © 2015. No warranty or representation, express or implied, is made to the accuracy or completeness of the information contained herein, and same is submitted subject to errors, omissions, change of price, rental or other conditions, withdrawal without notice, and to any special listing conditions imposed by the property owner(s). As applicable, we make no representation as to the condition of the property (or properties) in question.

Property Features

- Ground floor retail on 21st Street in Ghent
 - 1,172 SF retail location; 30' frontage
 - 1,290 SF endcap; 25' frontage
- On-site public parking
 - 42 covered parking spaces



Join Retailers:

KOSHI

FIVE GUYS
BURGERS and FRIES

Walgreens

ELITE
European Day Spa

sweetFrog
premium frozen yogurt



For more information, contact:

ROB WRIGHT
Senior Vice President
757 499 2896
rob.wright@thalhimer.com

The Town Center of Virginia Beach
222 Central Park Ave., Suite 1500
Virginia Beach, VA 23462
www.thalhimer.com

RETAIL FOR LEASE
201 Twenty One

201 West 21st Street, Norfolk, VA

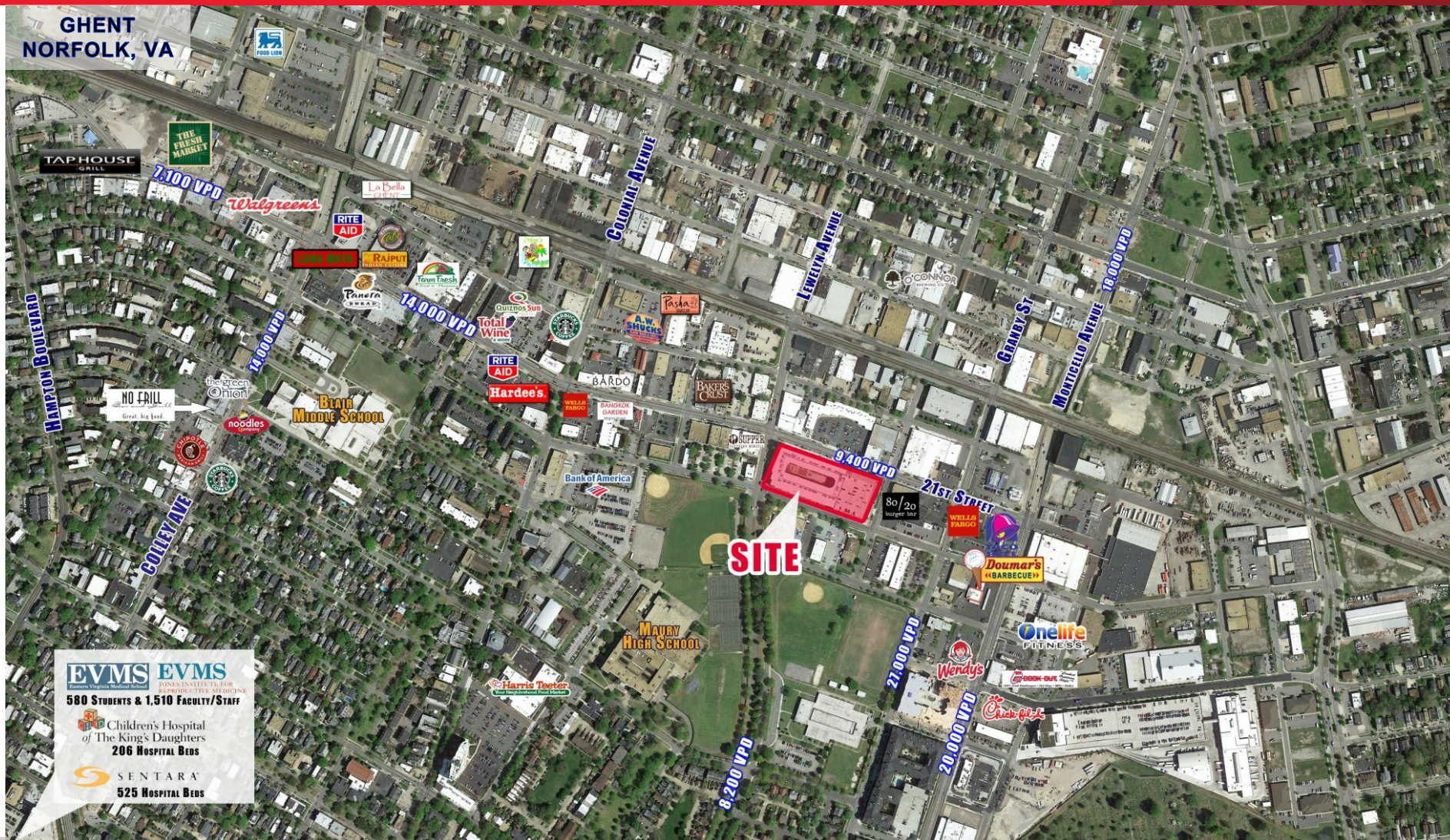

For more information, contact:

ROB WRIGHT
Senior Vice President
757 499 2896
rob.wright@thalhimer.com

The Town Center of Virginia Beach
222 Central Park Ave., Suite 1500
Virginia Beach, VA 23462
www.thalhimer.com

RETAIL FOR LEASE 201 Twenty One

201 West 21st Street, Norfolk, VA

Roseland Property Company, a premier development company with a highly acclaimed reputation for creating exceptional residential communities in some of the most desirable settings across the East Coast, now brings its expertise to the heart of Norfolk.

- Over 14,800 square feet of ground floor retail space situated beneath 225 urban loft-style apartment homes
- Offers a 421-space self-contained parking garage
- Norfolk's surrounding Ghent district is rich in history, arts, and education, with centuries-old homes neighboring The Chrysler Art Museum, Virginia Opera House, and the bustling campuses of Old Dominion University and Eastern Virginia Medical School

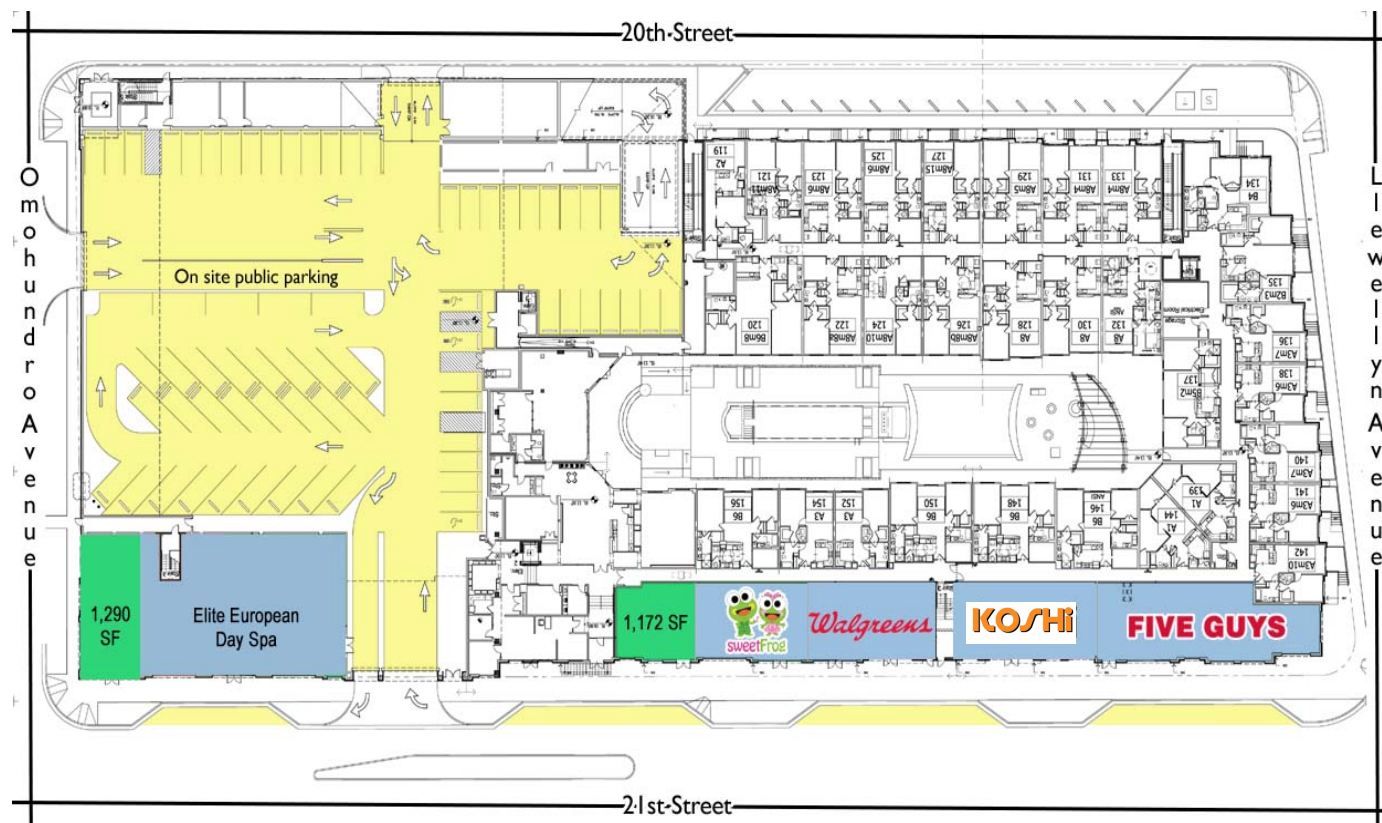

For more information, contact:

ROB WRIGHT
Senior Vice President
757 499 2896
rob.wright@thalhimer.com

The Town Center of Virginia Beach
222 Central Park Ave., Suite 1500
Virginia Beach, VA 23462
www.thalhimer.com