

Industrial | For Lease

STAG
INDUSTRIAL

CBRE

11320 Gateway Distribution Center

254,136 Sq. Ft. Facility

11320 Gateway Blvd. East
Socorro, Texas 79927
www.cbre.com/elpaso

Industrial Warehouse for Lease



11320 Gateway Distribution Center

11320 Gateway Blvd. East | Socorro, Texas 79927



Property Overview

The 11320 Gateway Distribution Center was recently built in 2023 and provides 254,136 square feet of contemporary Class A building space. It is conveniently located just 7.3 miles from the Ysleta-Zaragoza Port of Entry in the Vista del Sol East submarket and offers direct access to I-10 via Gateway East Blvd. With its strategic proximity to the port of entry and major interstates of I-10 and Loop 375, our facility serves as an optimal hub for your warehousing and distribution needs, providing efficient logistics solutions with near direct access to major highways and its neighboring Ysleta-Zaragoza International Port of Entry.

Site Plan

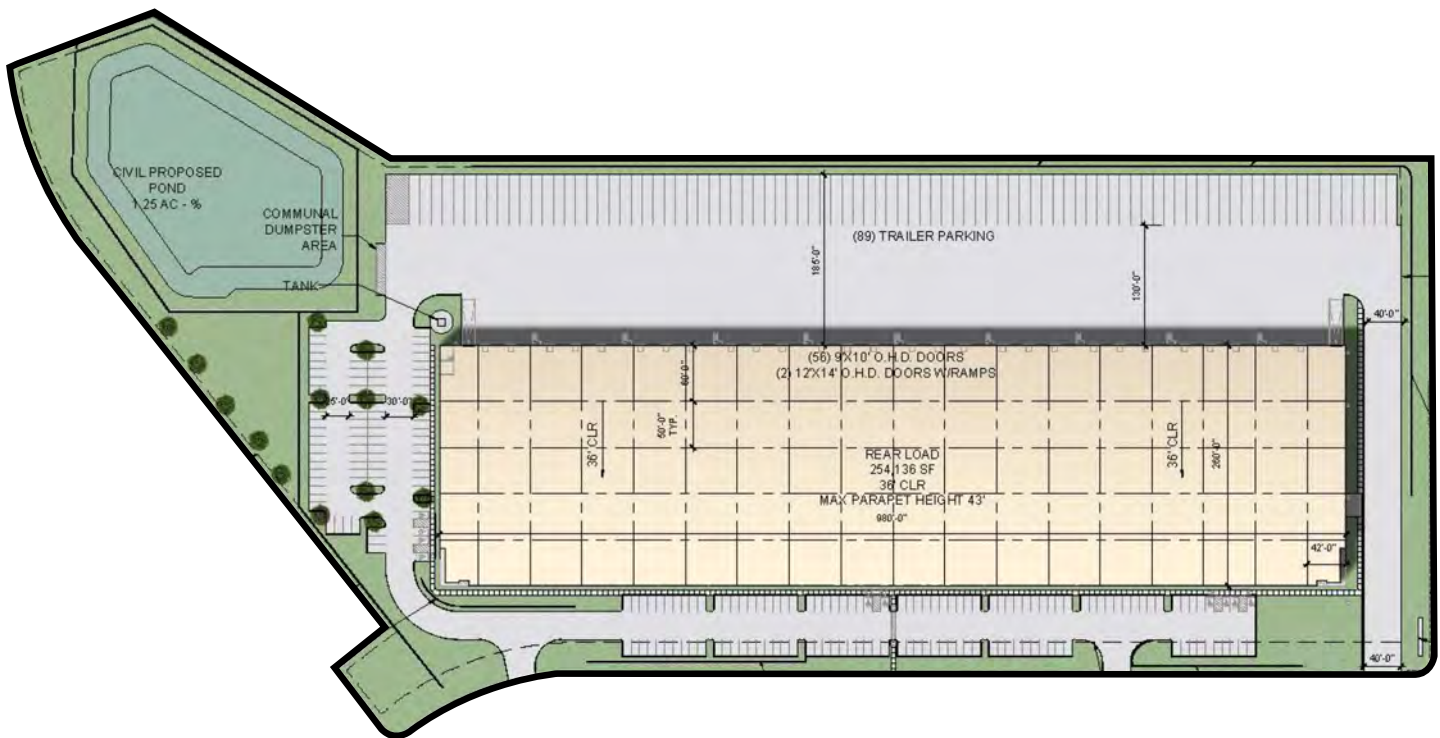

Property Features

- + Building Size: 254,136 SF
- + Lot Size: 18 Acres
- + Year Built: 2023
- + Zoning: IC-MUD
- + Dimensions: 260' Deep x 980' Wide
- + Column Spacing: 56' x 50'
- + Speed bay: 60'
- + Dock High Doors: 56 (9' x 10')
- + O.H.D. with Ramps: 2 (12'x14')
- + Lighting: High Bay LED
- + Ceiling Height: 36' Clear with "Clerestory" Windows
- + Roof: 60 MIL TPO single-ply white membrane
- + Sprinkler System: ESFR
- + Power: 2000 Amp Transformer (277/480/3 Phase)
- + Floor Slab: 6" Reinforced Concrete
- + Floor Seal: Diamond Hard
- + Heating: Freeze Protection Unit Heaters
- + Truck Court Depth: 185'

Floor Plan

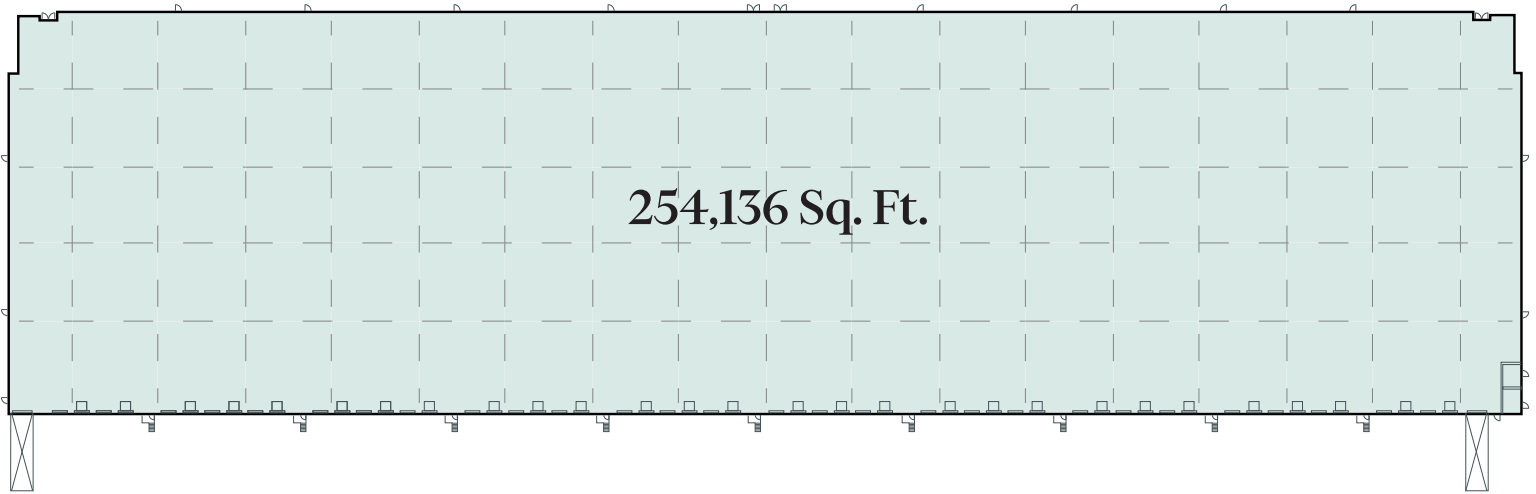



Contact Us

Jacob Quinn

Executive Vice President

D: +1 915.313.8815

C: +1 915.269.6786

jacob.quinn@cbre.com

André Rocha

Senior Vice President

D: +1 915 313 8816

C: +1 915 261 2915

andre.rocha@cbre.com

© 2026 CBRE, Inc. All rights reserved. This information has been obtained from sources believed reliable, but has not been verified for accuracy or completeness. You should conduct a careful, independent investigation of the property and verify all information. Any reliance on this information is solely at your own risk. CBRE and the CBRE logo are service marks of CBRE, Inc. All other marks displayed on this document are the property of their respective owners, and the use of such logos does not imply any affiliation with or endorsement of CBRE. Photos herein are the property of their respective owners. Use of these images without the express written consent of the owner is prohibited.



Information About Brokerage Services

Texas law requires all real estate license holders to give the following information about brokerage services to prospective buyers, tenants, sellers and landlords.

TYPES OF REAL ESTATE LICENSE HOLDERS:

- **A BROKER** is responsible for all brokerage activities, including acts performed by sales agents sponsored by the broker.
- **A SALES AGENT** must be sponsored by a broker and works with clients on behalf of the broker.

A BROKER'S MINIMUM DUTIES REQUIRED BY LAW (A client is the person or party that the broker represents):

- Put the interests of the client above all others, including the broker's own interests;
- Inform the client of any material information about the property or transaction received by the broker;
- Answer the client's questions and present any offer to or counter-offer from the client; and
- Treat all parties to a real estate transaction honestly and fairly.

A LICENSE HOLDER CAN REPRESENT A PARTY IN A REAL ESTATE TRANSACTION:

AS AGENT FOR OWNER (SELLER/LANDLORD): The broker becomes the property owner's agent through an agreement with the owner, usually in a written listing to sell or property management agreement. An owner's agent must perform the broker's minimum duties above and must inform the owner of any material information about the property or transaction known by the agent, including information disclosed to the agent or subagent by the buyer or buyer's agent.

AS AGENT FOR BUYER/TENANT: The broker becomes the buyer/tenant's agent by agreeing to represent the buyer, usually through a written representation agreement. A buyer's agent must perform the broker's minimum duties above and must inform the buyer of any material information about the property or transaction known by the agent, including information disclosed to the agent by the seller or seller's agent.

AS AGENT FOR BOTH - INTERMEDIARY: To act as an intermediary between the parties the broker must first obtain the written agreement of *each party* to the transaction. The written agreement must state who will pay the broker and, in conspicuous bold or underlined print, set forth the broker's obligations as an intermediary. A broker who acts as an intermediary:

- Must treat all parties to the transaction impartially and fairly;
- May, with the parties' written consent, appoint a different license holder associated with the broker to each party (owner and buyer) to communicate with, provide opinions and advice to, and carry out the instructions of each party to the transaction.
- Must not, unless specifically authorized in writing to do so by the party, disclose:
 - that the owner will accept a price less than the written asking price;
 - that the buyer/tenant will pay a price greater than the price submitted in a written offer; and
 - any confidential information or any other information that a party specifically instructs the broker in writing not to disclose, unless required to do so by law.

AS SUBAGENT: A license holder acts as a subagent when aiding a buyer in a transaction without an agreement to represent the buyer. A subagent can assist the buyer but does not represent the buyer and must place the interests of the owner first.

TO AVOID DISPUTES, ALL AGREEMENTS BETWEEN YOU AND A BROKER SHOULD BE IN WRITING AND CLEARLY ESTABLISH:

- The broker's duties and responsibilities to you, and your obligations under the representation agreement.
- Who will pay the broker for services provided to you, when payment will be made and how the payment will be calculated.

LICENSE HOLDER CONTACT INFORMATION: This notice is being provided for information purposes. It does not create an obligation for you to use the broker's services. Please acknowledge receipt of this notice below and retain a copy for your records.

CBRE, Inc.	299995	texaslicensing@cbre.com	210-225-1000
Licensed Broker /Broker Firm Name or Primary Assumed Business Name	License No.	Email	Phone
Jeremy McGown	620535	jeremy.mcgown@cbre.com	214-979-6100
Designated Broker of Firm	License No.	Email	Phone
Licensed Supervisor of Sales Agent/ Associate	License No.	Email	Phone
Sales Agent/Associate's Name	License No.	Email	Phone

Buyer/Tenant/Seller/Landlord Initials

Date