

S. Garnett Rd. Pad Site Available

1036 S. Garnett Rd.

www.walmancommercial.com

918-481-8888



- Approximately 2.68 acre site, with 165' of frontage on S. Garnett.
- High visibility to I-44
- Site can be split to meet your needs.
- Easy highway accessibility
- Over 70,000 people live within 3 miles of the site!
- Strong daytime population with multiple employers and schools nearby.



7060 S. Yale
Suite 900
Tulsa, OK 74136
Tel: 918.481.8888
Fax: 918.481.8866

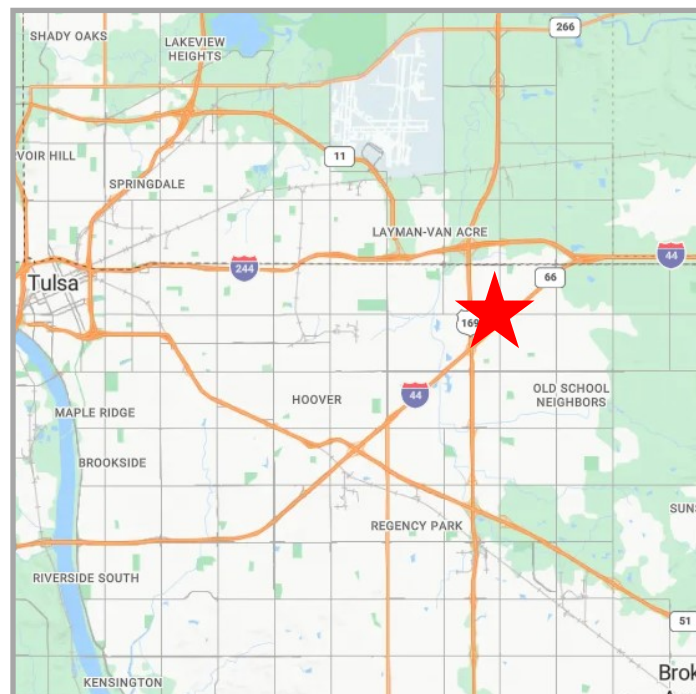

All statements herein are for informational purposes only and are believed to be reliable; however, no warranty or representation is made to the accuracy thereof and the same is submitted subject to errors, omissions, change of price, terms, conditions and prior sale or lease.

S. Garnett Rd. Pad Site Available

1036 S. Garnett Rd.

www.walmancommercial.com

918-481-8888



- Center turn lane along S. Garnett Rd., in front of property.
- Two existing pylon signs on property.
- Two ingress/egress points along S. Garnett Rd.
- Former hotel site with all utilities to site.

	<u>1 mile</u>	<u>3 miles</u>	<u>5 miles</u>
Population:	11,975	77,454	149,612
Households:	4,325	28,292	58,703
Avg. H.H. Income:	\$60,312	\$61,687	\$66,762
Traffic Counts:	S. Garnett Rd - 11,887 vpd		

All statements herein are for informational purposes only and are believed to be reliable; however, no warranty or representation is made to the accuracy thereof and the same is submitted subject to errors, omissions, change of price, terms, conditions and prior sale or lease.