

ORLO & ALBA AT GATEWAY CROSSING

1205 Coleman Avenue,
Santa Clara, CA



PROJECT HIGHLIGHTS

- New development with proven surrounding retail centers located in daytime-dense population area.
- Strong office population with roughly 2 million square feet in a one mile radius.
- Centrally located within the Silicon Valley.
- Easily accessible from Highway 880 and 82 (El Camino Real).
- Santa Clara Station (accessible from development) will be one of three points of connection for BART and CALTRAIN.

DEMOGRAPHICS

	1 MILE	3 MILES	5 MILES
Population	12,493	181,632	639,946
Avg. Household Income	\$178,789	\$197,524	\$205,851
Daytime Population	22,918	338,738	821,879

TRAFFIC COUNTS

Coleman Avenue	35,250 ADT
Benton Street	12,600 ADT
El Camino Real	19,800 ADT

Source: 2025 Esri.



CLOSE-UP AERIAL



PROPERTY SITE PLAN

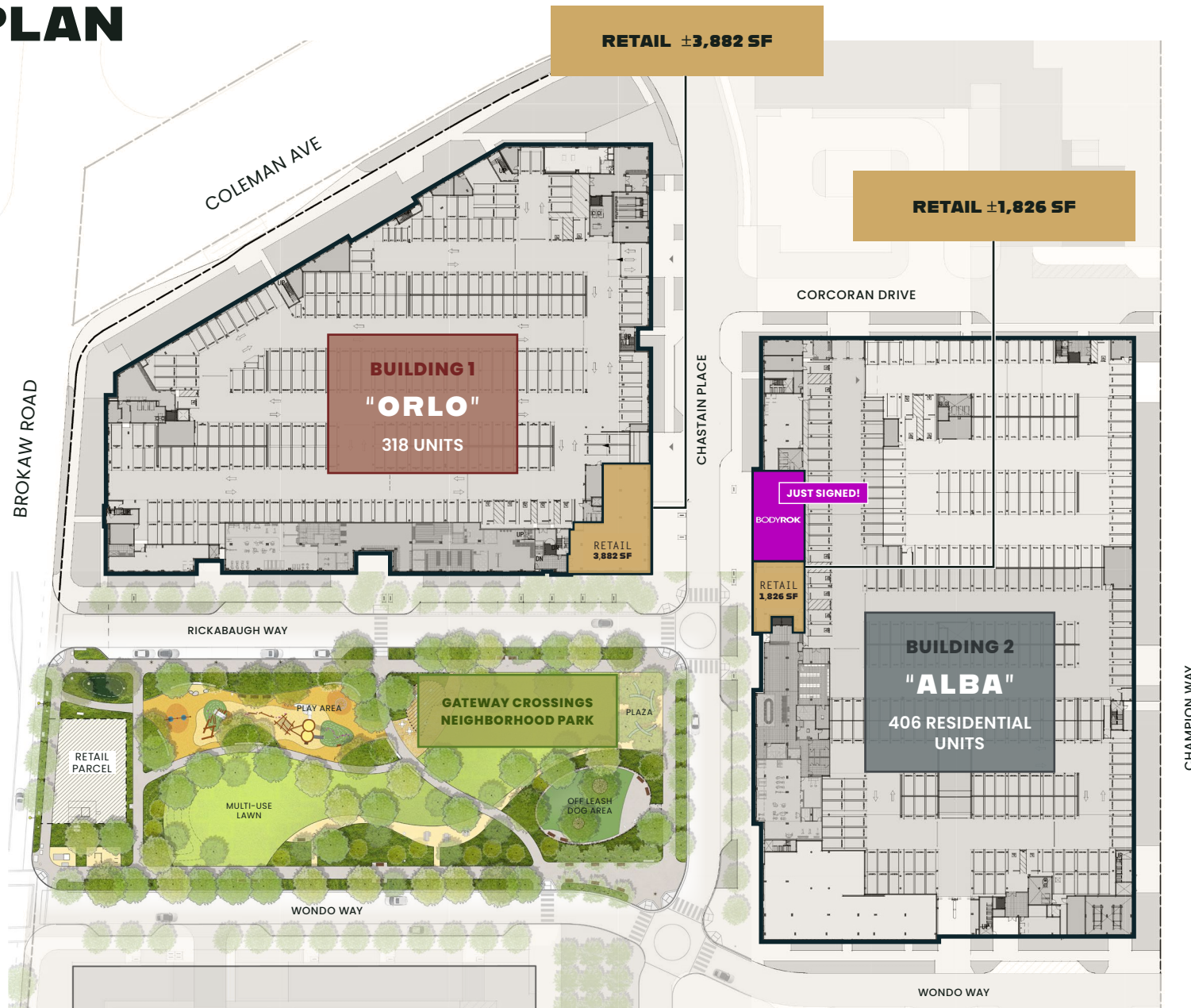

BLDG 2 RETAIL FLOOR PLAN

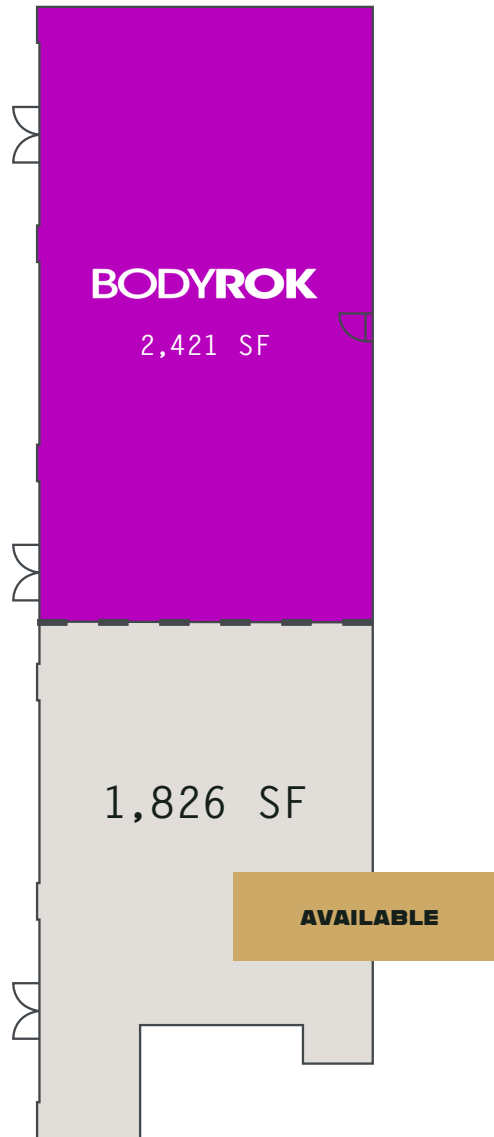

PROJECT GALLERY



GATEWAY CROSSINGS PHASE 2



HOTEL

225

ROOMS



BUILDING 3

324

RESIDENTIAL UNITS

15,000 SF

RETAIL



BUILDING 4

516

RESIDENTIAL UNITS

11,200 SF

RETAIL



PARK

3,500 SF

RETAIL/RESTAURANT
PAVILION





SANTA CLARA BART STATION



10,100 Weekday
riders in 2040



Walking distance
to **SANTA CLARA
UNIVERSITY**



500 PARKING SPACES
for BART passengers



Close to **PAYPAL
PARK**, home of the
San Jose Earthquakes



Connect to the
**SJ INTERNATIONAL
AIRPORT** via VTA'S
Route 60



CONTACT

JAMES CHUNG

jchung@theeoniccompany.com
(408) 400-7017
CaIDRE: 01408190

SHELBY SWANSON

sswanson@theeoniccompany.com
(408) 400-3879
CaIDRE: 02075363

MARISA DELGADO

mdelgado@theeoniccompany.com
(408) 400-7014
CaIDRE: 01917354

© 2025 the eonic company. No warranty or representation, express or implied, is made to the accuracy or completeness of the information contained herein, and same is submitted subject to errors, omissions, change of price, rental or other conditions, withdrawal without notice, and to any special listing conditions imposed by the property owner(s). As applicable, we make no representation as to the condition of the property (or properties) in question.

