

12,800 SF INDUSTRIAL FLEX ON .60 AC

FOR SUBLEASE

1405 S. PLATTE RIVER DR. DENVER, CO 80223

FOR SUBLEASE



LEASE RATE \$10.75 SF/YR NNN

PROPERTY HIGHLIGHTS

- 12,800 +/- SF Industrial Flex on .60 +/- AC
- For sublease through 12/2027
- Includes showroom/front counter area
- (2) Offices
- Kitchen/breakroom
- New HVAC system installed
- Building has been recently repainted and parking lot redone
- Zoned: I-A
- Built in 1979
- Parcel ID: 05211-17-009-000
- Ideally located directly off I-25 in the heart of Denver



Tom Bradley
Managing Broker
303.880.0108
tom.bradley@erescompanies.com



12,800 SF INDUSTRIAL FLEX ON .60 AC

FOR SUBLEASE

1405 S. PLATTE RIVER DR. DENVER, CO 80223

FOR SUBLEASE

AERIAL



Map
data
©2022

Tom Bradley
Managing Broker
303.880.0108
tom.bradley@erescompanies.com



12,800 SF INDUSTRIAL FLEX ON .60 AC

FOR SUBLEASE

1405 S. PLATTE RIVER DR. DENVER, CO 80223

FOR SUBLEASE

EXTERIOR PHOTOS



Tom Bradley
Managing Broker
303.880.0108
tom.bradley@erescompanies.com



12,800 SF INDUSTRIAL FLEX ON .60 AC

FOR SUBLEASE

1405 S. PLATTE RIVER DR. DENVER, CO 80223

FOR SUBLEASE

INTERIOR PHOTOS



Tom Bradley
Managing Broker
303.880.0108
tom.bradley@erescompanies.com



12,800 SF INDUSTRIAL FLEX ON .60 AC

FOR SUBLEASE

1405 S. PLATTE RIVER DR. DENVER, CO 80223

FOR LEASE

INTERIOR PHOTOS



Tom Bradley
Managing Broker
303.880.0108
tom.bradley@erescompanies.com



12,800 SF INDUSTRIAL FLEX ON .60 AC

FOR SUBLEASE

1405 S. PLATTE RIVER DR. DENVER, CO 80223

FOR SUBLEASE

FLOOR PLAN

Site Specific Floor Plan

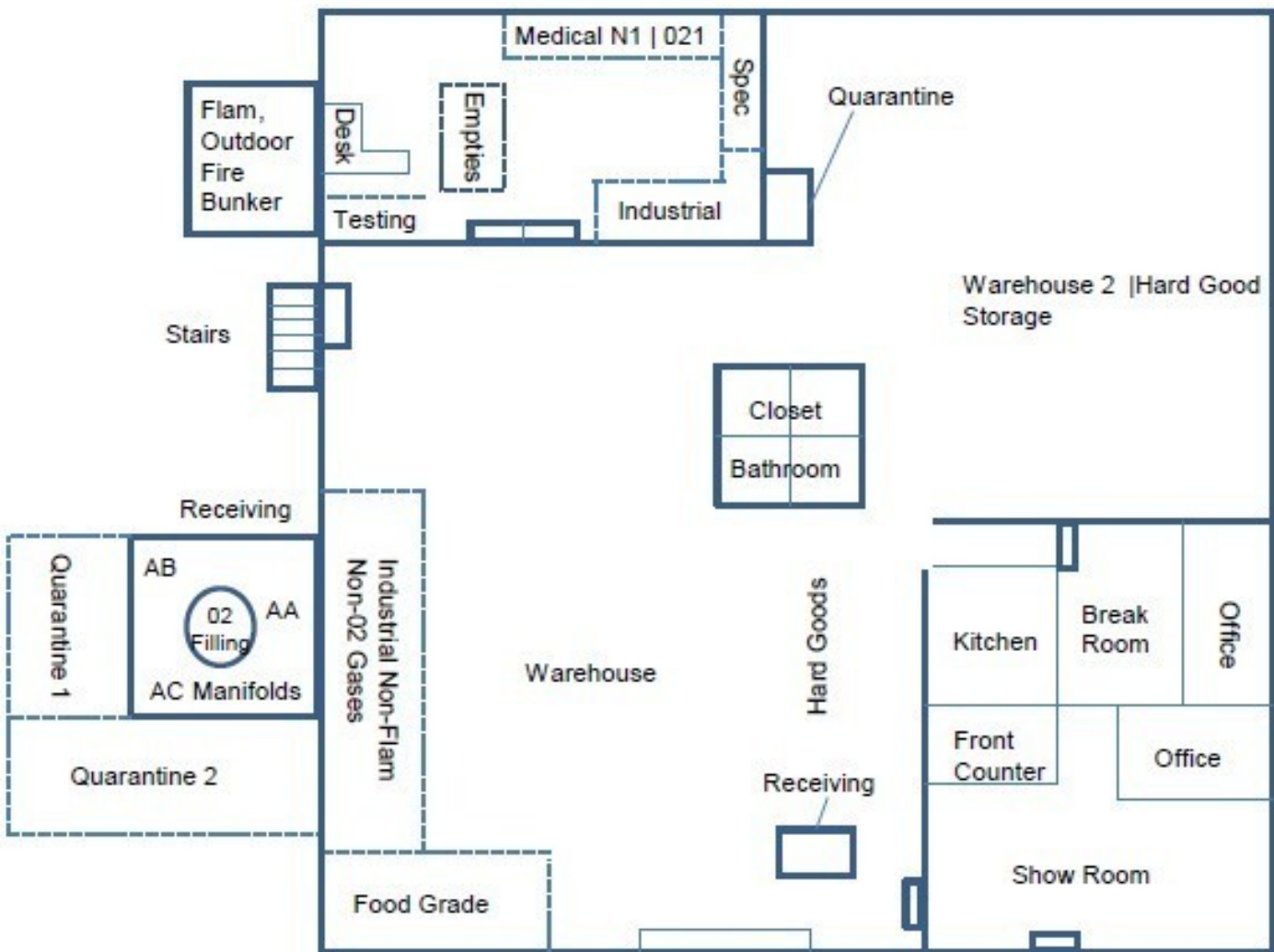

Tom Bradley
Managing Broker
303.880.0108
tom.bradley@erescompanies.com

