

RETAIL PROJECT INFORMATION

SITE: 3.15 ACRES (137,200 SQ.FT.)

BUILDING SIZE AND TYPE:

20,000 SQ.FT. GROCERY
 9,300 SQ.FT. RETAIL
 2,000 SQ.FT. RESTAURANT (52 SEATS)

31,300 SQ.FT. TOTAL

NOTE: PAYSON CITY RESTAURANT PARKING IS BASED ON 1 STALL PER 4 SEATS (WITH 6 EXTRA DRIVE-THRU STACKING SPACES IF THE RESTAURANT HAS A DRIVE-THRU). SEATING SPACE CALCULATIONS WILL BE ACCURATELY MADE WHEN ALL ELEMENTS OF THE BUILDING ARE DESIGNED BASED ON TENANT REQUIREMENTS. THE 68 SEATS SHOWN IS BASED ON THE AVAILABLE 17 STALLS CURRENTLY SHOWN. THE FINAL DESIGN MIGHT NOT HAVE A DRIVE-THRU (WHICH WOULD ADD STALLS)

PARKING:

1 PER 200 SQ.FT. = 100 STALLS
 1 PER 300 SQ.FT. = 31 STALLS
 1 PER 4 SEATS = 13 STALLS

TOTAL REQUIRED = 144 STALLS

PROVIDED = 144 STALLS
 +12 STACKING FOR (2) DRIVE THRU WINDOWS

SHARED PARKING

144 TOTAL STALLS ON SITE

DURING BUSINESS HOURS, EMPLOYEES AND CUSTOMERS WILL USE ALL 144 STALLS.

OUTSIDE OF BUSINESS HOURS, NEIGHBORING RESIDENTIAL LOTS (LOT 5 AND LOT 6) WILL USE THE 144 STALLS .

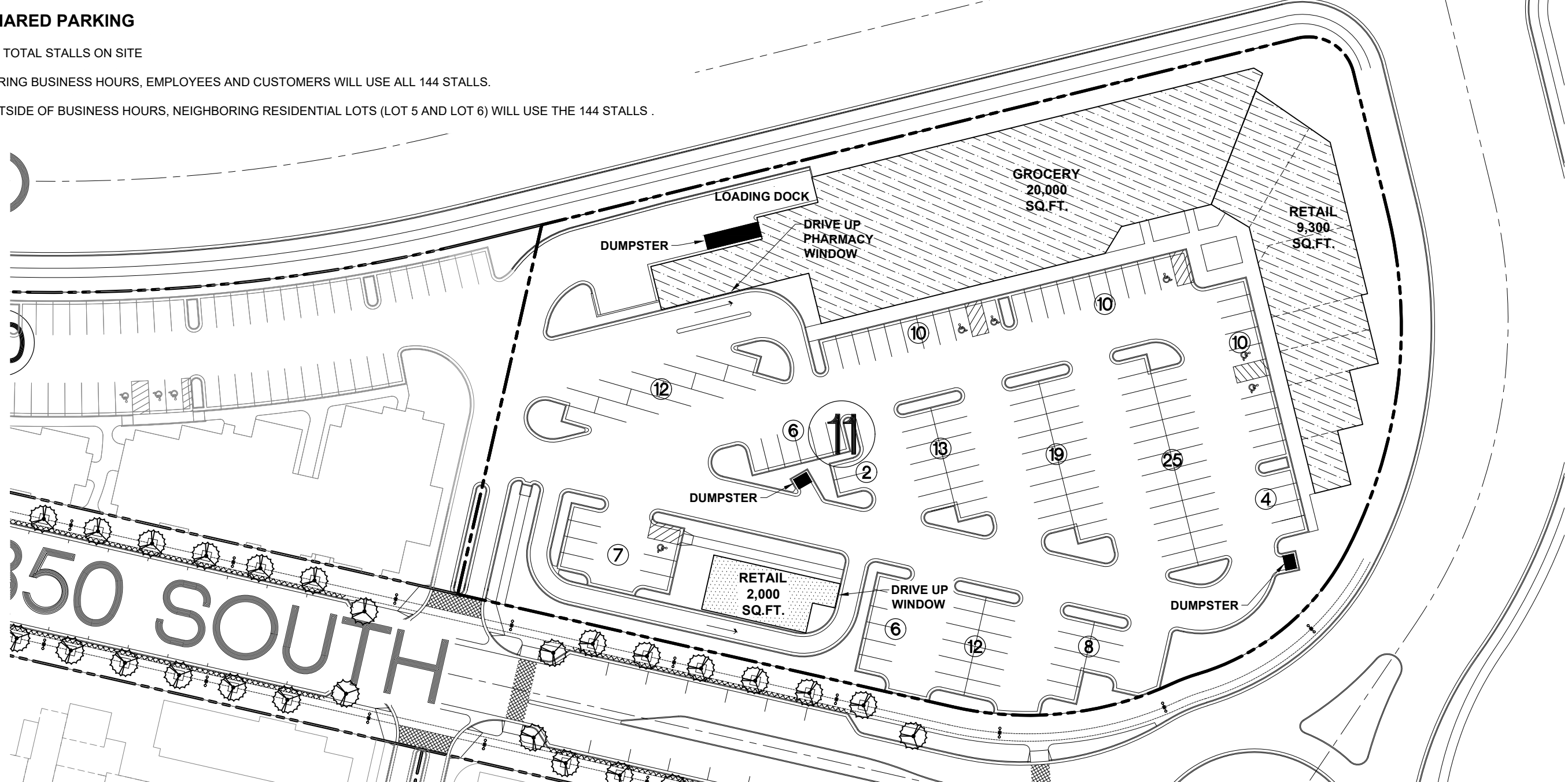
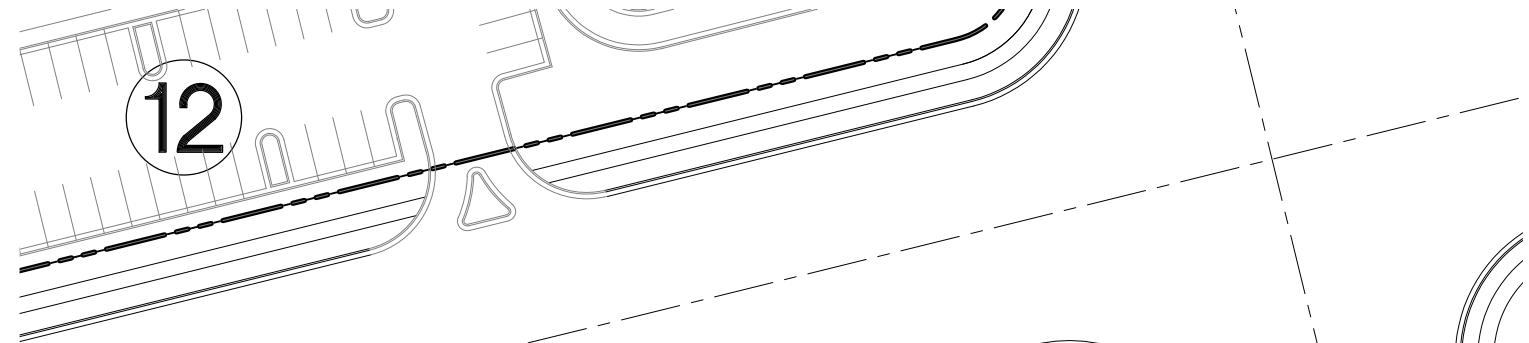

Red Bridge Lot 11

1" = 30'-0"
 (1" = 60'-0" ON 11x17 PAPER)

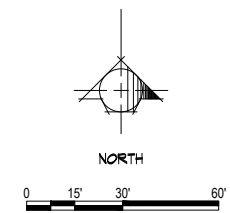

JWRA Architects
 2299 S. Highland Dr., Ste. 200
 Salt Lake City, UT 84106
 Phone: (801) 486-7777
 www.jwraia.com

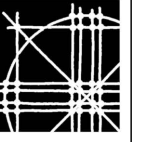

COPYRIGHT 2021
 JWRA ARCHITECTS
 ALL RIGHTS RESERVED
 ALL DESIGN, DRAWING AND WRITTEN MATERIAL APPEARING HEREIN CONSTITUTE THE ORIGINAL & UNPUBLISHED WORK OF JWRA ARCHITECTS AND MAY NOT BE DUPLICATED, USED OR DISCLOSED WITHOUT THE WRITTEN CONSENT OF JWRA ARCHITECTS.

RED BRIDGE STATION AREA

Payson, Utah

Job #	
Dr. By	TJK
Ch. By	
Rev. By	
Revisions	
Date:	PRELIMINARY

Sheet:
LOT 11
 of