

SUITE
FOR LEASE

Lake Copeland Medical Center
1111 South Orange Ave. Orlando, FL 32806



First Year
Free!

LEASE PRICE
CALL FOR DETAILS

Available Suite with Stunning City/Lake Views!

Property Details

Condition:	Dark Grey Shell
Available Space:	±3,712 SF
Lot Size:	30,492
Zoning:	MU-2/T
Building Class:	B
Parking:	20 Covered + 5/1,000 Extra
Signage:	Available on Orange Ave.

Property Highlights

- 20 covered parking spaces available
- 5/1000 additional parking
- Customizable space

The Lake Copeland Medical Center is located in the heart of Downtown Orlando's Medical Campus directly across from the Orlando Health Complex (ORMC) which is home to the University of Florida Cancer Center, Winnie and Arnold Palmer Medical buildings, Orlando Health Heart Institute, and in walking distance to the Sunrail Station.

Sitting at the signaled intersection of Orange Avenue and Columbia Street, tenants and their patients have easy access entering and leaving the property making it ideal for patient drop-off and pick-up.

The suite is located on the third floor, is approximately 3,712 SF and features its own private entrance, stunning 360-view of Lake Copeland, ORMC, Downtown Orlando, SODO, and comes with covered parking.

The space is currently in Grey Shell Condition and ready for your customization. Space is also be ideal for a tech/creative firm.

PRESENTED BY

Nicholas Fouraker CCIM
NICK@4ACRE.COM | 407.601.1466

Colin Chou
COLIN@4ACRE.COM | 850.218.1902

CALL
FOR MORE
INFORMATION

3rd Floor Proposed



VIEWS

Balcony

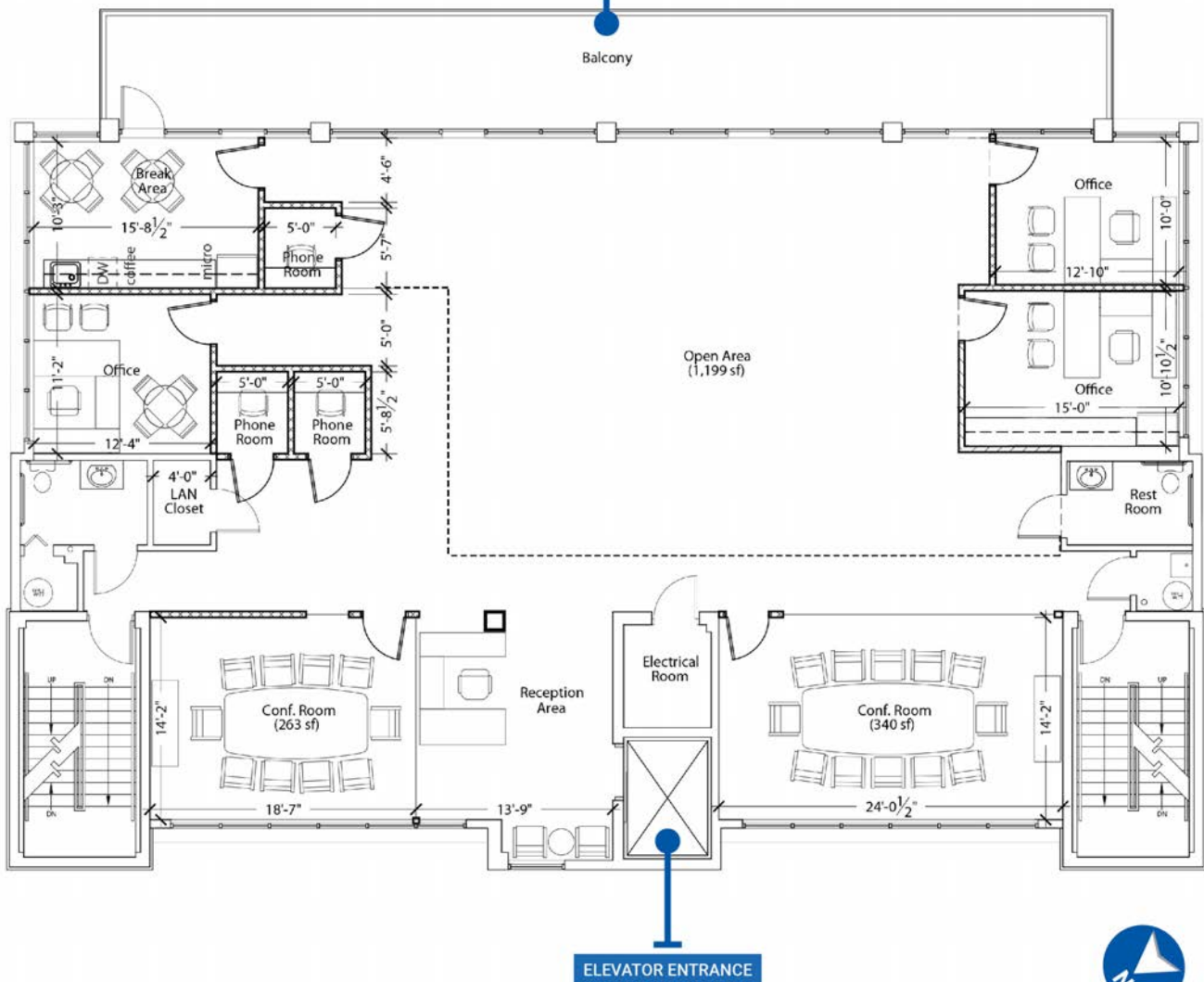

ELEVATOR ENTRANCE



PRESENTED BY

Nicholas Fouraker CCIM

NICK@4ACRE.COM | 407.601.1466

Colin Chou

COLIN@4ACRE.COM | 850.218.1902

CALL
FOR MORE
INFORMATION

AERIAL
MAP

Lake Copeland Medical Center

1111 South Orange Ave. Orlando, FL 32806



Office



PRESENTED BY

Nicholas Fouraker CCIM

NICK@4ACRE.COM | 407.601.1466

Colin Chou

COLIN@4ACRE.COM | 850.218.1902

CALL
FOR MORE
INFORMATION

Proximity to Medical Facilities



PRESENTED BY

Nicholas Fouraker CCIM

NICK@4ACRE.COM | 407.601.1466

Colin Chou

COLIN@4ACRE.COM | 850.218.1902

CALL
FOR MORE
INFORMATION