Trust CRE

It's in the name



+/- 1.67 ac For Sale on FM 3083

FM 3083 & Wedgewood Falls Drive, Conroe, TX 77304

Details

Property Type	Land
Subtype	Commercial
Zoning	C3- Commercial (in City/Under 5.00 Acres)
Land Acres	1.67
Lot Size (sq ft)	72,745
County	Montgomery County
Asking Price	Negotiable

Description

+/- 1.67 acres of prime commercial land located in high growth Lake Conroe area. Fronts the Wedgwood Falls subdivision. This 200-home neighborhood has an average value of \$311,000 based on sales in 2024. Perfect location for a retail center, industrial building, or Brownstone office buildings.

The 2011 TXDOT daily traffic count was estimated at 14,100 cars per day, and that was before the neighborhood was completed. There has been a lot of growth in the area in the last thirteen years! The population of Conroe is now over 96,000, having grown 62.5% since 2013. The 2027 forecast is a population of 110,000 inside the city limits.

Median household income in the city has also skyrocketed, growing to \$70,688, a 102% increase since 2000.

Due to the growth, TXDOT has started a \$26.3M road widening project on FM 3083. \$2.2M has been spent so far, and utilities along the road were being marked in August 2024, so construction should start soon. The subject property has +/- 340 feet of road frontage.

Preliminary plans for developing the site allow for an 8,000 SF building. See the following graphic.

The owner is open to sell, build to suit, or ground lease the property.

Highlights

- +/- 1.67 acres
- +/- 340 feet of frontage on FM 3083
- Existing shared drive with neighboring retail center

10-Minute Drive-Time

- Median HHI: \$53,240
- Population: 28,012
- Median age is 30.5
- 58% have some college or higher

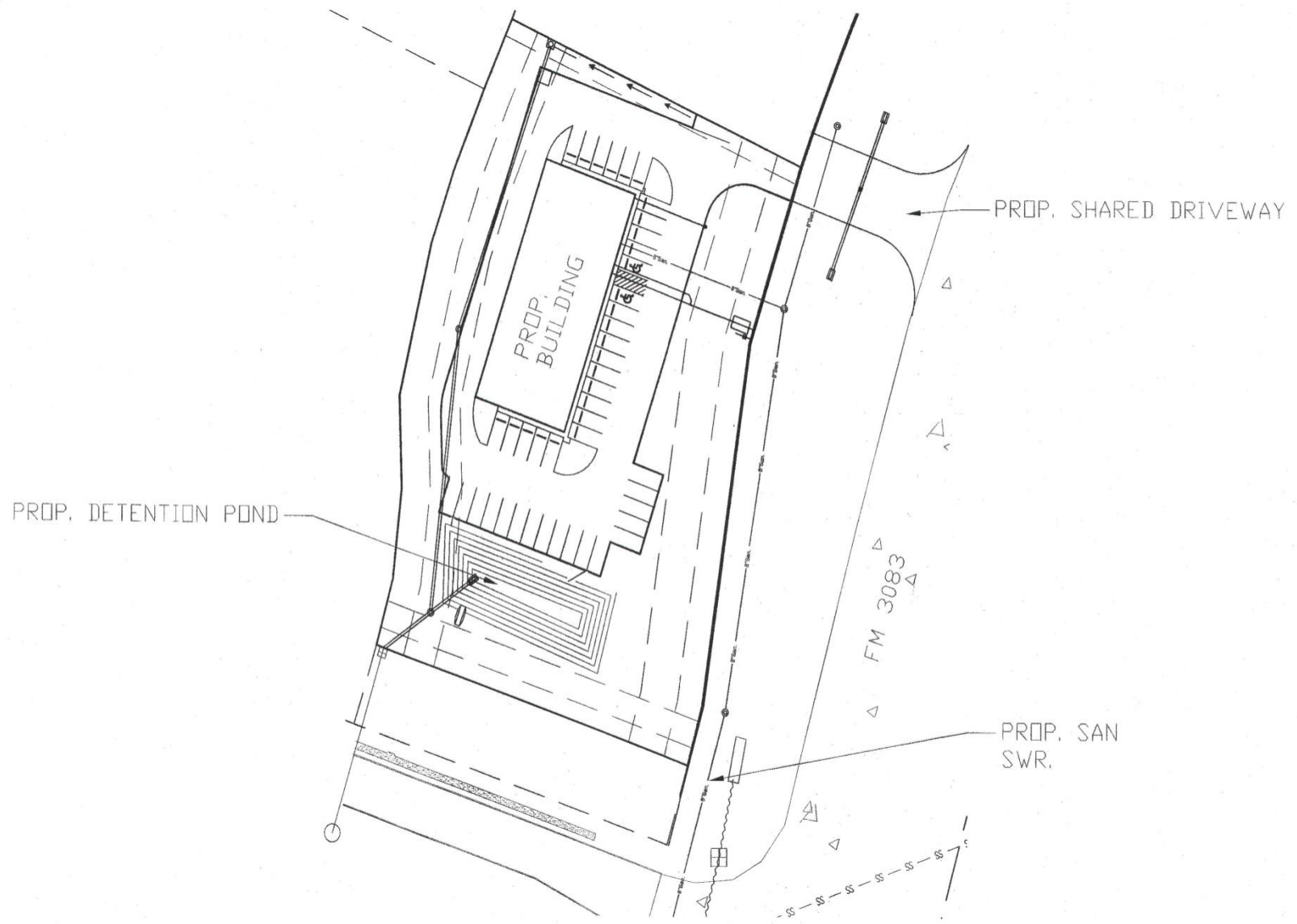

Demographic Report

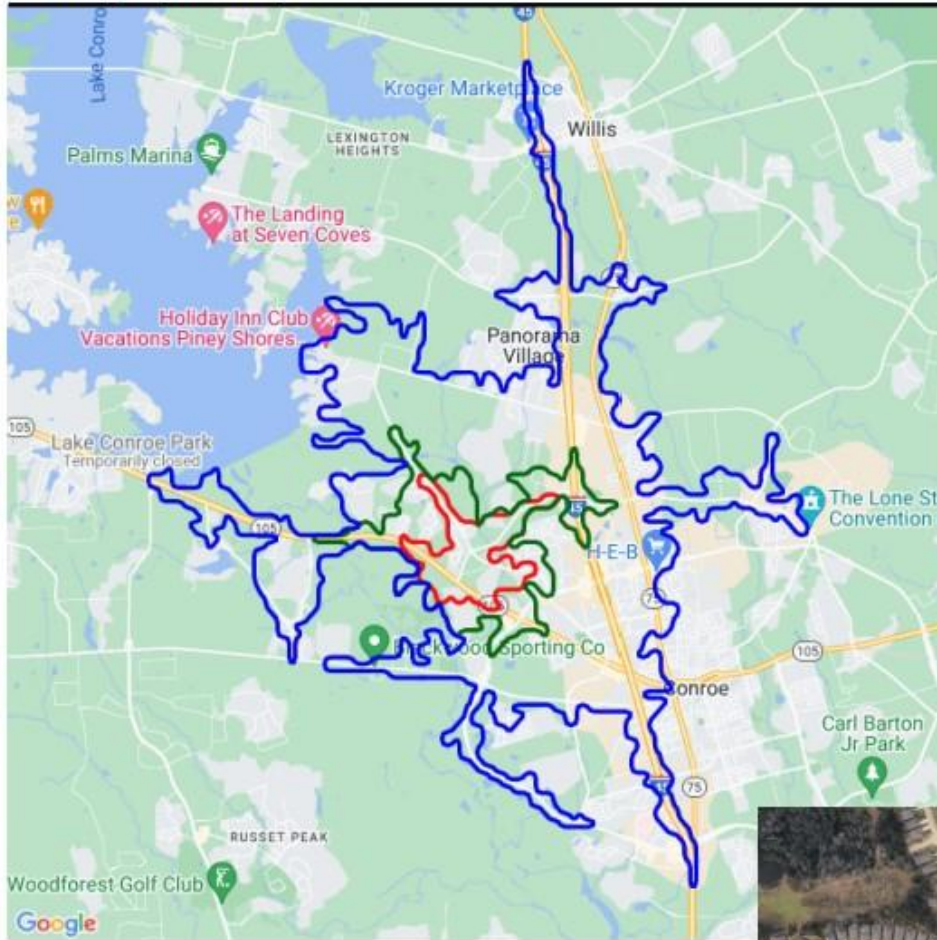

2065 N FM 3083 Road W

Population

Distance	Male	Female	Total
3- Minute	596	577	1,173
5- Minute	1,978	1,956	3,934
10 Minute	13,814	14,197	28,012



Location Facts & Demographics

Demographics are determined by a **10 minute drive** from 2065 N FM 3083 Road W, Conroe, TX 77304

CITY, STATE

Conroe, TX

POPULATION

28,012

AVG. HHSIZE

2.68

MEDIAN HH INCOME

\$53,240

HOME OWNERSHIP

Renters: **5,428**

Owners: **6,060**

EMPLOYMENT

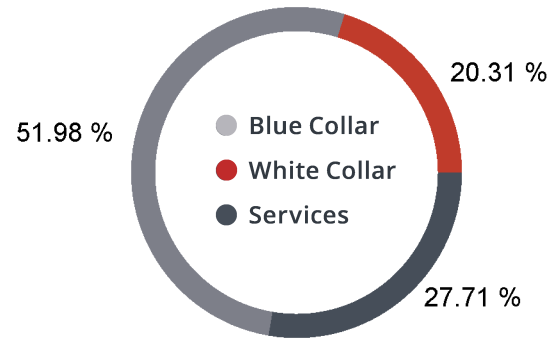

46.95 % Employed
1.33 % Unemployed

EDUCATION

High School Grad: **27.78 %**
Some College: **26.57 %**
Associates: **5.33 %**
Bachelors: **26.11 %**

GENDER & AGE

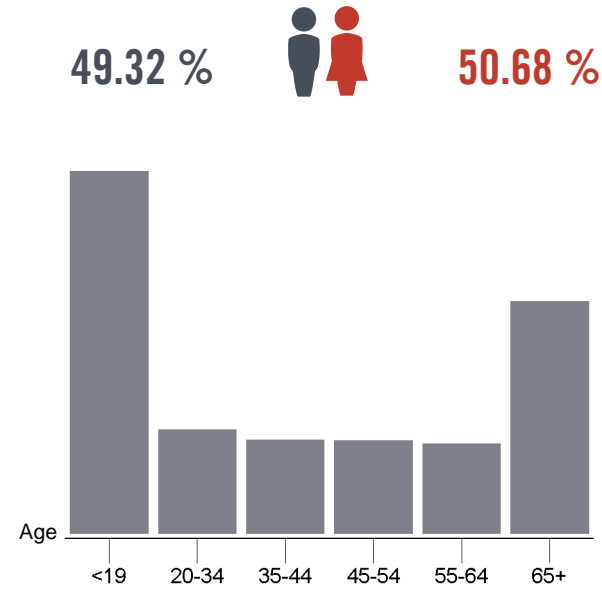

RACE & ETHNICITY

White: **71.33 %**
Asian: **1.88 %**
Native American: **0.22 %**
Pacific Islanders: **0.03 %**
African-American: **6.16 %**
Hispanic: **14.57 %**
Two or More Races: **5.81 %**

INCOME BY HOUSEHOLD

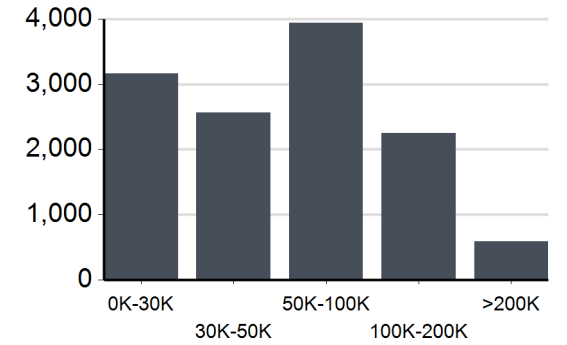

HH SPENDING

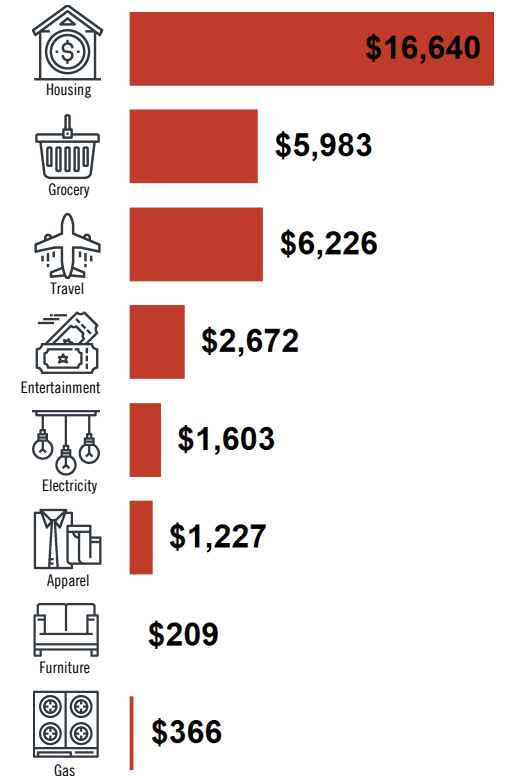

Advisor Biography

Jeff Williams is founder of Trust Commercial Real Estate, LLC., a real estate brokerage dedicated to helping clients achieve their financial goals through real estate. Whether the client is a small business looking to lease their first commercial space, or an owner in need strategic analysis of their portfolio in these challenging times, Jeff has the skills and experience to guide them to successful outcomes.

Before setting out to conquer the world of commercial real estate, Jeff spent 20 years in IT, first in technical roles, then as a project manager, leading projects to on-time, on-budget delivery worldwide. One of the highlights of his career was working for Ross Perot, Sr. where Jeff learned the value of sincerely investing in people and building relationships based on trust and hard work towards a common goal.

Walking a fine line between being entrepreneurial and being crazy, Jeff has launched other business with his wife and adult children. And though real estate can sometimes be a 24/7/365 engagement, in his down time Jeff can be found traveling with his wife Stephany or playing guitar.



Jeff Williams
Broker | Owner



281-898-1486



TrustCRE@outlook.com

Disclaimer

The information and graphics contained in the following marketing materials (the “Marketing Package”) is proprietary and strictly confidential. The Marketing Package shall only be reviewed by the party receiving it from Trust Commercial Real Estate, LLC, a Texas limited liability company (“Trust CRE”) and should not be made available to any other person or entity without the prior written consent of Trust CRE. Do not disseminate, distribute, or copy this email if you are not the named recipient and please notify the sender immediately if you have received this email by mistake while promptly deleting this email for confidentiality purposes. Trust CRE accepts no liability for any damages caused by transmission of any email, attachments, or this Marketing Package.

Trust CRE is not affiliated with, sponsored by, or endorsed by any commercial tenant or lessee identified in this Marketing Package. The presence of any company’s logo or name is included solely for the purpose of providing tenant lessee information about this listing to prospective customers. The presence of any company’s logo or name is not intended to indicate or establish affiliation with, or sponsorship or endorsement by, the commercial tenant or lessee identified in this Marketing Package, their affiliates, or subsidiaries.

This Marketing Package has been prepared to provide summary, unverified information for prospective purchasers, and to establish a preliminary level of interest in the subject property. The information contained herein is not a substitute for a thorough investigation and due diligence. Trust CRE makes no warranty or representation, express or implied, regarding the accuracy or completeness of the information contained herein, including but not limited to, the income or expenses for the subject property, the projected financial performance of the property, the size, square footage or metes and bounds of the property and any improvements, the presence or absence of toxic, hazardous or contaminating substances, including but not limited to, PCB’s or asbestos, compliance with state and federal regulations, the physical condition of any improvements thereon, the financial condition or business prospects of any tenant occupying any property, and the intentions of any tenant to continue its occupancy of the subject property. All tenant information must be verified separately by potential buyers. Additionally, Trust CRE cannot verify or guarantee marketable title or available insurance coverages for any subject property contained herein. The information contained in this Marketing Package has been obtained from reliable sources, but Trust CRE has not verified, and will not guarantee, any of the information contained herein. Trust CRE has not conducted any investigation regarding these matters and Trust CRE makes no warranty or representation whatsoever regarding the accuracy or completeness of the information contained herein. All potential buyers must independently verify all information contained herein.