

FOR LEASE

4,500 SF FLEX UNIT



2231 TECHNICAL PKWY SUITES E, F, & G,
NORTH CHARLESTON, SC 29406

Harbor
COMMERCIAL PARTNERS

2231 Technical Pkwy, North Charleston, SC 29406

PROPERTY DESCRIPTION

4,500 SF climate - controlled flex space available for lease in North Charleston. The property is located within the Wildwood Business Park, with quick access to I-26 via the Aviation Avenue exit. The property offers an attractive professional appearance with nicely finished office space, two restrooms, one 10x10 drive in door and three phase power.

OFFERING

SIZE	LEASE RATE	NNN RATE
4,500 SF	\$19.00 PSF NNN	Est. \$2.50 PSF



PROPERTY SPECS

AVAILABLE SF	4,500 SF
OFFICE SF	450 SF
WAREHOUSE SF	4,050 SF
TAX ID/APN	475-03-00-002
ZONING	M1 - Light Industrial
COUNTY	Charleston
DRIVE IN DOORS	(1) 10' x 10'
POWER	Three Phase
AIR CONDITIONING	100%
HEATING	100%
CLEAR HEIGHT	11'
CENTER HEIGHT	12'
EAVE HEIGHT	11'
LIGHTING TYPE	LED
YEAR BUILT	1987
SEWER	Public
WATER	Public
PARKING	10+



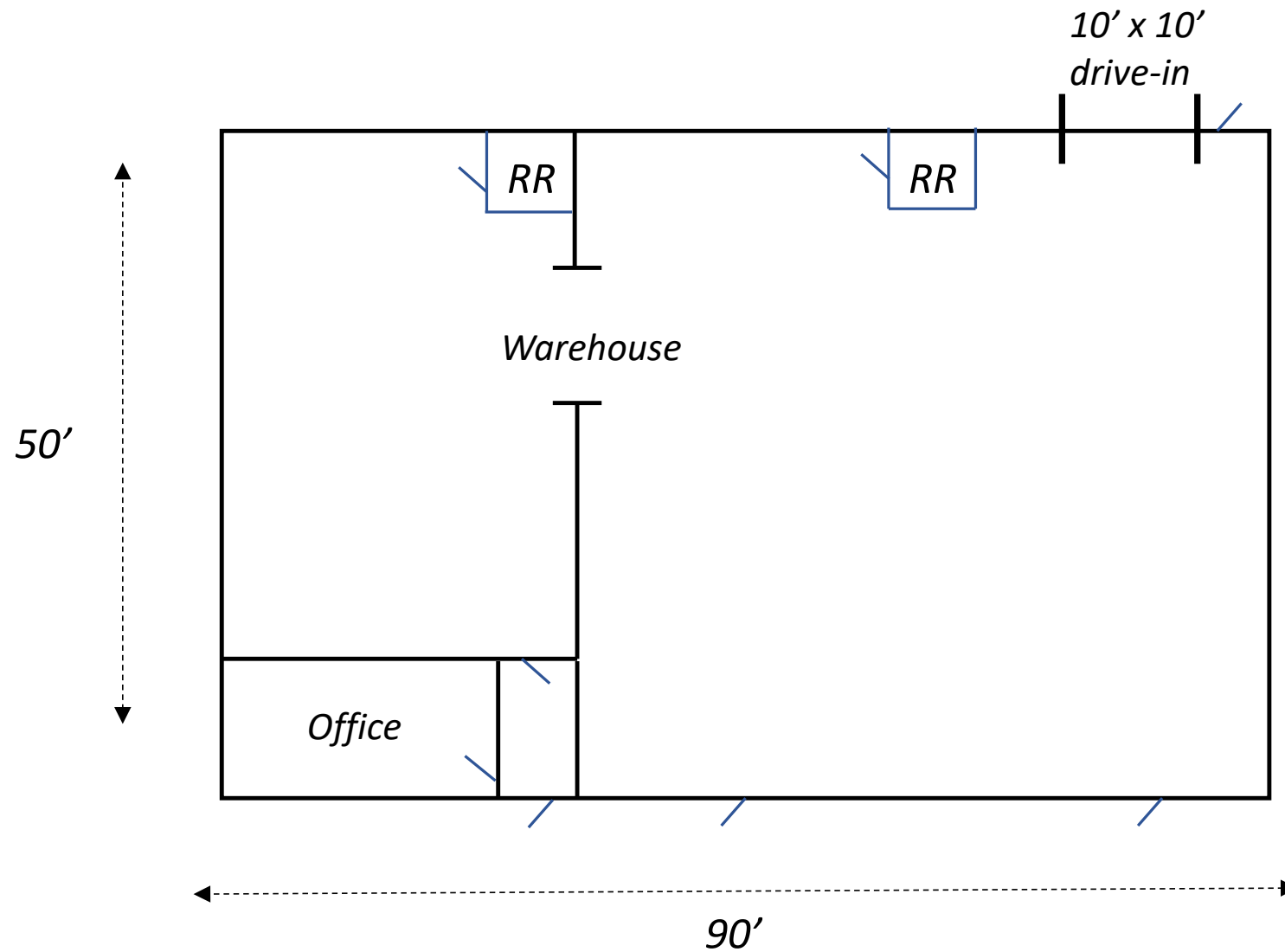

LOCATION MAP

2231 Technical Pkwy, North Charleston, SC 29406

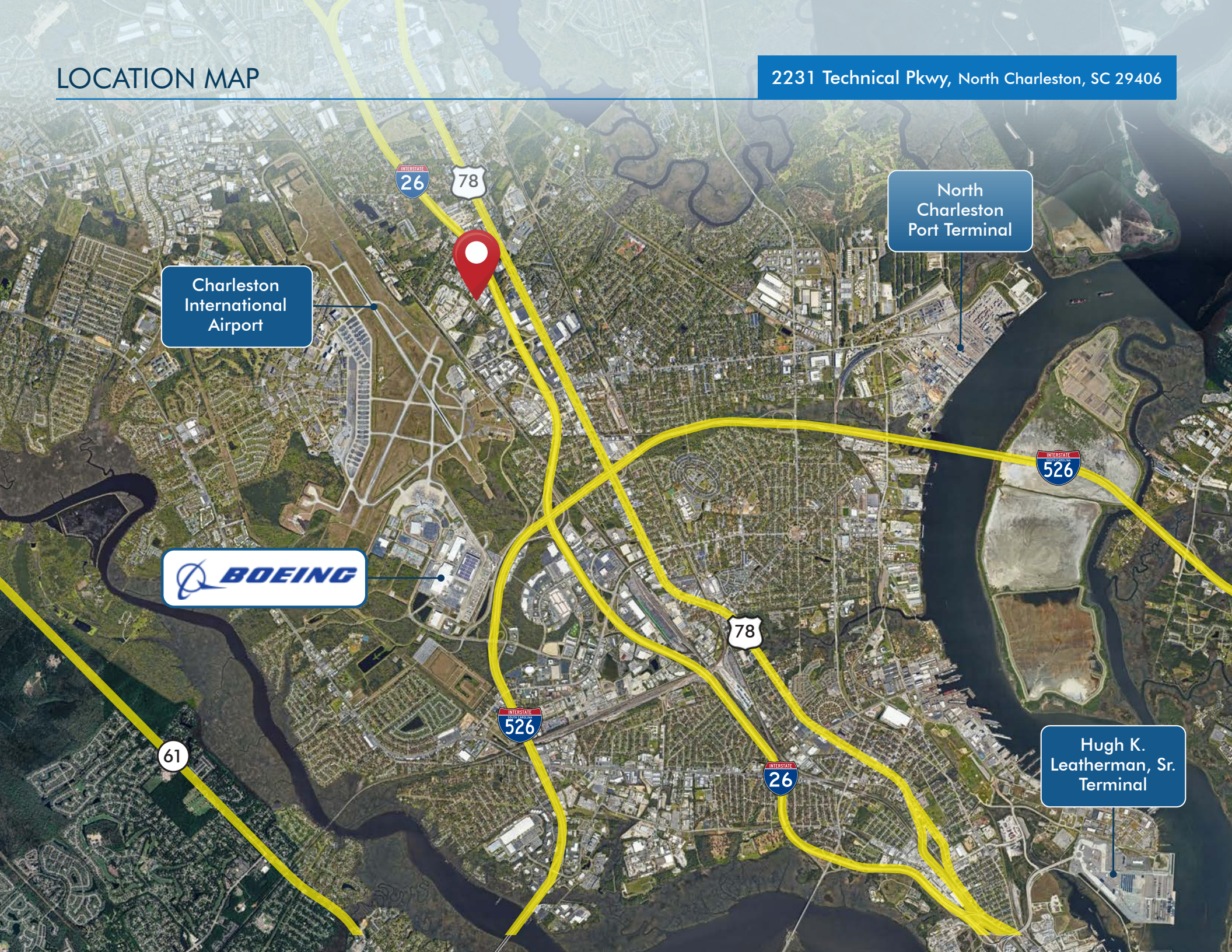

Charleston
International
Airport



North
Charleston
Port Terminal

Hugh K.
Leatherman, Sr.
Terminal



CONTACTS:

Tradd Varner, SIOR

Partner

+1.843.532.1684

[tradd.varner@](mailto:tradd.varner@harborcommercialpartners.com)

harborcommercialpartners.com

Todd Garrett, CCIM, SIOR

Managing Partner

+1.843.408.8846

[todd.garrett@](mailto:todd.garrett@harborcommercialpartners.com)

harborcommercialpartners.com

Crawford Riddle

Associate

+1.864.423.4973

[crawford.riddle@](mailto:crawford.riddle@harborcommercialpartners.com)

harborcommercialpartners.com

Harbor
COMMERCIAL PARTNERS

harborcommercialpartners.com