

GABALDON PROPERTIES



Real Estate Development

NEW DEVELOPMENT • MEDICAL OFFICE SPACE FOR LEASE - APPLETON, WI - EAST

DETAILS

- 20,000- 40,000 SF Multi-Story Class A, Medical Office Bldg. for Lease
- Upscale lobby and reception and quality finishes throughout
- Ample and convenient on-site parking for all patients and staff
- Multi-Tenant capabilities for custom built medical suites of various size

LOCATION

- Excellent, visible location at the NWC of E Calumet St (KK) & Hwy 441 on Appleton's east side.
- Located conveniently just off Hwy 441 on/off ramps for access to regional customer base.
- Sited in a high-profile and easily identifiable location next to Target, Walgreens, Starbucks and others
- Close proximity to Affinity Health/St. Elizabeth Hospital
- Patient benefit of having all medical needs met and available in a single, centralized location
- Locational benefit of being positioned at the epicenter of the commercial corridor in the rapidly growing Darboy area.

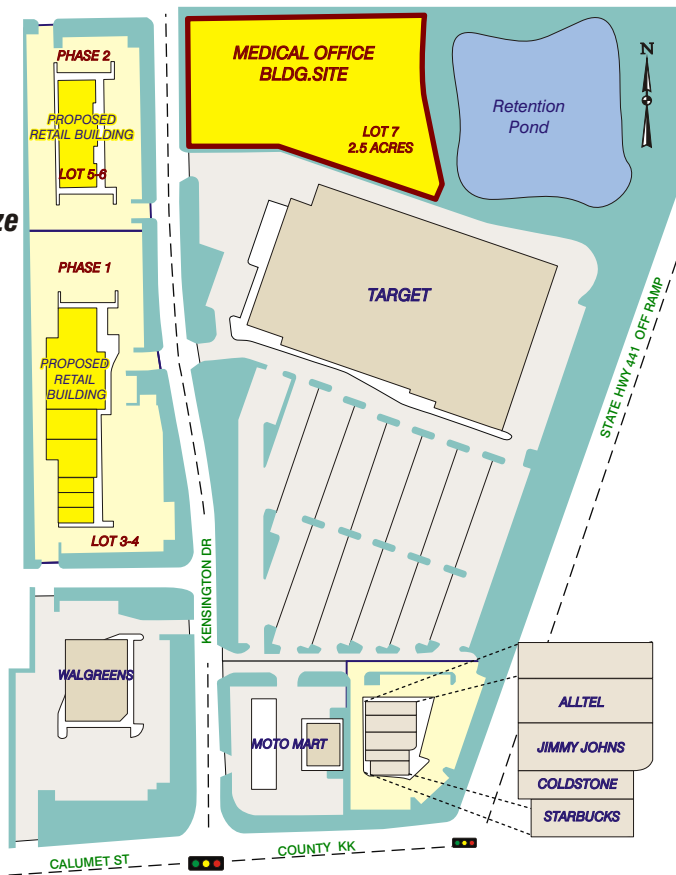

For more information about this Property, please contact Charles Gabaldon, charles@gabaldonproperties.com

Gabaldon Properties

311 E Chicago St, Suite 200, Milwaukee, WI

Phone 414.272.0047 Fax 414.272.3825

INFORMATION SHOWN ON THIS SHEET WAS FURNISHED BY SOURCES DEEMED RELIABLE AND IS BELIEVED TO BE ACCURATE BUT NO WARRANTY OR REPRESENTATION IS MADE AS TO THE ACCURACY THEREOF AND IS SUBJECT TO CORRECTION. PRICES ARE SUBJECT TO CHANGE WITHOUT NOTICE. GABALDON PROPERTIES

GP - APPLETON WI - #001
07-22-08

© NORTH ARROW MAPS, LLC 2008

This sheet is produced by North Arrow Maps
northarrowmaps.com 866.475.1499