

MEETING AND EVENT SPACE

# One Liberty Plaza



**Convене at One Liberty Plaza** sits in one of the city's first skyscrapers conveniently located in Downtown New York City. Built with human-centered design, this space has wrap-around views, plenty of natural light, flexible event rooms, and is sure to impress attendees. Convене is perfect for large conferences, town halls, trainings, product launches, board meetings, and mini exhibitions.



HIGH-SPEED  
WIFI



FLEXIBLE MEETING  
& EVENT SPACE



ON-SITE  
GOURMET CHEF



STATE OF THE ART  
TECHNOLOGY



EVENT PLANNING  
SERVICES



UNLIMITED ON-SITE  
DRINKS & SNACKS

5

MEETING ROOMS

300

MAX ROOM CAPACITY

15,000

SQUARE FEET



# Floorplan & Capacities

## 2ND FLOOR

**LEGEND**

BATHROOMS    ENTRANCE  
 ELEVATOR

**GENERAL ACCESS**

BATHROOMS  
 MEETING & EVENT ACCESS  
 MEETING ROOMS  
 NOURISH

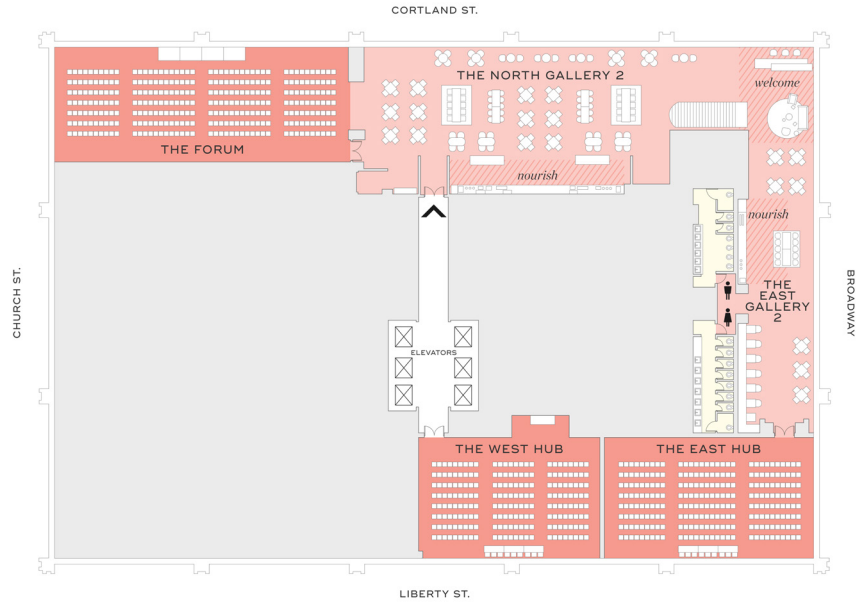

## 2ND FLOOR MEZZANINE

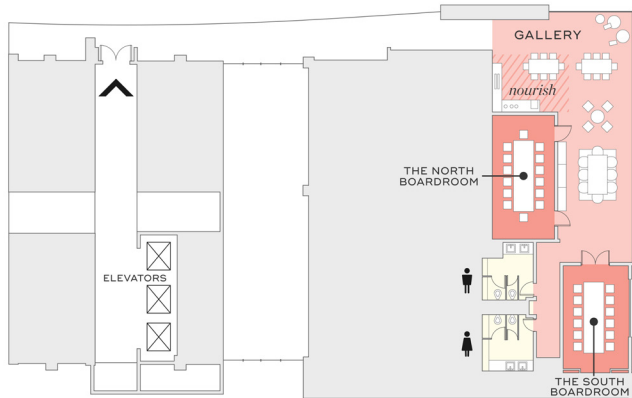

2ND FLOOR	DIMENSION [FT]	AREA [SQ FT]	CEILING HT [FT]	RECEPTION	THEATER	CLASSROOM	CONFERENCE	ROUNDS	HOLLOW SQUARE	PODS
The Forum	36' x 90'	3,423'	17'	300	300	140	n/a	128	80	102
The East Hub	37' x 63'	2,576'	21'	200	180	120	n/a	104	60	66
The West Hub	37' x 55'	2,281'	21'	150	160	78	n/a	72	50	66
The East Gallery 2	19' x 88'	2,846'	8'	150	n/a	n/a	n/a	n/a	n/a	n/a
The North Gallery 2	41' x 117'	4,919'	21'	400	n/a	n/a	n/a	n/a	n/a	n/a
<b>2ND FLOOR MEZZ</b>										
The North Boardroom	14' x 27'	388'	8'	n/a	n/a	n/a	14	n/a	n/a	n/a
The South Boardroom	14' x 22'	335'	8'	n/a	n/a	n/a	14	n/a	n/a	n/a
The Gallery 2 Mezz	16' x 54'	1,088'	8'	30	n/a	n/a	n/a	n/a	n/a	n/a