



FOR
LEASE



224 LOGISTICS PARK SPACE C

Industrial Space: 54,947 SF Shell / BTS Office

6433 SE Lake Road, Milwaukie OR 97222

Located in the Clackamas County Enterprise Zone, 224 Logistics Park features ample secured trailer storage and optimal space for truck maneuverability. The strategic location, which is only 9 miles from the Central Business District, enables rapid deployment to the entire Pacific Northwest with major markets (Boise, Seattle, San Francisco) all less than one day away.

DON OSSEY, SIOR

503-542-4344

don@capacitycommercial.com

STEPHEN OSSEY

503-542-4027

stephen@capacitycommercial.com

LAURA GENTRY, CPM®

503-542-2897

laura@capacitycommercial.com



DEVELOPMENT PLAN

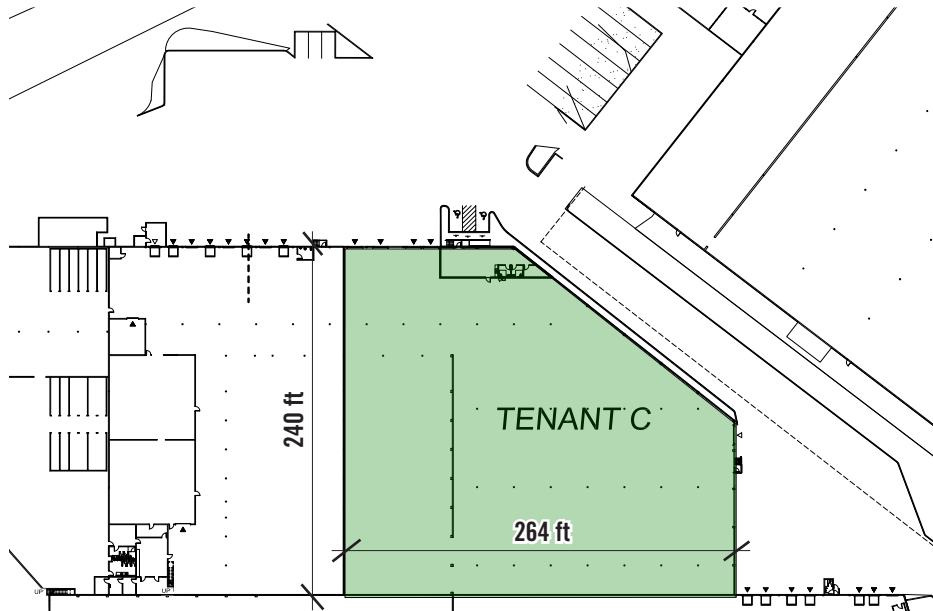

PROPERTY DETAILS

| | |
|------------------------|--|
| Address | 6433 SE Lake Road, Space C Milwaukie |
| Total SF | 54,947 SF |
| Office SF | To Suit Tenant |
| Construction | Concrete Tilt-Up |
| Dock Loading | 3 Dock High (9'x10') |
| Grade Loading | 1 Grade (12'x14') |
| Clear Height | 17' - 28' |
| Column Spacing | Varies |
| Power | Heavy 3-Phase |
| Lighting | Motion-Sensing LED |
| Auto Parking | 6-10 Parking Spaces |
| Zoning | GI - Clackamas County (General Industrial) Clackamas County Enterprise Zone |
| Access | Fully Fenced with Guard Shack and 24/7 Security |
| Recent Upgrades | Paint, Roof, Landscaping, & Parking Lot |
| Price | Call for Rates |

DON OSSEY, SIOR

503-542-4344

don@capacitycommercial.com

STEPHEN OSSEY

503-542-4027

stephen@capacitycommercial.com

LAURA GENTRY, CPM®

503-542-2897

laura@capacitycommercial.com



SITE PLAN

6433 SE Lake Road, Space C
Milwaukie

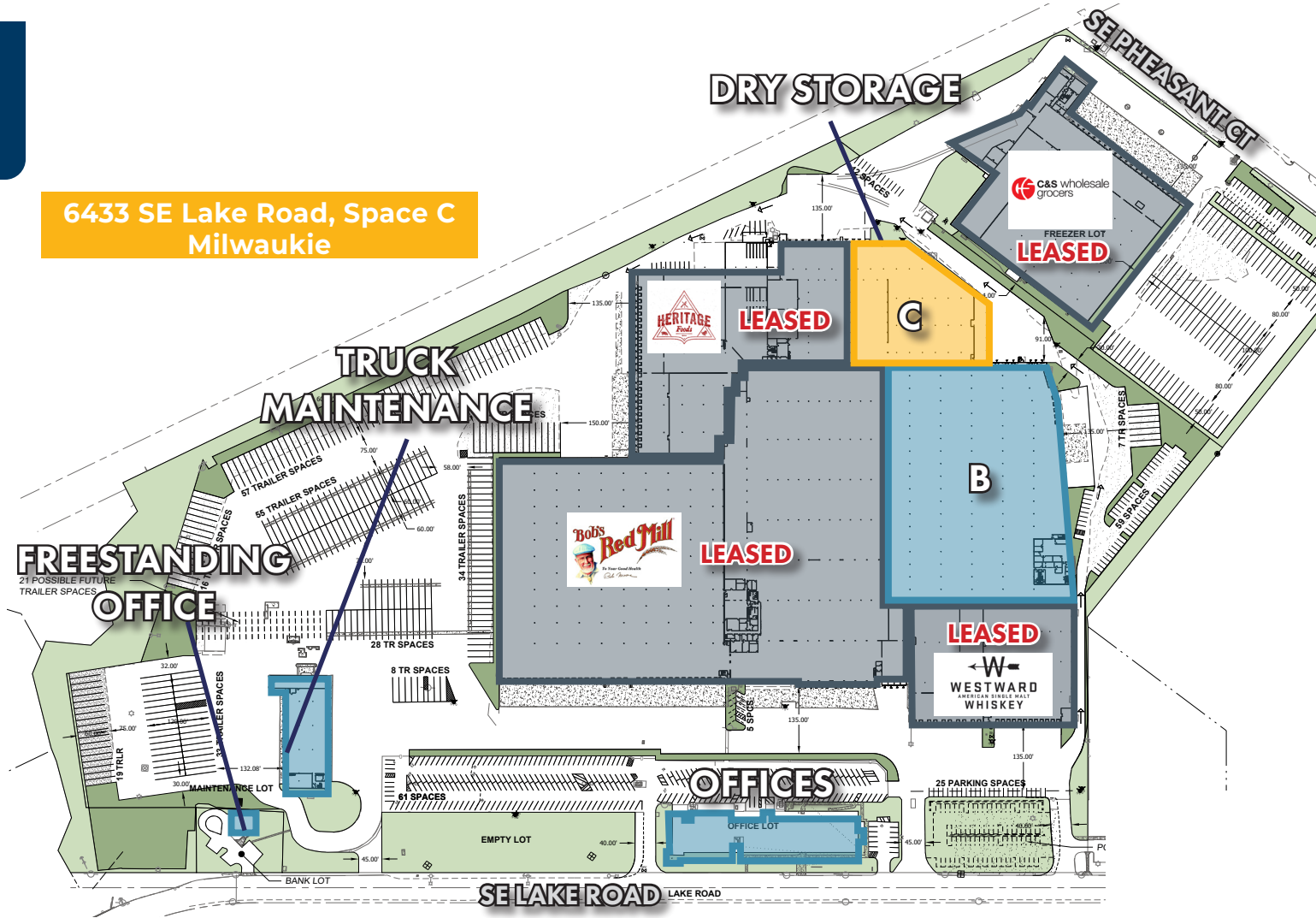



AREA
MAP



DRIVING INFORMATION

| | | |
|--------------------------|-----------|-----------------|
| Distance to I-205 | 1.5 Miles | 5 Minute Drive |
| Distance to I-5 | 8 Miles | 20 Minute Drive |
| Distance to Portland CBD | 9 Miles | 20 Minute Drive |
| Distance to PDX Airport | 15 Miles | 20 Minute Drive |