

Teller County Property Records

Property Record

Acct No:R0003425 [Map](#)

Parcel Picture

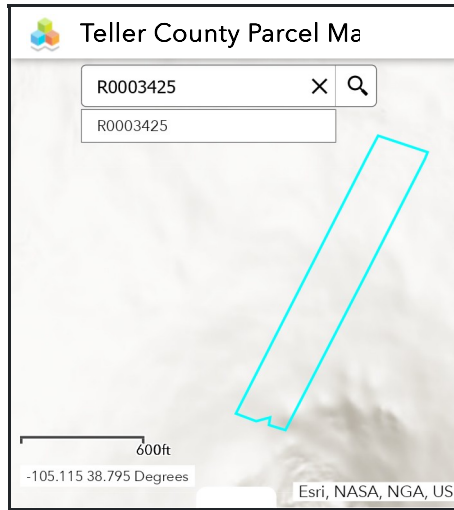

[Full Screen Map](#) [Vacant Land Sales Map](#) [Comps List](#)

Ownership

Account No	R0003425
Parcel Id	10112.10030010
Notice of Value	PDF of 2025 Notice of Value
Actual	\$11,282
Assessed	\$3,050
Acct Type	Vacant Land
Owner Name	MORREN, LOWELL A & JULIE M
Mailing Address	PO BOX 753 CRIPPLE CREEK, CO 808130753

Location

Physical Address	3328 CR 81
School Dist	RE-1
Acres	8.583700
Map No.	3289
Tax Dist	10
Area	PIKES PEAK AREA
Brief Legal	33-14-69 11210 OCEAN #2 MS

Brief Legal Description is not intended for use on legal documents

Zoning

[Zoned A-1](#)

Provided by Community Development Department for Questions call 719-687-3048

Land Attributes

Land Type	Abst Code	Acres
Vacant	0530	8.58

Building Information (provided by Assessor)

Transfers (provided by Assessor)

Sale Date	Reception No	Deed Type	Sale Price
04/06/1995	431739	Warranty Deed	\$7,500
05/01/1998	476305	Quit Claim	\$0
05/11/1998	476306	Warranty Deed	\$25,000
08/10/2000	508283	Quit Claim	\$0
03/26/2013	661558	Warranty Deed	\$1,050,000
12/20/2019	721984	Warranty Deed	\$950,000

Building Permits

Date	Permit No.	Description	Permit Issued By
------	------------	-------------	------------------

Property Tax History (provided by Treasurer)

Delinquent taxes are not shown on this website.

[Tax detail on Treasurers Web Site \(Note: Select Public User Login Button if prompted\)](#)

[Tax Payment Web site](#)

Authority	Mil Levy	Amount
TELLER COUNTY	14.653	\$44.69
RE-1 SCHOOL DIST	12.182	\$37.16
SO TELLER COUNTY LIBRARY	0.534	\$1.63
SO TELLER COUNTY HEALTH S	3.71	\$11.32
TOTAL	31.07900	\$94.80

Tax Year	Tax Amount	Value Type
2025	\$57.64	Non-School
2025	\$37.16	School
2024	\$119.26	Standard
2023	\$115.40	Standard
2022	\$74.04	Standard
2021	\$74.76	Standard

Beginning with the 2025 tax year, new legislation requires tax amounts to be calculated separately by school and non-school value type. Please note that you must now combine the school and non-school amounts to determine your total tax amount for the year. Please call 719-689-2985 for questions about your tax bill.

About

The contributing Teller County Offices keep the information shown on this web site as current and as accurate as possible

Disclaimer

The Information Provided on this site is as accurate and complete as reasonably possible. Use of this information is the sole responsibility of the user, and Teller County assumes no liability associated with the use or misuse of this information.

Accessibility Notice

This page contains documents that may not be fully accessible to individuals using assistive technologies. We are actively working to remediate these issues. Teller County is committed to providing a timely response to reports of inaccessible digital content or requests for reasonable accommodation. If you need assistance accessing any content on this page, please fill out our [Website Accessibility Form](#).

Contributors

Assessor

Treasurer

Clerk and Recorder

Community Development
Department (CDD)

[Mail comments or suggestions to web developer](#)

Teller County Information Technology © 2022