

FOR LEASE
2,519 SF



2200 SOUTH MAIN STREET
BLACKSBURG, VIRGINIA 24060

BUILD TO SUIT OFFICE SPACE



THALHIMER

PROPERTY HIGHLIGHTS

- 2,519 SF available for lease
- Modern office space in prime location on S. Main Street
- Join **TRC Companies** and **University Physical Therapy** as a tenant in this redeveloped office building
- Signage opportunities
- Professional setting with ample parking
- High visibility location near Corporate Research Center and Virginia Tech
- Lease rates are per rent schedule

* *Rental rates subject to final terms and conditions*

Suite	Suite Square Footage	\$/Mo	\$/Yr	\$/SF NNN
C	2,519	\$4,408.25	\$52,889	\$21.00



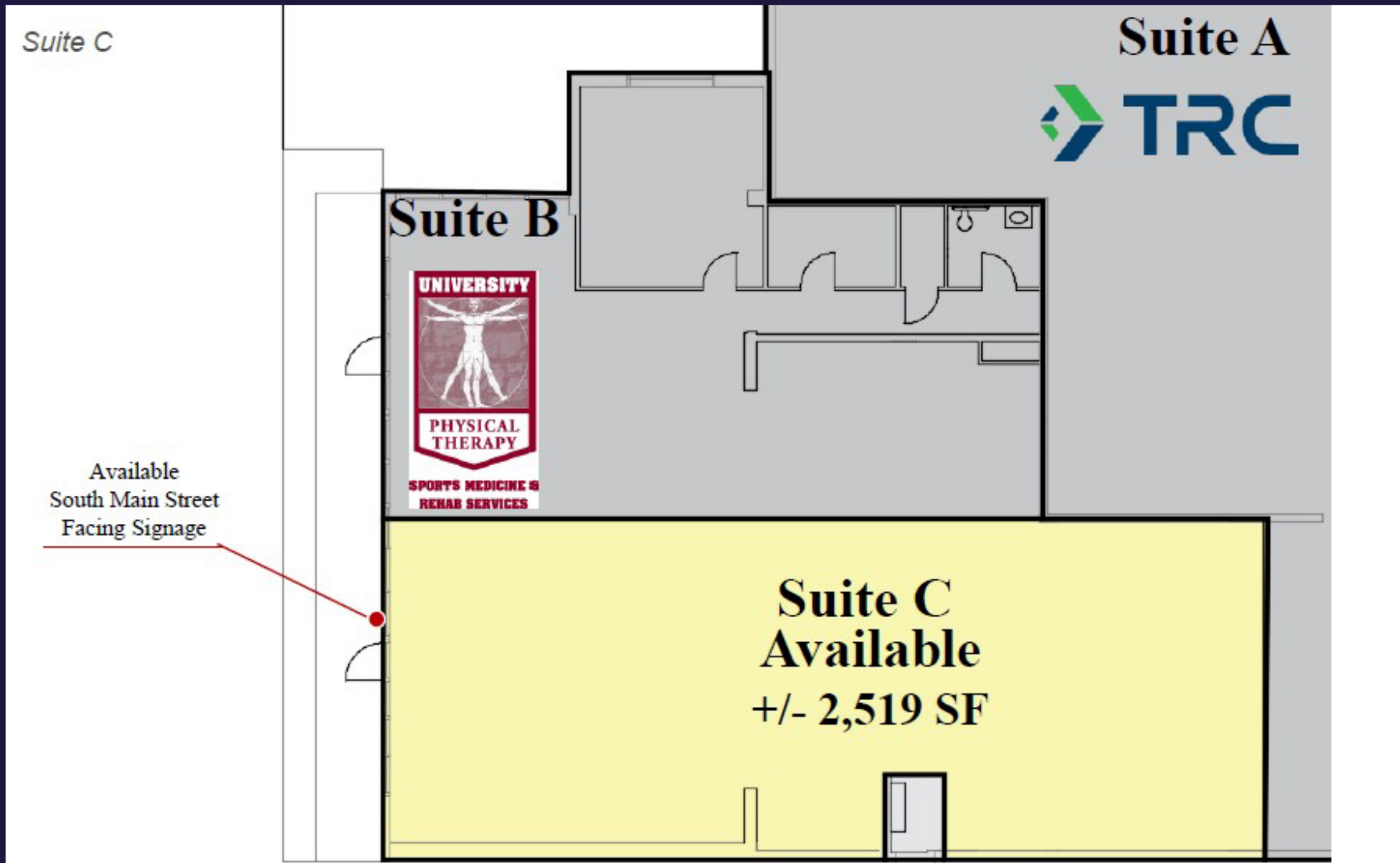

FLOOR PLAN

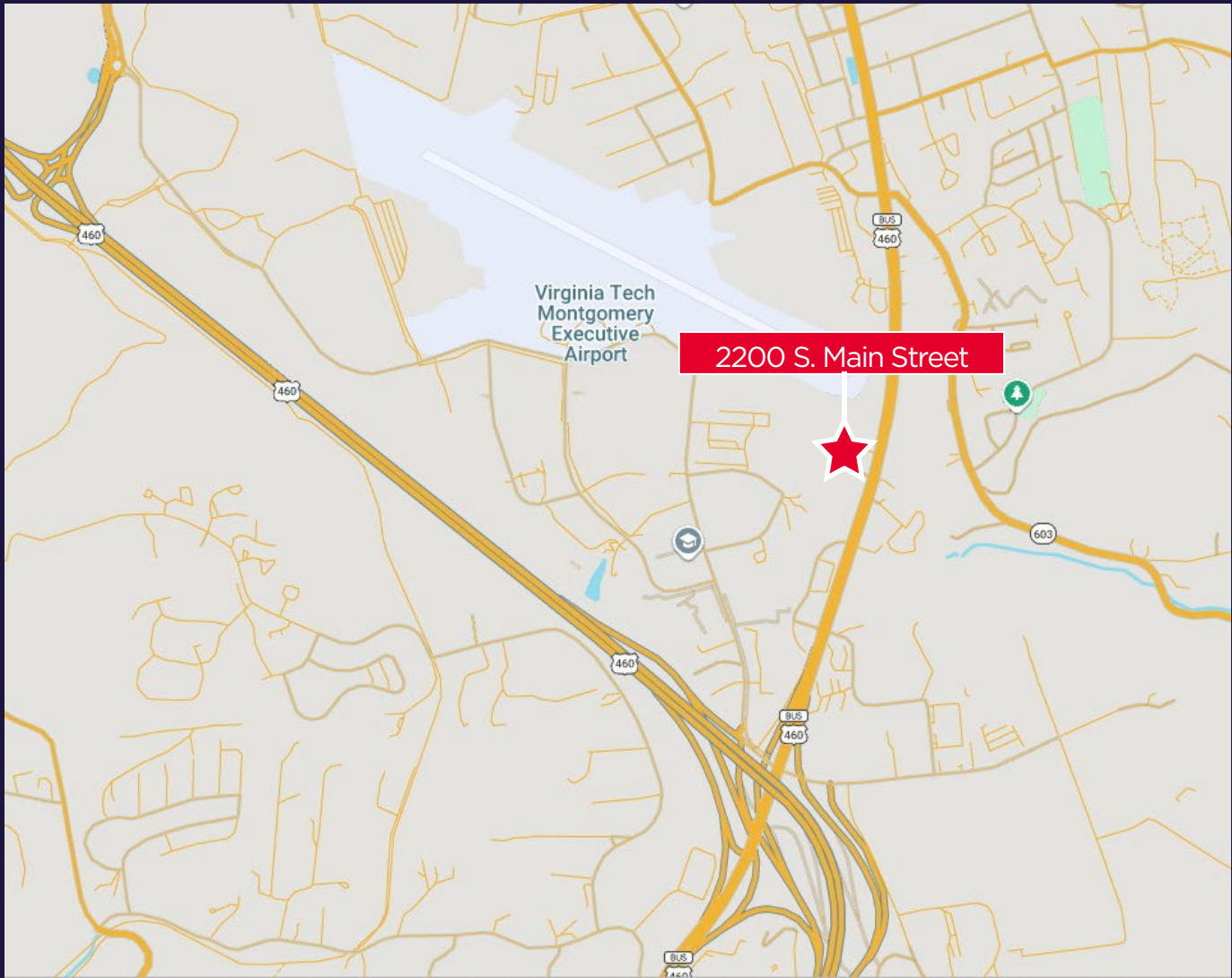

Major Retail less than 10-minute drive from 2200 S. Main St., Blacksburg



2200 SOUTH MAIN STREET, BLACKSBURG, VA

DEMOGRAPHICS

	POPULATION	AVERAGE HH INCOME	DAYTIME POPULATION
1 Mile	4,315	\$80,023	6,393
3 Miles	36,322	\$93,559	51,956
5 Miles	69,239	\$93,846	82,015



CONTACT INFORMATION

PRICE GUTSHALL

Vice President
540 767 3011
price.gutshall@thalhimer.com

KENT ROBERTS

Senior Associate
540 767 3012
kent.roberts@thalhimer.com

Thalhimer
310 First Street, Suite 300
Roanoke, VA 24011
thalhimer.com



Independently Owned and Operated / A Member of the Cushman & Wakefield Alliance

Cushman & Wakefield | Thalhimer © 2026. No warranty or representation, express or implied, is made to the accuracy or completeness of the information contained herein, and same is submitted subject to errors, omissions, change of price, rental or other conditions, withdrawal without notice, and to any special listing conditions imposed by the property owner(s). As applicable, we make no representation as to the condition of the property (or properties) in question.