

# For Sublease

5899 Bremono Road  
Richmond, VA 23226



# St. Mary's Hospital MOB West

## PROPERTY HIGHLIGHTS

- 12,192 SF available
- Existing Operatory for Sublease on St. Mary's campus
- Class A medical office
- Located in the near West End with convenient access
- Term through 11/30/2027
- On site parking

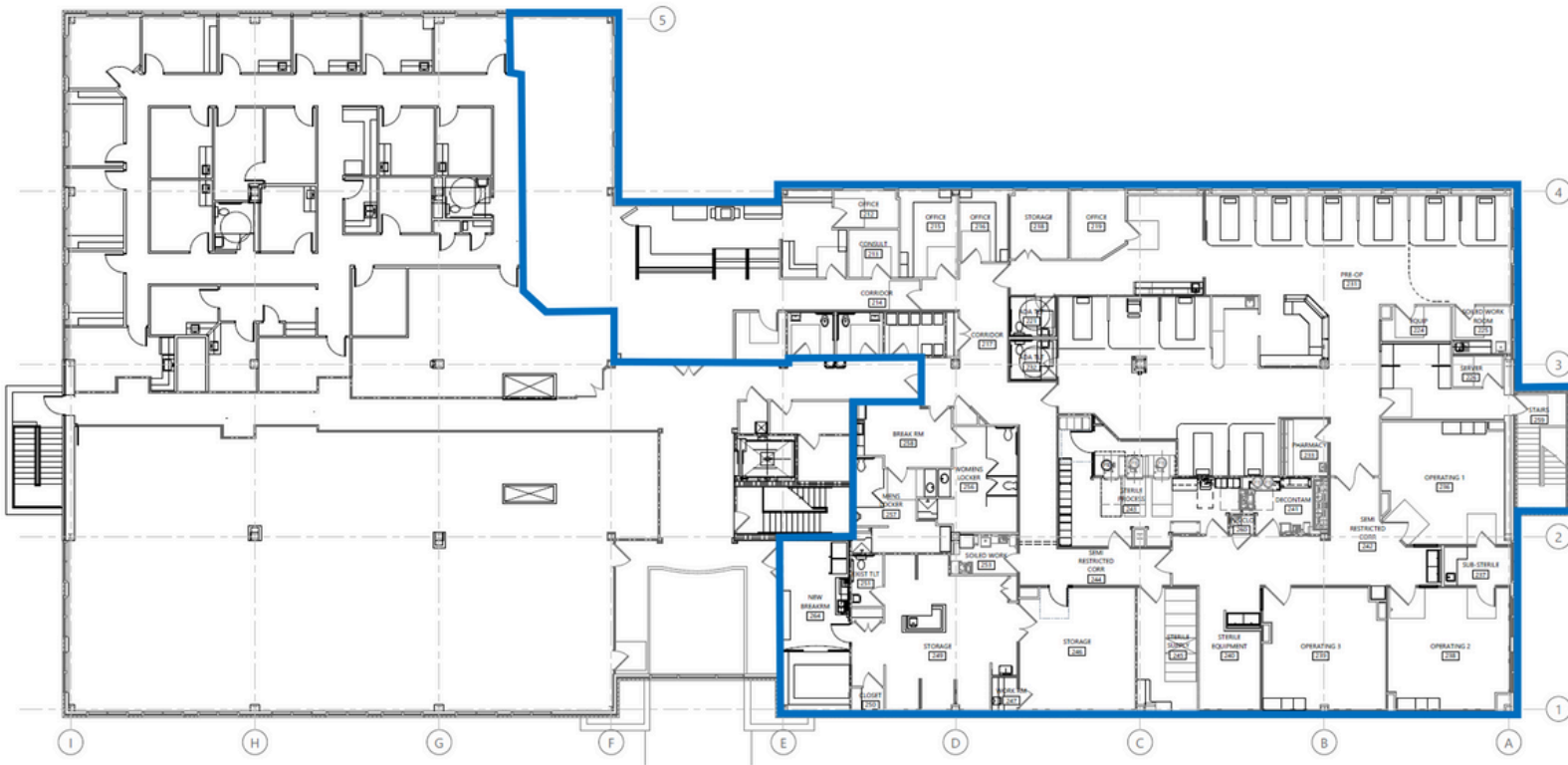

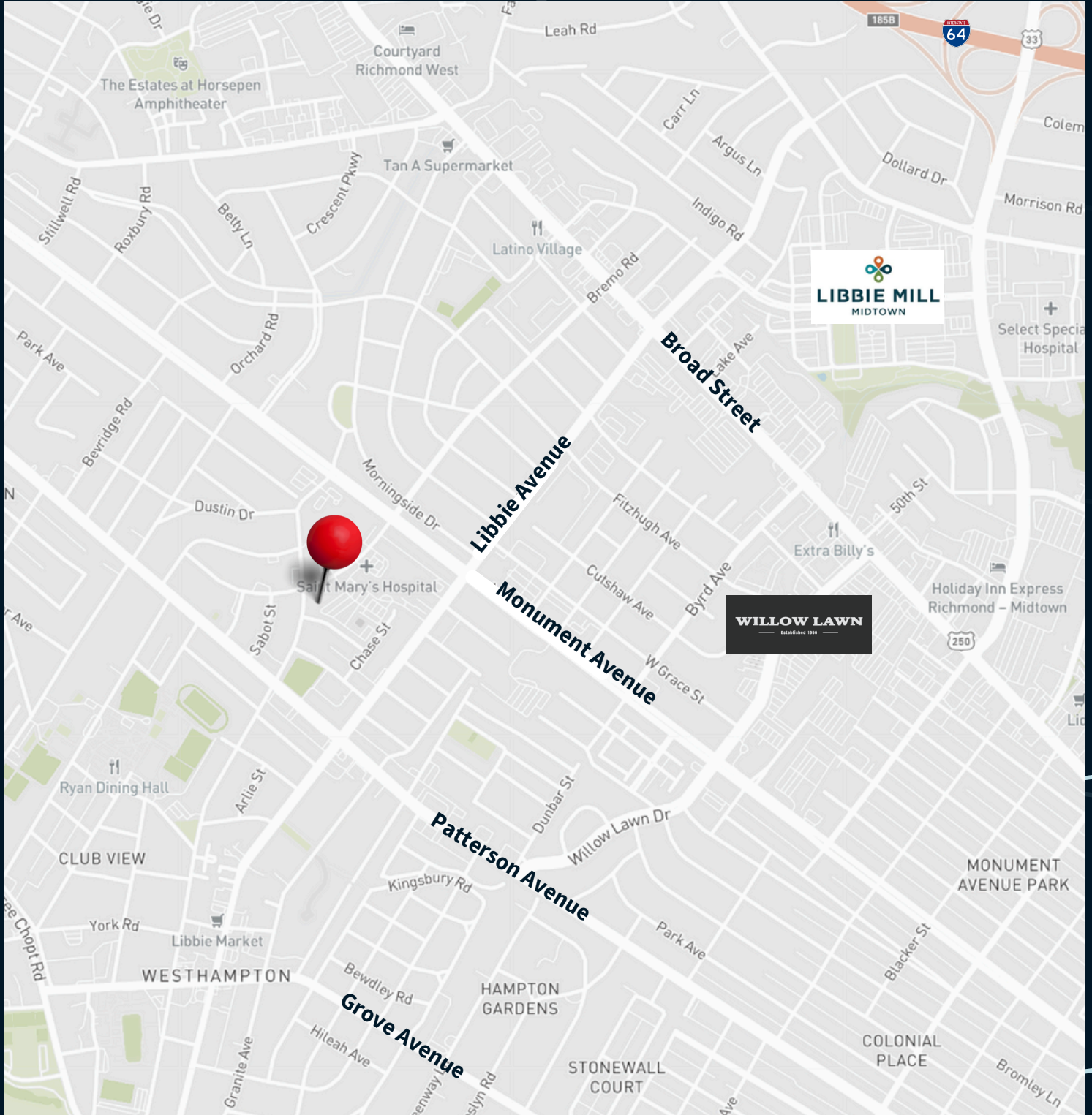

**Muscoe Garnett**

[muscoe.garnett@jll.com](mailto:muscoe.garnett@jll.com)

+1 (804) 200 6340

**Jimmy Appich**

[jimmy.appich@jll.com](mailto:jimmy.appich@jll.com)

+1 (804) 200 6420