



3215 S Sossaman Rd

3215 S Sossaman Rd, Mesa, AZ 85212



Timothy Remick
Chambers Realty Group
564 S Main St, Camp Verde, AZ 86322
timothyremickaz@gmail.com
(520) 276-8514



3215 S Sossaman Rd

\$7,000,000

10 acres of excess light industrial zoned land near Sossaman Road in the City of Mesa available for sale. Located across Sossaman from the new \$1 Billion Dollar Google "Red Hawk" data center campus and less than two miles from the largest Amazon storage and distribution center in the United States this...

Access to the property is available off of Paloma Avenue. Survey will need to be completed to determine where the lot split would be done. Approximate lot line is located at the back of the fields. Owner would consider carrying with at least a 50% down payment.

Submit...

- Property is strategically located just north of the Elliot Road Technology Corridor
- Nearby Companies Include Apple, Meta, Amazon, NTT, Comarch, Niagara, EdgeCore, and Google
- Nearby and with easy access to both the 202 Loop and US Hwy 60
- 15 minute drive to Mesa Gateway Airport
- Value Add Opportunity
- Owner will carry

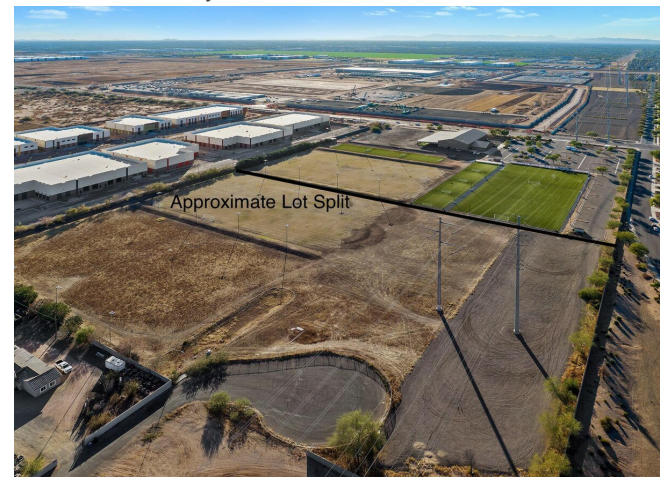

Price:	\$7,000,000
Property Type:	Land
Property Subtype:	Agricultural
Proposed Use:	
Sale Type:	Investment
Total Lot Size:	10.00 AC
Sale Conditions:	Redevelopment Project
No. Lots:	1
Zoning Description:	AG
APN / Parcel ID:	304-04-010K

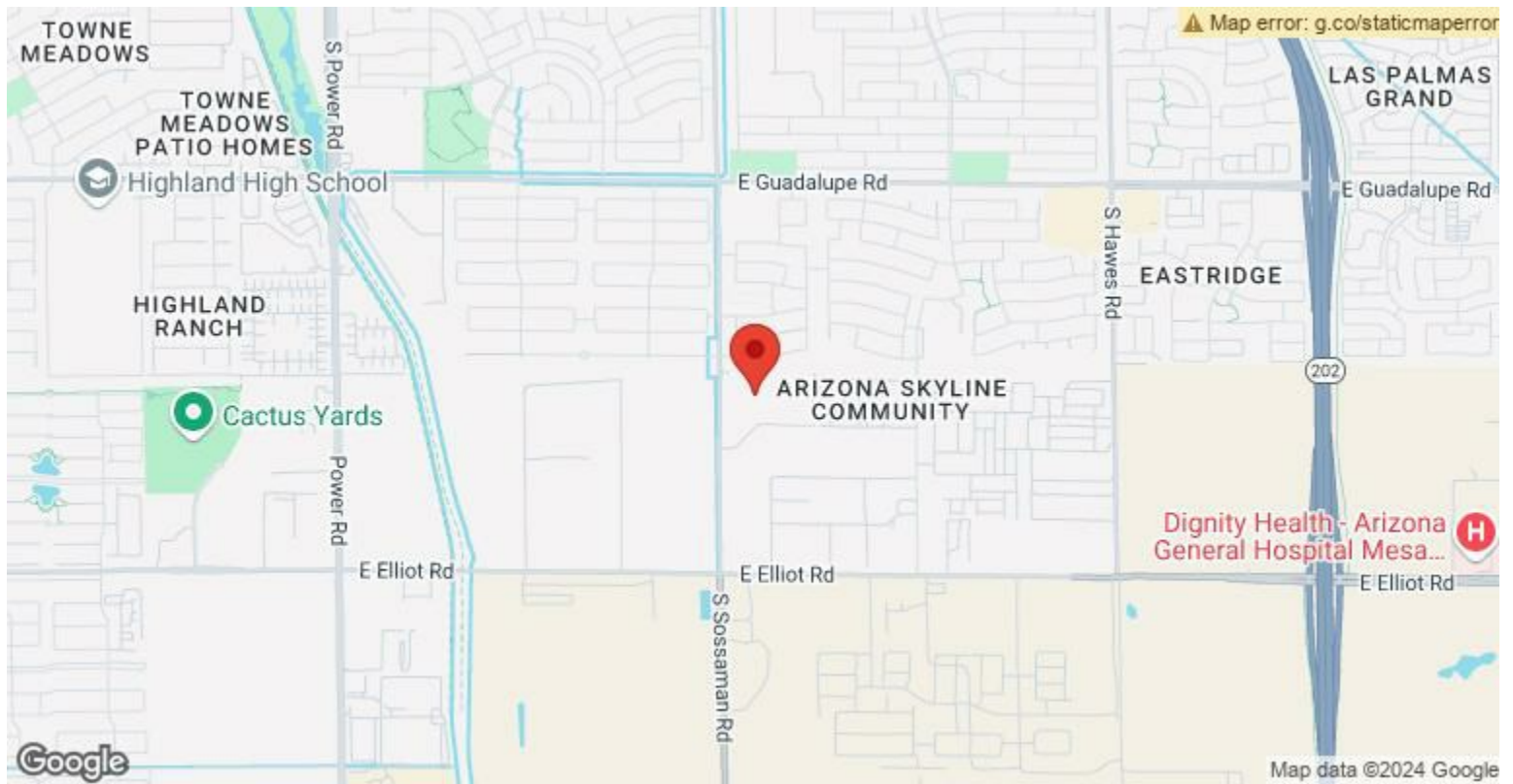

3215 S Sossaman Rd, Mesa, AZ 85212

10 acres of excess light industrial zoned land near Sossaman Road in the City of Mesa available for sale. Located across Sossaman from the new \$1 Billion Dollar Google "Red Hawk" data center campus and less than two miles from the largest Amazon storage and distribution center in the United States this property is located in a prime area. It has easy access to both the Hwy 202 loop and Hwy 60 with on ramps to both highways within approximately two miles. The property is in close proximity to the Mesa Gateway Airport and the Elliot Road Technology Corridor. Nearby is the new Hawes Crossing development which will feature 355 new single family homes and 103 new townhomes built by Taylor Morrison. SRP is building the new sidewinder substation adjacent to the Google "Red Hawk" data center. Construction of the Google property is supposed to be fully completed by 2030.

Property Photos



Property Photos



Property Photos

