

COMMERCIAL LAND FOR SALE

710 Oak Grove Road
Chesapeake, VA



SALE PRICE \$625,000

EXCLUSIVELY OFFERED BY:

LINDSEY R. ELLIOTT

lre@riddleassociates.com

(757) 523-1900

- 1.804 acres commercial land
- Zoned B2: General Business
- City Approved Plans
- Centrally located in the Greenbrier submarket of Chesapeake
- Less than 1 mile away from Chesapeake Regional Hospital
- Convenient access to I-64, Great Bridge Bypass and Chesapeake Expressway

The information presented in this marketing flyer is obtained from sources believed to be reliable, but is not warranted. This offer is subject to prior sale or lease, errors, omissions or withdrawal without notice.

RIDDLE ASSOCIATES, INC.
Commercial Real Estate

"Real Estate Services Tailored to Your Needs"

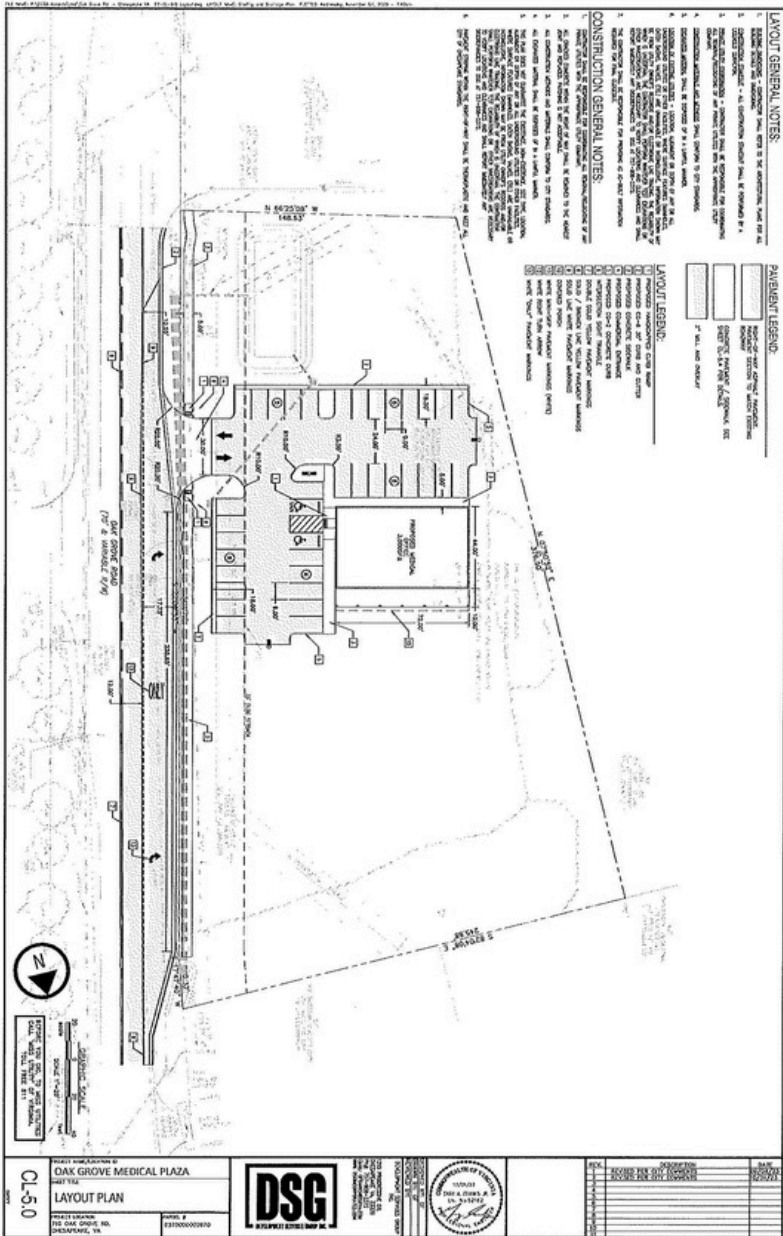

The information presented in this marketing flyer is obtained from sources believed to be reliable, but is not warranted. This offer is subject to prior sale or lease, errors, omissions or withdrawal without notice.

RIDDLE ASSOCIATES, INC.
 Commercial Real Estate

"Real Estate Services Tailored to Your Needs"

DEMOGRAPHICS	2 MILES	5 MILES	10 MILES
2024 Population	33,812	189,838	652,036
Annual Growth 2024 - 2029	0.6%	0.5%	0.1%
Avg Household Income	\$98,637	\$106,579	\$92,146
2024 Households	14,482	71,681	249,198

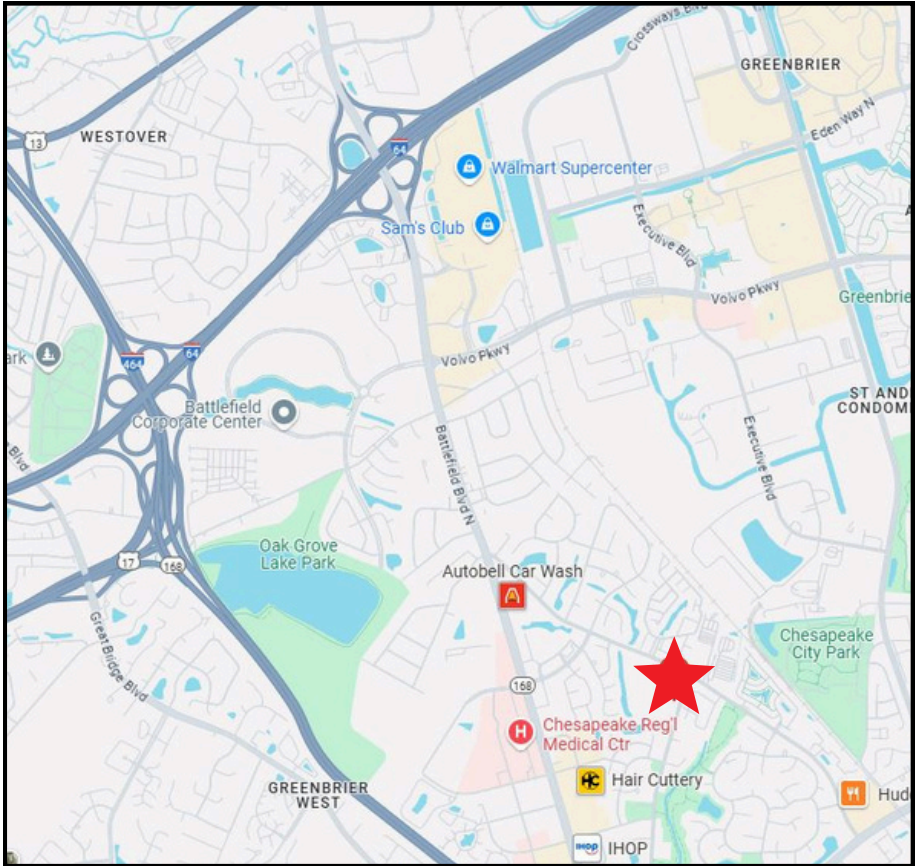

The information presented in this marketing flyer is obtained from sources believed to be reliable, but is not warranted. This offer is subject to prior sale or lease, errors, omissions or withdrawal without notice.

RIDDLE ASSOCIATES, INC.
Commercial Real Estate

"Real Estate Services Tailored to Your Needs"



The information presented in this marketing flyer is obtained from sources believed to be reliable, but is not warranted. This offer is subject to prior sale or lease, errors, omissions or withdrawal without notice.

RIDDLE ASSOCIATES, INC.
Commercial Real Estate

“Real Estate Services Tailored to Your Needs”