



OFFICE & WAREHOUSE SPACE

FOR LEASE

4740 DWIGHT EVANS ROAD, SUITE F | CHARLOTTE

Great warehouse space with office available in an established office park just minutes from I-77 and Charlotte Douglas International Airport.

BILL CUTHBERTSON, CCIM
c 704 806 3085
bcuthbertson@mecacommercial.com



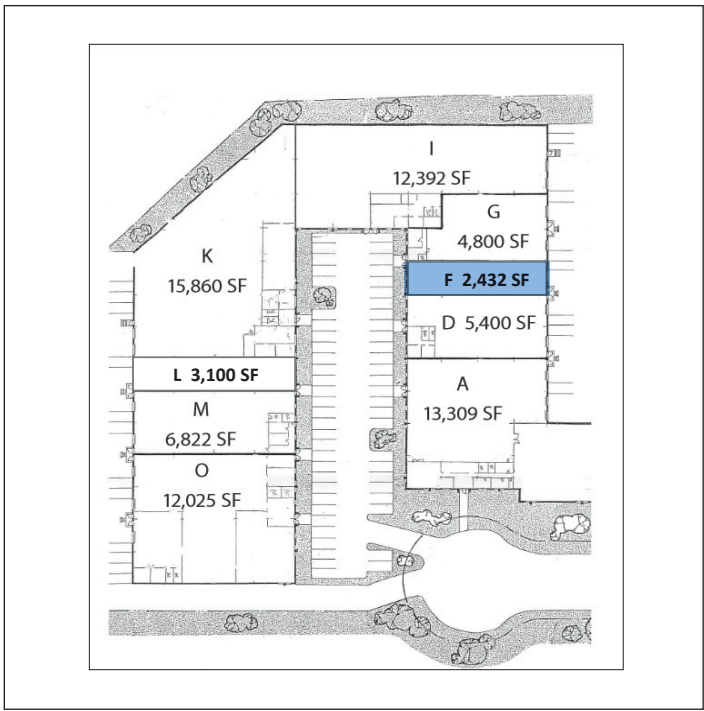

PROPERTY INFORMATION

SF*
 Total SF - 2,432
 Office space - ± 300 SF

ZONED
 I-2

- FEATURES**
- 17' Clear height
 - 1 Dock high door
 - Masonry construction
 - Built in 1979

LEASE RATE
 \$12.00/SF NNN
 \$1.49/SF Expenses

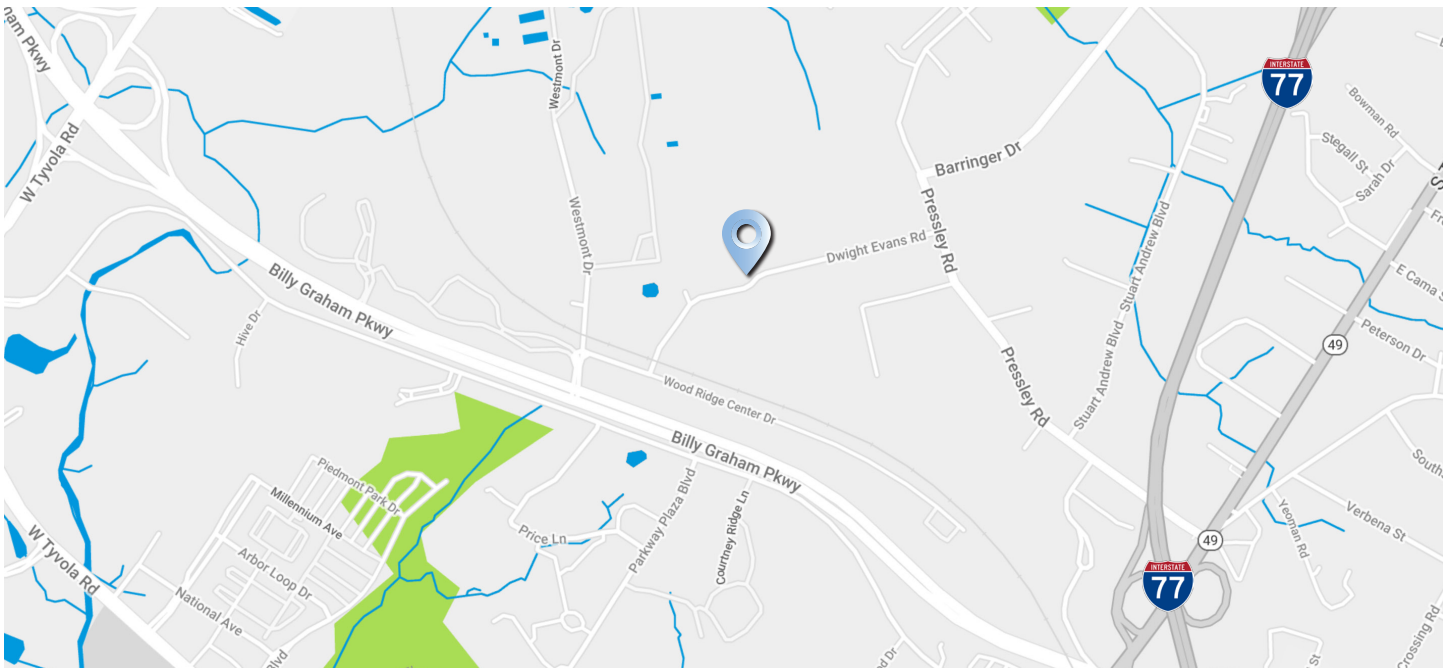

BILL CUTHBERTSON, CCIM
 c 704 806 3085
 bcuthbertson@mecacommercial.com
 2216 Monument Street
 Charlotte, NC 28208
 704 971 2000



mecacommercial.com

© 2026 Metro Realty, LLC. All rights reserved. Metro Realty, LLC fully supports the principles of the Fair Housing Act and the Equal Opportunity Act.
 *The land acreage and/or building square footage was obtained from the County's Geographical Information System or other electronic resources. For exact square footage and/or acreage, we recommend that prior to purchase, a prospective Buyer/Tenant obtain a boundary survey or have the building measured professionally.