



12,450 RSF

**Industrial
Warehouse Space
for Sublease**

4774 NE 22nd Street

Des Moines, Iowa 50313

Property information

- Availability: 12,450 RSF
- Dimensions: 150' x 83'
- Sublease rate: \$9.00 NNN
- Est. OPEX: Available upon request
- Sublease expiration: October 31, 2028

Property features

- Small office area
- Dock doors: 17
- 20' clear height
- Radiant heat
- Cross-dock facility

Office area floor plan

4774 NE 22nd Street | Des Moines, Iowa 50313

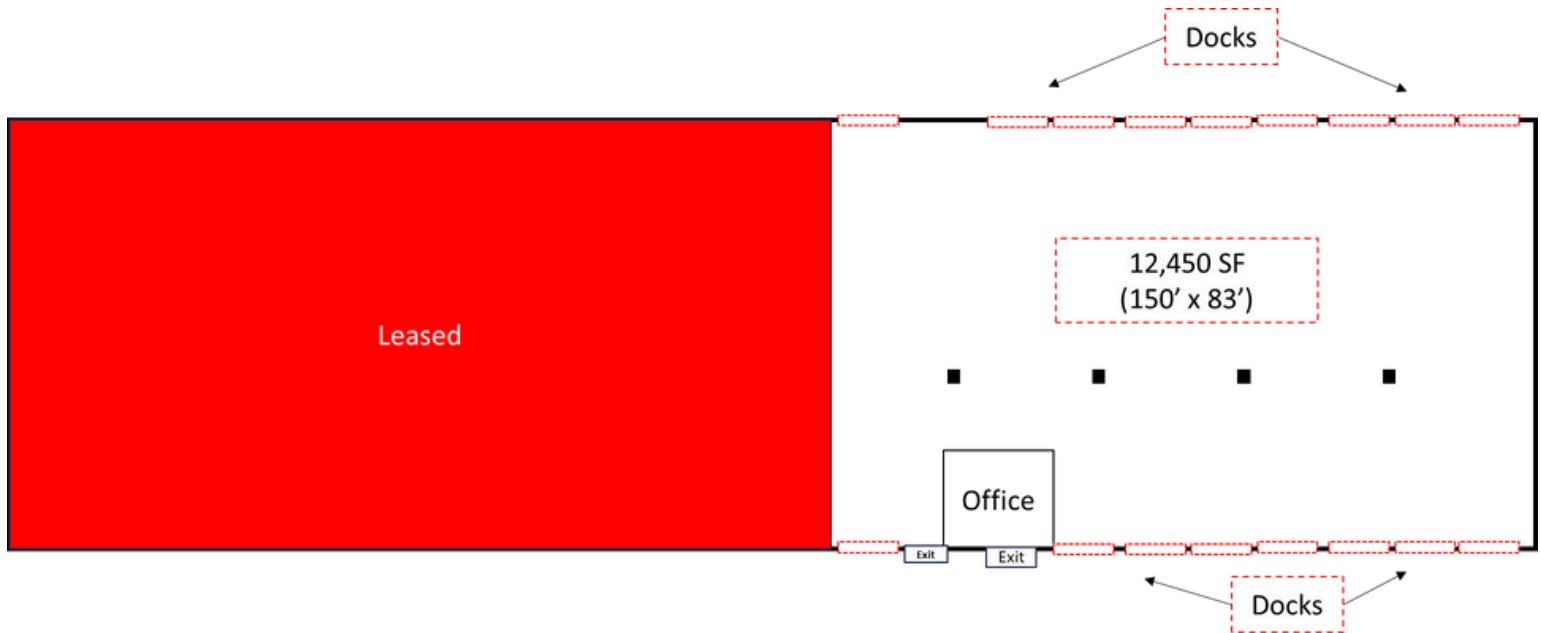

Property features

- Small office area
- Dock doors: 17
- 20' clear height
- Radiant heat
- Cross-dock facility

Images

Industrial warehouse space for sublease



4774 NE 22nd Street



Des Moines, Iowa 50313

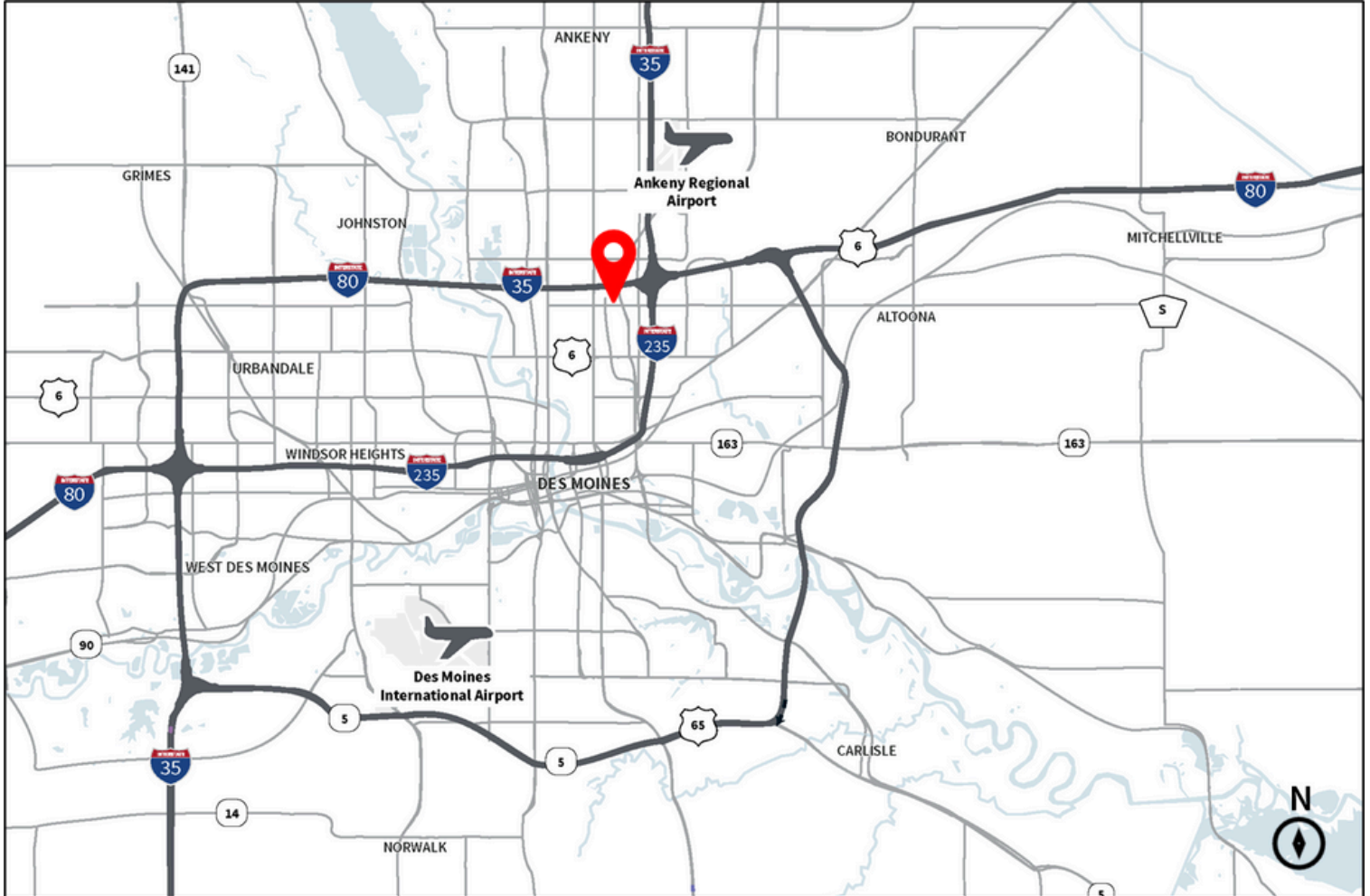

Contact

Austin Hedstrom, SIOR

Executive Vice President
+1 515 414 1767
austin.hedstrom@jll.com

Tanner Hedstrom

Vice President
+1 515 745 2734
tanner.hedstrom@jll.com

jll.com/des-moines

Jones Lang LaSalle Americas, Inc., a licensed real estate broker in 48 states | DISCLAIMER Although information has been obtained from sources deemed reliable, neither Owner nor JLL makes any guarantees, warranties or representations, express or implied, as to the completeness or accuracy as to the information contained herein. Any projections, opinions, assumptions or estimates used are for example only. There may be differences between projected and actual results, and those differences may be material. The Property may be withdrawn without notice. Neither Owner nor JLL accepts any liability for any loss or damage suffered by any party resulting from reliance on this information. If the recipient of this information has signed a confidentiality agreement regarding this matter, this information is subject to the terms of that agreement. ©2022. Jones Lang LaSalle IP, Inc. All rights reserved.