



Buttermilk Crossing

2335 Buttermilk Crossing
Crescent Springs, KY 41017

NABergman

For Lease

1,254 - 4,000 SF | \$18.00 - 20.00 SF/yr

Retail Space



Buttermilk Crossing

2335 Buttermilk Crossing
Crescent Springs, Kentucky 41017

Property Highlights

- Highly trafficked retail center - 621,900 annual visits (per Placer.ai)
- Suite 2303 - 1,607 SF (white box)
- Suite 2315 - 4,000 SF (warm grey shell) *divisible
- Suite 2327 - 5,715 SF (built out medical office w/ MRI) *divisible
- Suite 2341 - 1,254 SF (former dance studio)
- Rental Rate of \$18 - \$20/SF NNN
- Opportunity for a variety of uses including medical/professional and fitness

For More Information

Laurence Bergman

O: 513 322 6307

larry@bergman-group.com | KY #192679

For Lease

1,254 - 4,000 SF | \$18.00 - 20.00 SF/yr

Retail Space

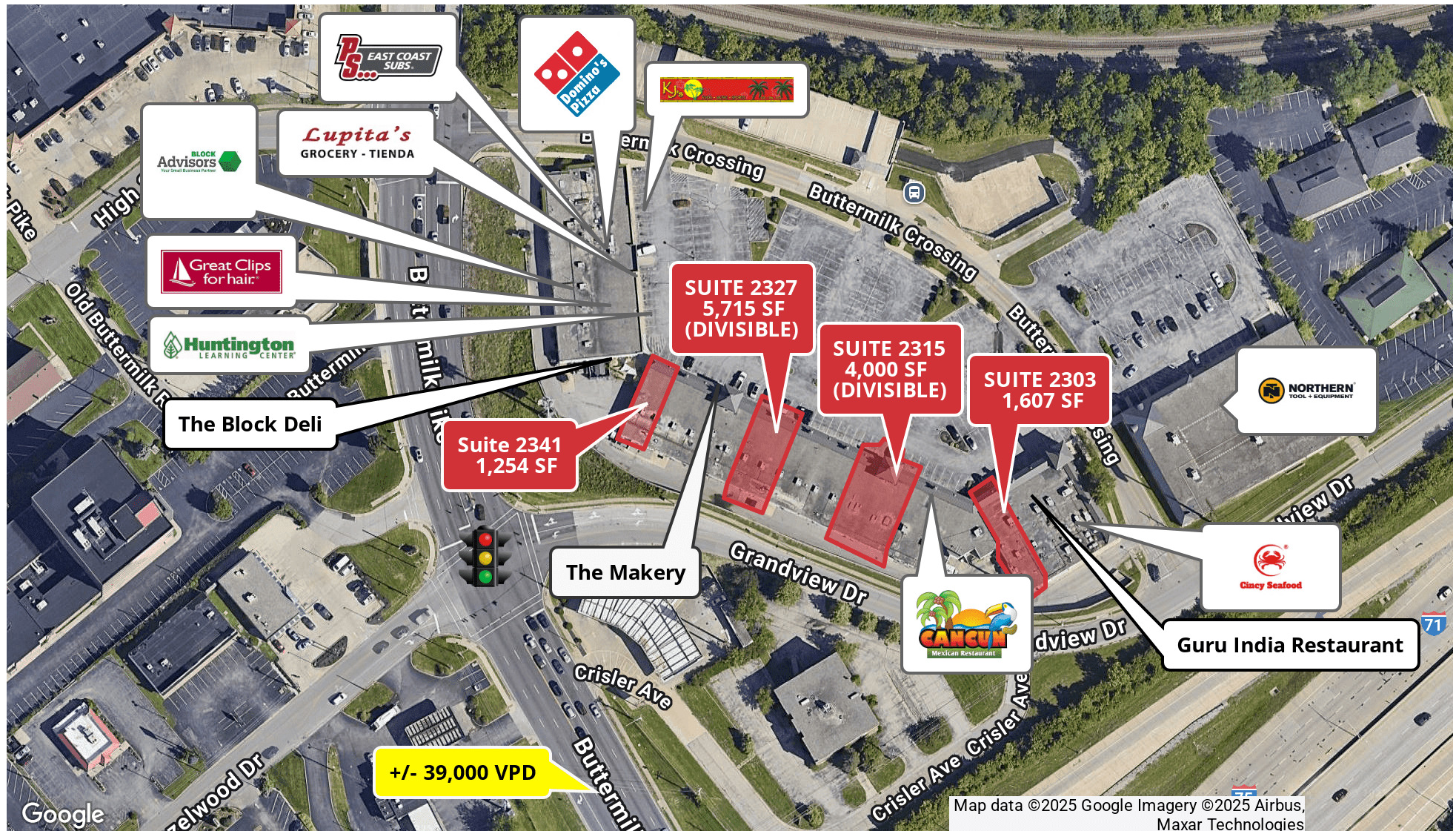

For Lease

1,254 - 4,000 SF | \$18.00 - 20.00 SF/yr

Retail Space

Available Spaces

Suite	Size (SF)	Lease Type	Lease Rate	Description
Suite 2303	1,607 SF	NNN	\$18.00 SF/yr	White box
Suite 2315	4,000 SF	NNN	\$20.00 SF/yr	Warm grey shell
Suite 2341	1,254 SF	NNN	\$20.00 SF/yr	Former dance studio

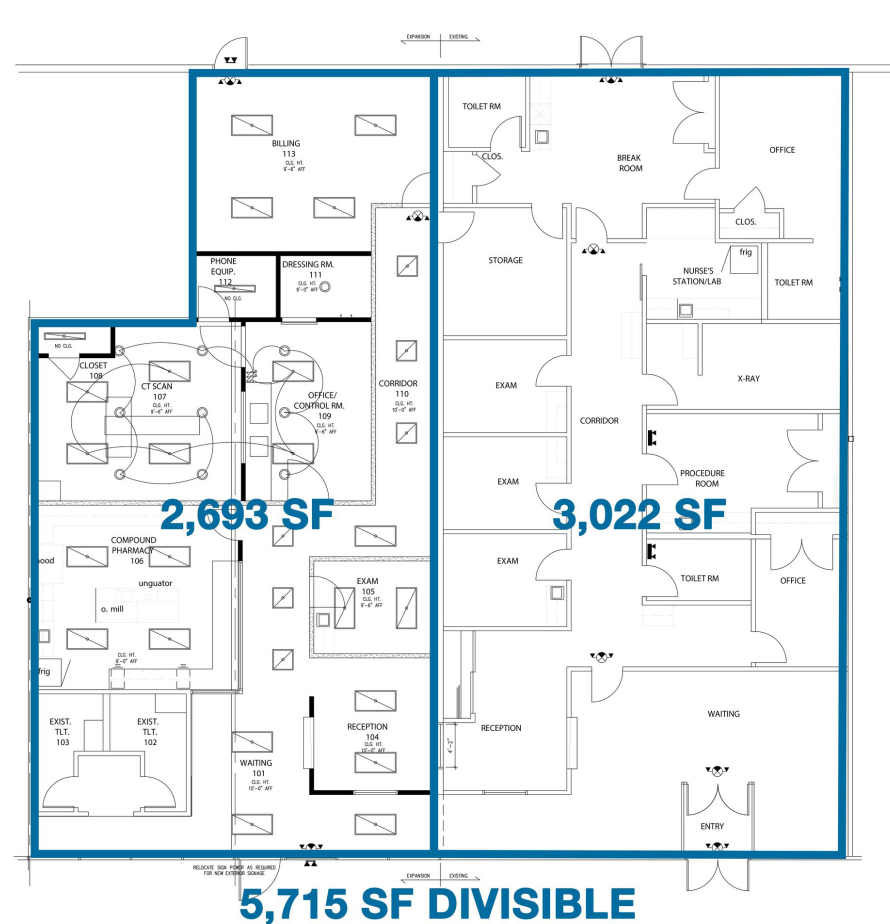

SUITE 2327

For Lease

1,254 - 4,000 SF | \$18.00 - 20.00 SF/yr

Retail Space



For Lease

1,254 - 4,000 SF | \$18.00 - 20.00 SF/yr

Retail Space



Google

For Lease

1,254 - 4,000 SF | \$18.00 - 20.00 SF/yr
Retail Space

Population	1 Mile	3 Miles	5 Miles
Total Population	10,056	56,605	202,430
Average Age	40	41	39
Average Age (Male)	39	40	38
Average Age (Female)	42	42	40
Households & Income	1 Mile	3 Miles	5 Miles
Total Households	4,273	23,590	85,878
# of Persons per HH	2.4	2.4	2.4
Average HH Income	\$114,224	\$109,063	\$86,398
Average House Value	\$405,433	\$328,310	\$265,811

Demographics data derived from AlphaMap

