



EXCLUSIVE BUILD-TO-SUIT OPPORTUNITY

# CROSSKEYS OFFICE PARK

Pittsford - Palmyra Road | Fairport New York, 14450



Click to view this property online  
and watch the drone video

Build-to-Suit location

## Advance Your Business And Energize Your Workforce At Rochester's Modern Hub for Patient Care.

CrossKeys Office Park is highly accessible and centrally located on Route 31 in Perinton's business district, only minutes from the Interstate 490 Expressway, towns of Pittsford and Fairport, and the City of Rochester. The complex is a haven for a range of successful medical practices. Nearby retail and restaurant conveniences include the Eastview Mall, Perinton Square, Wegmans Plaza and the historic Bushnell's Basin shopping district.

### Location Highlights Include:

- |  |   |   |
|--|---|---|
|  <b>Parking</b><br>Abundant on-site parking<br>and patient drop-off<br>locations             |  <b>Property</b><br>Landsaped, park-like<br>setting            |  <b>Uniland Support</b><br>24/7 property<br>management and support |
|  <b>Location</b><br>Central location in complex<br>with decades of medical<br>office history |  <b>Low Cost Utilities</b><br>Serviced by Fairport<br>Electric |   |

## Site Plan

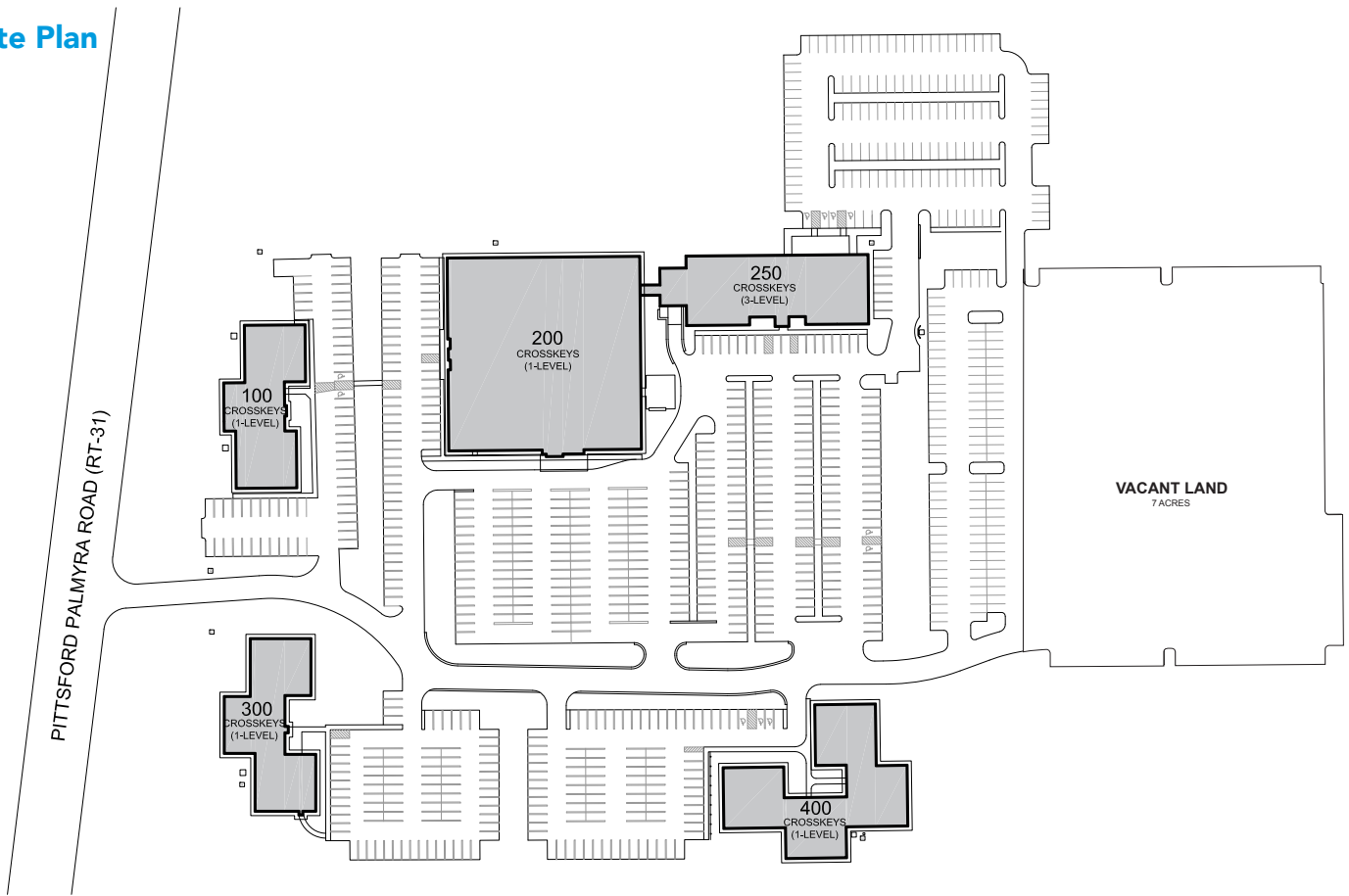

## Location Map

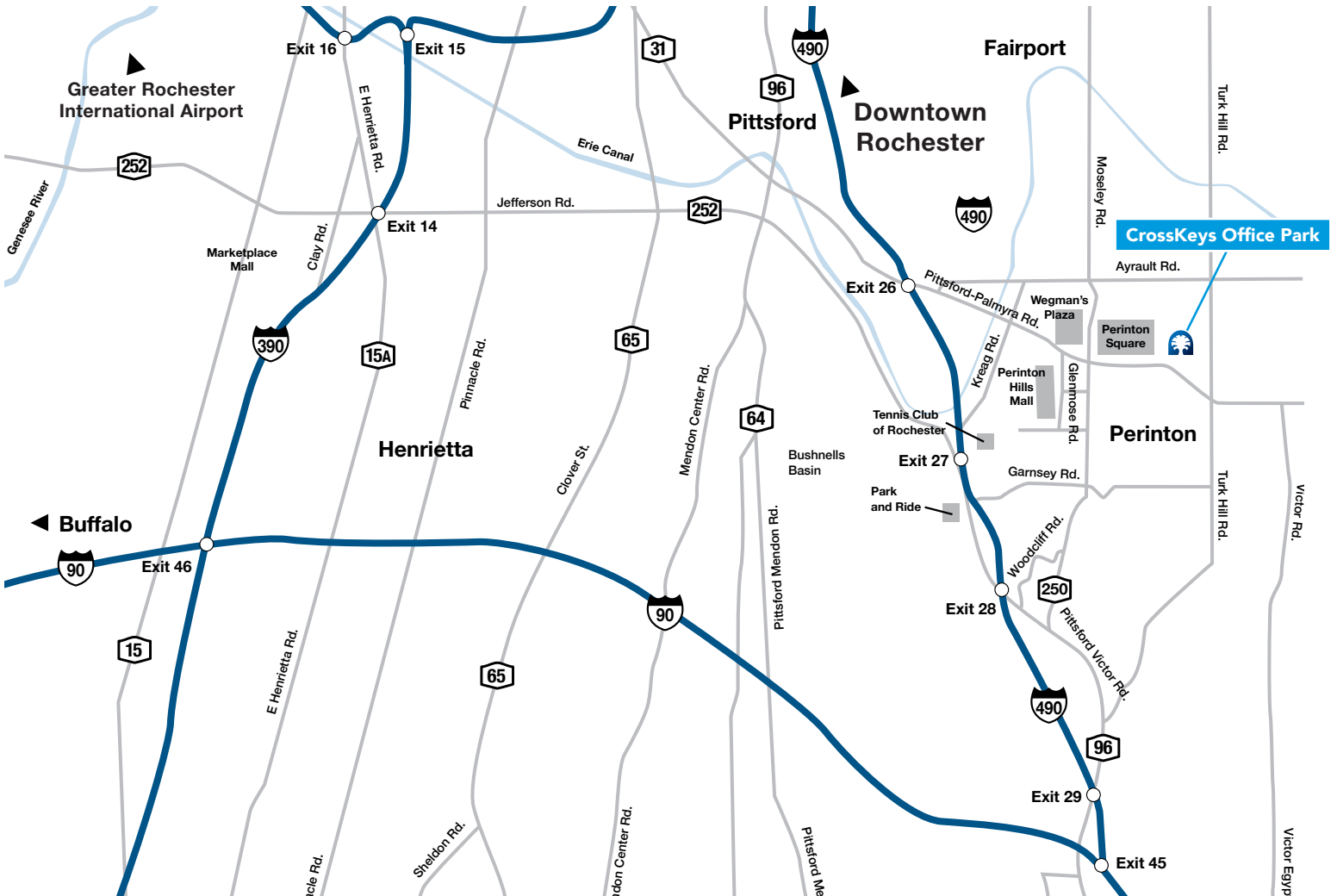



All photos are representative of Uniland medical developments.



Call For Leasing Information  
**April Sanders**  
716.272.0943 Ext. 596  
leasing@uniland.com



Scan to view this property online