

GENERAL FLOOR PLAN NOTES:

- A. PROVIDE HOOD BLOCKING IN WALLS AND PARTITIONS BEHIND ALL WALL MOUNTED APPLIANCES AS SHOWN OR SPECIFIED ON DRAWINGS.
- B. ALL HOOD BLOCKING SHOWN IN THESE DRAWINGS IS TO BE FIRE TREATED, UNLESS NOTED OTHERWISE.
- C. DIMENSIONS ARE TO FACE OF MASONRY OR TO FACE OF METAL STUDS.
- D. SINGLE WIDTH MASONRY DIMENSIONS ARE MODULAR, ALLOW FOR REDUCTION IN ACTUAL MASONRY DIMENSIONS, MAINTAINING GIVEN DIMENSIONS.
- E. VERIFY FIELD DIMENSIONS AND CONDITIONS BEFORE START OF CONSTRUCTION WORK IN AFFECTED AREA.
- F. CUTOUTS FOR MECHANICAL AND ELECTRICAL ITEMS SHALL BE ACCOMPLISHED IN SUCH MANNER THAT STANDARD ESCORTION PLATES, COVERINGS, SHALL ADEQUATELY COVER ROUGH OPENINGS. OVERSIZED OPENINGS SHALL BE REPAIRED TO MATCH ADJACENT FINISHED SURFACE BY THE CONTRACTOR RESPONSIBLE FOR THE CUTOUT WORK.
- G. CONCEAL ALL PIPING IN DRYWALL, WHERE PIPING IS TOO LARGE, WALLS ARE TO BE CUT OUT MINIMUM TO CONCEAL PIPING.
- H. DO NOT SCALE DRAWINGS, IF DIMENSIONS ARE IN QUESTION THE CONTRACTOR SHALL BE RESPONSIBLE FOR OBTAINING CLARIFICATION FROM THE OWNER'S REPRESENTATIVE BEFORE CONTINUING WITH CONSTRUCTION.
- I. PROVIDE DOUBLE STUDS AND BLOCKING WHERE REQUIRED TO SUPPORT EQUIPMENT AND/OR MISCELLANEOUS ITEMS, I.E., TYPICAL CASEWORK, CABINETS, GRAB BARS, ETC.
- J. THIS PROJECT SHALL CONTAIN A COMPLETE FIRE PROTECTION SPRINKLER SYSTEM.
- K. DRYWALL CONTROL JOINTS ARE REQUIRED ON ALL UPPER WALLS. REF. TO SPECS FOR LENGTH AND FREQUENCY.
- L. EXIST. MATERIAL MAY BE REUSED WHERE PRACTICAL, ONLY IF PRIOR APPROVAL IS OBTAINED FROM THE BUILDING OWNER.
- M. DISPOSAL OF ALL MATERIAL REMOVED AND NOT REUSED AS PER THE BUILDING OWNER. SEE NOTES ON DEMOLITION PLAN.
- N. EXIST. CONDITIONS NOT SHOWN ON THIS PLAN SHALL BE REMOVED OR ABANDONED AS FIELD CONDITIONS WARRANT.
- O. MAX. CLEAR SPAN HEIGHTS FOR INT. METAL STUDS SHALL BE SUCH THAT DEFLECTION SHALL NOT EXCEED L/360 UNDER A PSF LOAD (CERAMIC TILE FINISHES) AND L/200 AT ALL OTHER AREAS.
- P. REFER TO DEMOLITION PLAN FOR EXISTING CONDITIONS.
- Q. ALL DIMENSIONS SHOWN ON THIS PLAN THAT ARE FROM INTERIOR PARTITIONS WHERE THE RETURN AIR SHUNT IS INDICATED ARE TAKEN FROM THE SAID AREA SIDE OF PARTITION, NOT FROM THE RETURN AIR SHUNT PARTITION.
- R. PARTITIONS WITH RECESSED EQUIPMENT (ELEG. PANELS, FLY GRID, ETC.) OR PLUMB. FIXTURES SHALL BE 1" MIN.

KEYED FLOOR PLAN NOTES:

1. PROVIDE WATER RESISTANT GYPS. BD. ON WALLS BEHIND AND ADJACENT TO PLUMBING FIXTURES. - PREP AND PAINT.
2. EXISTING LIFT-OFF GUARD RAIL TO REMAIN. MODIFY EXISTING 36" HIGH GUARD RAIL TO RAISE THE TOP OF THE RAILING TO 42" MIN. ABOVE FINISH FLOOR ELEVATION - SEE DETAIL A/A802. GRIND NEW WELDS SMOOTH, PREP AND PAINT.
3. EXISTING STEEL COLUMN TO REMAIN.
4. EXISTING SPRINKLER VALVE AND RISER LOCATION.
5. NEW HOLLOW METAL WINDOW & FIXED GLASS FROM 3'-6" AFF. TO 7'-0" AFF.
6. EXISTING ROOF DOWNPOUT TO REMAIN.
7. NEW 1" THICK CONCRETE RAMP SLAB ON WASHED CRUSHED STONE BACKFILL. REFERENCE STRUCTURAL DETAILS.
8. EXTEND METAL STUD WALLS AROUND THE OFFICE TO STRUCTURE ABOVE. EXTEND GYPS. BD. ON STORAGE SIDE TO STRUCTURE ABOVE AND OFFICE SIDE TO 6" ABOVE CEILING.
9. NEW WATER HEATER ON PLATFORM ABOVE CLOSET - REFERENCE PLUMBING DRAWINGS.
10. RELOCATE EXISTING SUSPENDED GAS HEATER UNIT AND RE-CONNECT UNIT TO EXISTING GAS LINE, ELECTRICAL LINE AND FUEL PACT. REFERENCE MECHANICAL AND ELECTRICAL DRAWINGS.
11. PROVIDE ROUGH OPENING IN HALL OPENING FOR FUTURE 3'-0" W x 6'-0" H DOOR AND FRAME. (2) LOCATIONS.
12. PROVIDE NEW 1 1/2" O.D. STEEL TOP RAIL, AS REQUIRED TO RAISE THE EXISTING GUARD RAIL TO 42" MIN. ABOVE FINISH FLOOR ELEVATION. PROVIDE NEW 1 1/2" O.D. STEEL STUD POST AT ALL EXISTING POST LOCATIONS. PROVIDE NEW 1 1/2" O.D. STEEL BOTTOM RAIL. FULLY WELD NEW STEEL POSTS TO EXISTING RAILING. GRIND SMOOTH, PREP AND PAINT. REFERENCE DETAIL B/A802.
13. PER EXISTING WALL WITH 1/2" GYPS. BD. (1/2" WATER RESISTANT GYPS. BD. WHERE REQUIRED) OVER 3 5/8" METAL STUDS @ 24" O.C. EXTEND GYPS. BD. AND STUDS 6" ABOVE CEILING HEIGHT. PROVIDE 4" BATT. INSULATION IN STUD CAVITIES.
14. NEW VAN ACCESSIBLE HANDICAP PARKING WITH HANDICAP PARKING SIGN AND WHEEL STOP - REFERENCE HANDICAP PARKING AND SIGN DETAILS THIS SHEET.
15. EXTEND NEW METAL STUD AND GYPS. BD. (BOTH SIDES) WALLS AROUND THE SECURED STORAGE ROOMS TO STRUCTURE ABOVE.
16. NEW 3'-0" X 4'-0" PRE-FAB SHOWER UNIT.

PARTITION LEGEND:

- TYPICAL INTERIOR WALLS TO BE 1/2" GYPS. BD. ON EACH SIDE OF 3 5/8" METAL STUDS AT 24" O.C. ANCHOR METAL STUDS TO STRUCTURE ABOVE AS REQUIRED. PROVIDE 3/4" FIRE-RETARDANT PLYWOOD WHERE NOTED.
- INTERIOR/EXTERIOR WALLS WITH 6" METAL STUDS AT 24" O.C. ANCHOR STUDS TO STRUCTURE ABOVE AS REQUIRED. SEE FINISH SCHEDULE A203 FOR WALL FINISHES.
- EXISTING MASONRY WALL, VERIFY SIZE AND HEIGHT IN FIELD.

SYMBOL LEGEND:

- DOOR SYMBOL, SEE SHEET A203 FOR DOOR SCHEDULE.
- WINDOW SYMBOL, SEE SHEET A203 FOR WINDOW TYPES AND ELEVATIONS.

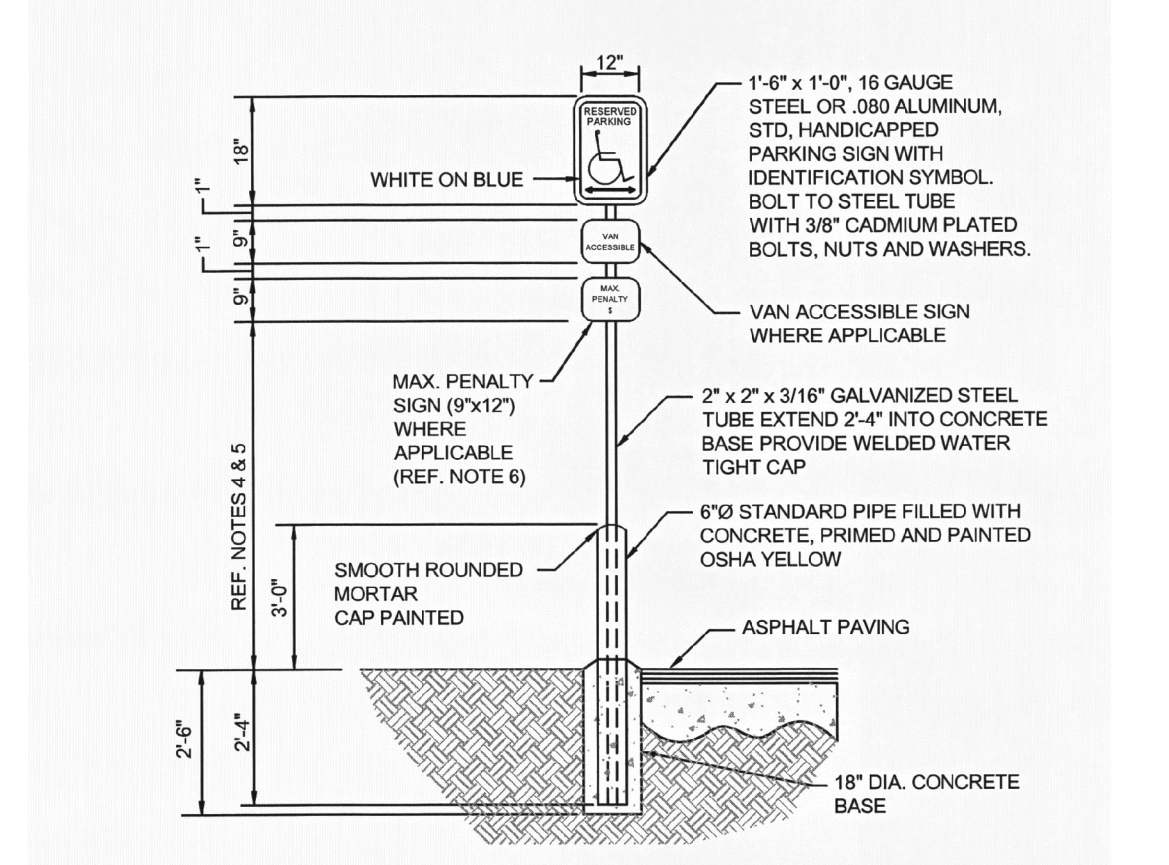

- NOTES:**
1. SIGNAGE SHALL COMPLY WITH AMERICANS WITH DISABILITIES ACT (A.D.A.) SIGNAGE GUIDELINES.
 2. HC SIGN AND POST BY CONTRACTOR.
 3. SEE SITE PLAN TO DETERMINE IF SIGN IS TO BE INSTALLED IN A PAVEMENT SECTION OR EARTH.
 4. HANDICAP PARKING SIGNS SHALL BE A MINIMUM OF 60 INCHES ABOVE GRADE TO THE BOTTOM OF THE SIGN WHERE NO PEDESTRIAN TRAFFIC IS POSSIBLE, SUCH AS AGAINST BUILDINGS OR IN LANDSCAPED AREAS BEHIND SIDEWALKS.
 5. HANDICAP PARKING SIGNS SHALL BE A MINIMUM OF 84 INCHES ABOVE GRADE TO THE BOTTOM OF THE SIGN WHERE PEDESTRIAN TRAFFIC IS POSSIBLE.
 6. PROVIDE A "MAXIMUM PENALTY" SIGN IF REQUIRED BY LOCAL JURISDICTION. SIGN SHALL CONFORM TO LOCAL AUTHORITIES FOR PENALTY AMOUNT AND WORDING.
 7. PROVIDE A "VAN ACCESSIBLE" SIGN WHEN ADJACENT ACCESSIBLE IS 8'-0" IN WIDTH.

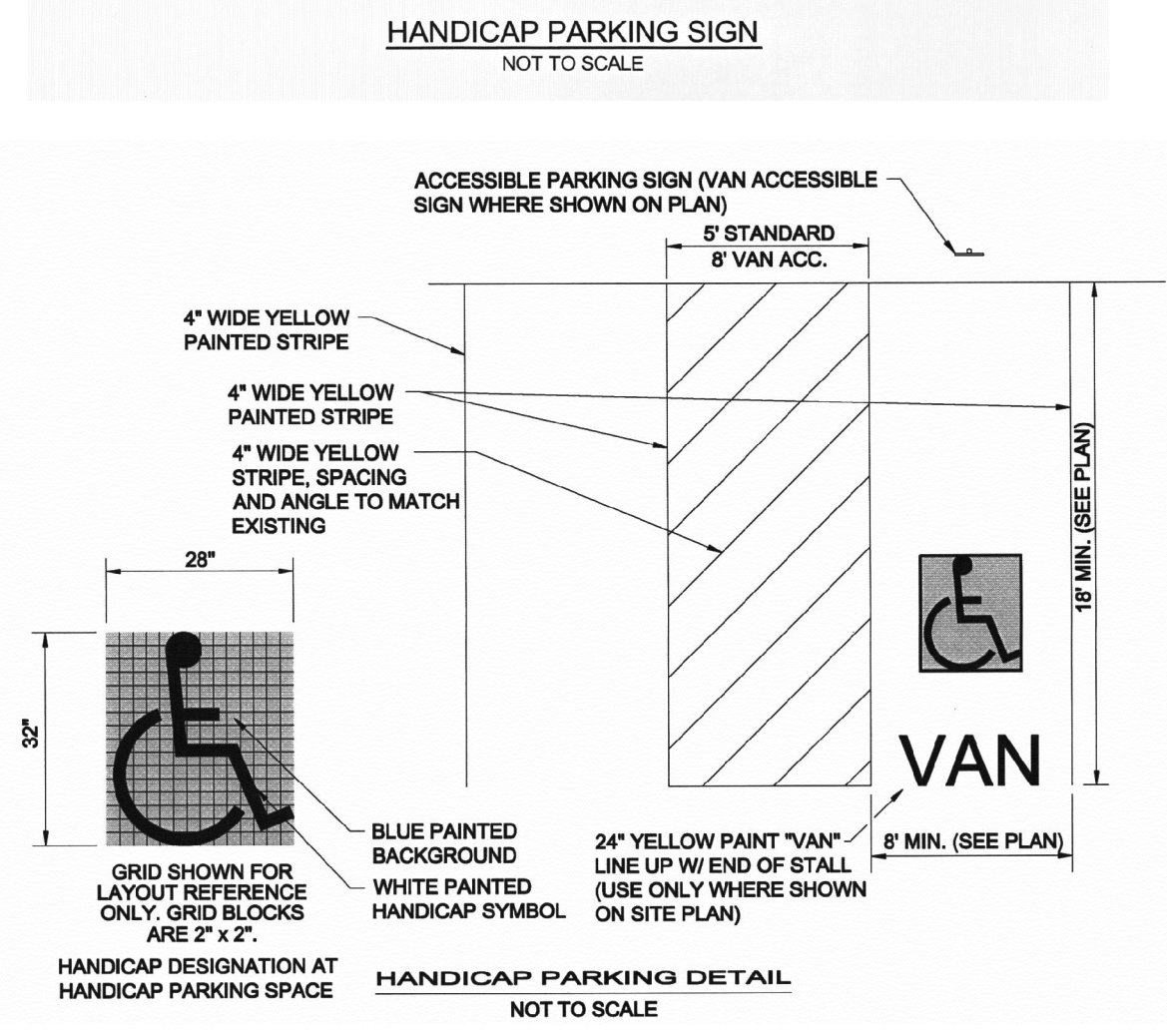

FLOOR COVERING LEGEND:

- (CEN) EXISTING CONCRETE FLOOR FINISH TO REMAIN - CLEAN
- (CNC) NEW CARPET - COLOR & PATTERN TO BE SELECTED BY OWNER
- (CVN) NEW VINYL COMPOSITION TILE - COLOR & PATTERN TO BE SELECTED BY OWNER

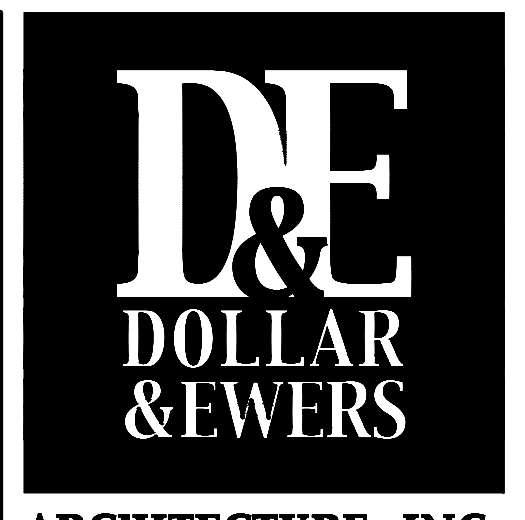
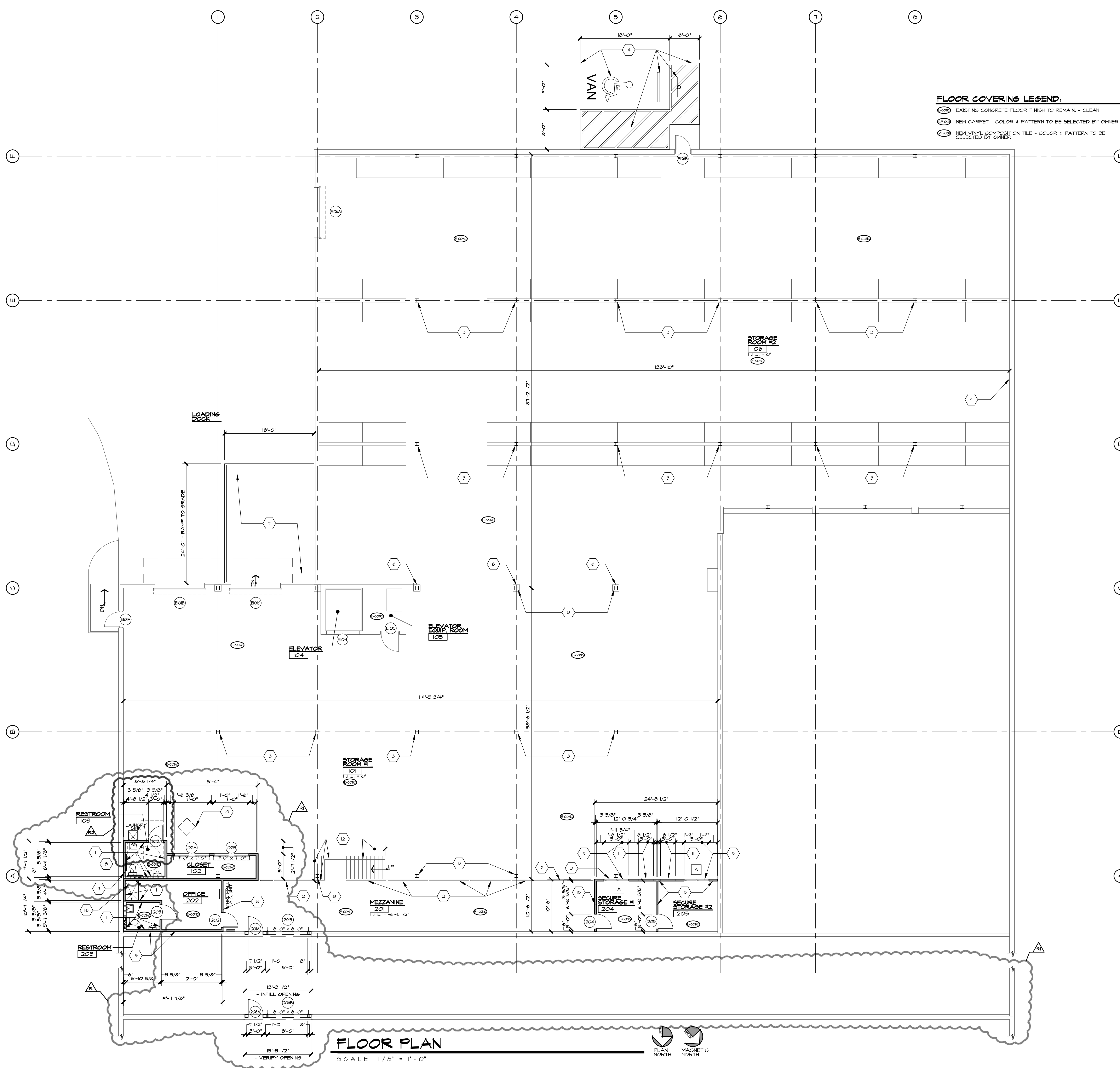

1910 Aitor Avenue • Suite "B"
Knoxville, Tennessee • 37921
phone: 865-546-8374 • fax: 865-673-8028
e-mail: design@dollar-fewers.com



NO.	REVISIONS
1	REVISION NO. 1 - APRIL 11, 2014
2	REVISION NO. 2 - MAY 2, 2014

A Facility Renovation for:
JOHN H. DANIEL COMPANY - PHASE I
 1803 N. CENTRAL STREET, KNOXVILLE, TN 37917
FLOOR PLAN, NOTES & LEGEND

COPYRIGHT
 ALL DRAWING SPECIFICATIONS AND CONTENTS HEREBY PUBLISHED BY DOLLAR & FEWERS ARCHITECTURE, INC. ARE AND SHALL REMAIN THE PROPERTY OF DOLLAR & FEWERS ARCHITECTURE, INC. NO PART OF THIS PROJECT, WITH THE EXCEPTION OF THE CONTRACT SET, PRODUCT AND ARE NOT TO BE USED IN ANY OTHER PROJECT WITHOUT THE WRITTEN PERMISSION OF DOLLAR & FEWERS ARCHITECTURE, INC. FOR EACH PARTY TO THE CONTRACT, SUCH DOCUMENTS ARE TO BE RETURNED TO DOLLAR & FEWERS ARCHITECTURE, INC. UPON COMPLETION OF THE PROJECT. NO PART OF THIS PROJECT IS TO BE REPRODUCED OR TRANSMITTED IN ANY FORM OR BY ANY MEANS, ELECTRONIC OR MECHANICAL, INCLUDING PHOTOCOPYING, RECORDING, OR BY ANY INFORMATION STORAGE AND RETRIEVAL SYSTEM, WITHOUT THE WRITTEN PERMISSION OF DOLLAR & FEWERS ARCHITECTURE, INC. THIS PROJECT IS THE PROPERTY OF DOLLAR & FEWERS ARCHITECTURE, INC. AND IS NOT TO BE REPRODUCED OR TRANSMITTED IN ANY FORM OR BY ANY MEANS, ELECTRONIC OR MECHANICAL, INCLUDING PHOTOCOPYING, RECORDING, OR BY ANY INFORMATION STORAGE AND RETRIEVAL SYSTEM, WITHOUT THE WRITTEN PERMISSION OF DOLLAR & FEWERS ARCHITECTURE, INC. THIS PROJECT IS THE PROPERTY OF DOLLAR & FEWERS ARCHITECTURE, INC. AND IS NOT TO BE REPRODUCED OR TRANSMITTED IN ANY FORM OR BY ANY MEANS, ELECTRONIC OR MECHANICAL, INCLUDING PHOTOCOPYING, RECORDING, OR BY ANY INFORMATION STORAGE AND RETRIEVAL SYSTEM, WITHOUT THE WRITTEN PERMISSION OF DOLLAR & FEWERS ARCHITECTURE, INC.

ISSUE DATE: MARCH 14, 2014
 PROJECT NO.: 214108
 SHEET NUMBER: **A201**