

14.82 ACRES - ROUND ROCK

3401 Greenlawn Blvd
Round Rock, TX 78664

**NEC GREENLAWN BLVD &
PFLUGERVILLE PKWY
TEXAS 78664**



Location: NEC of Greenlawn Blvd & Pflugerville Pkwy, Round Rock, Texas 78664

Directly South of Idea Charter School, less than 1 mile from Dell Campus, Target, Walmart, HEB and La Fronterra shops, offices, hotels and restaurants.

Size: 14.82 Acres total, will consider subdividing

Zoning : PUD Agreement with the City of Round Rock to be amended.

Utilities: Water - City of Round Rock
Wastewater - Windemere, IDEA
Water & Wastewater are located on the east side of the tract.

Price: Contact Agent

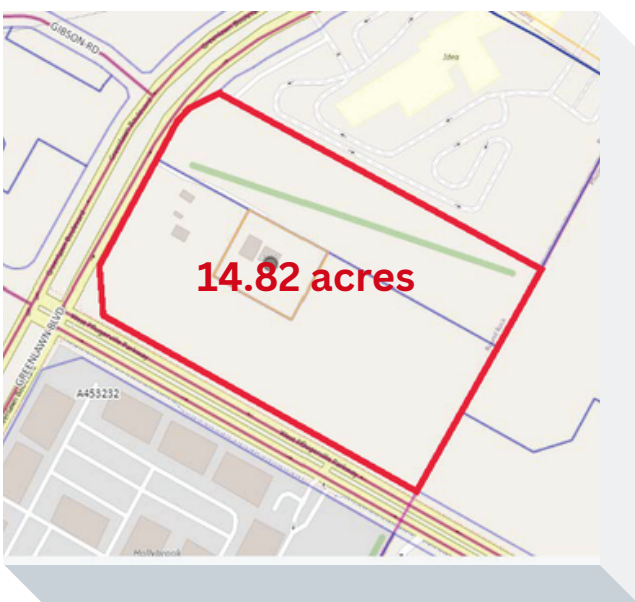

Gail M. Whitfield,
O: 512.476.9900 | C: 512.422.4556
gail@thewhitfieldco.com

Marcus J. Whitfield
512.656.1622
marcus@thewhitfieldco.com

THE
WHITFIELD
COMPANY

14.82 ACRES - ROUND ROCK

3401 Greenlawn Blvd
Round Rock, TX 78664

Concept Plan - NOT CITY OF RR APPROVED



Concept Plan - NOT CITY OF RR APPROVED



Gail M. Whitfield,
O: 512.476.9900 | C: 512.422.4556
gail@thewhitfieldco.com

Marcus J. Whitfield
512.656.1622
marcus@thewhitfieldco.com

THE
WHITFIELD
COMPANY