

ALOHA TOWER MARKETPLACE

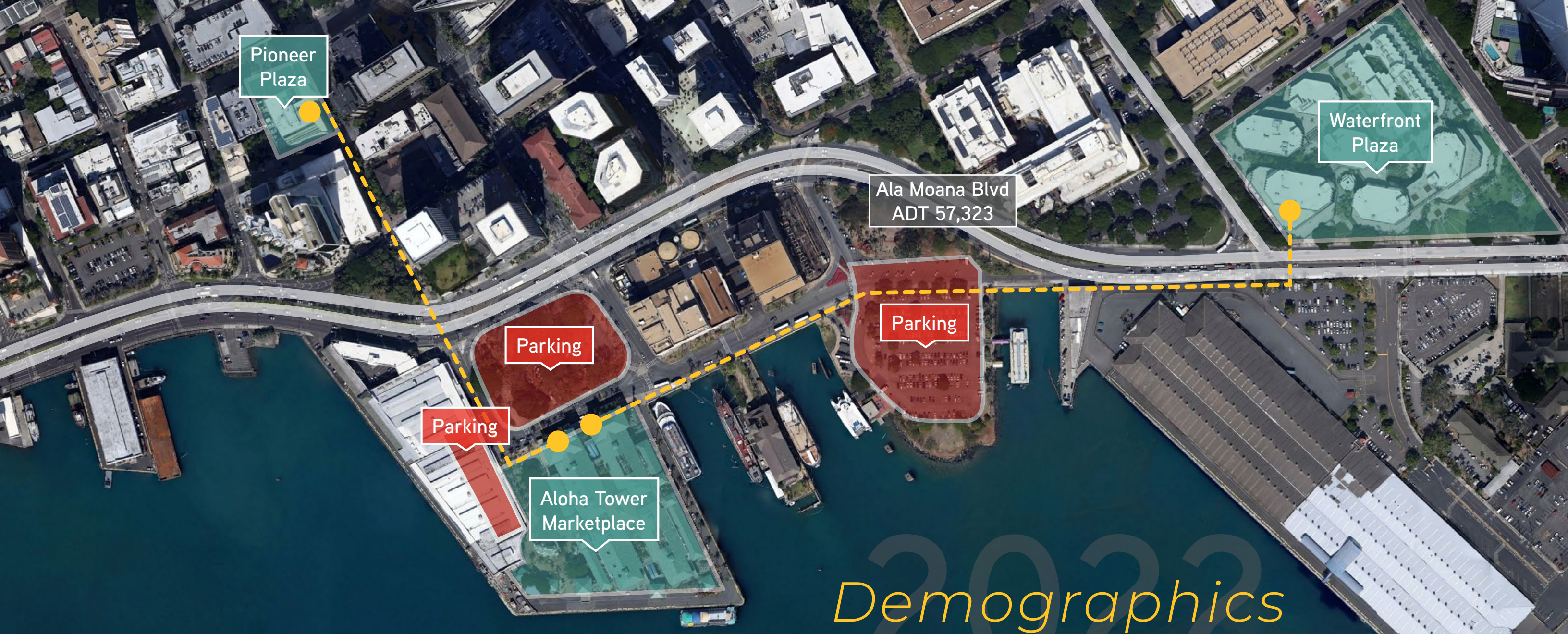

Colliers



Demographics

Aloha Tower Marketplace is an iconic Hawaii landmark that sits along the Honolulu Harbor. Comprised of four main buildings, this mixed-use residential and commercial center is the new home of the world class Hawaii Pacific University. Parking at the historic center is over 700 vehicles and offers other convenient services like valet parking, TheCab, Biki, and Carshare programs.

Centrally located in Honolulu’s urban core, Aloha Tower Marketplace is the new gathering place for business, education and culture.

	1-Mile	3-Mile	5- Mile
Estimated Population	36,140	207,401	332,929
Estimated Households	16,967	84,362	131,238
Estimated Average Household Income	\$91,863	\$101,972	\$107,944
Daytime Demographics			
Total Employees	83,405	201,283	283,062
Total Residents	18,861	103,956	168,518

ALOHA TOWER SITE MAP

GROUND FLOOR

- RETAIL
- COMMUNITY USE
- HPU SPACES
- AVAILABLE

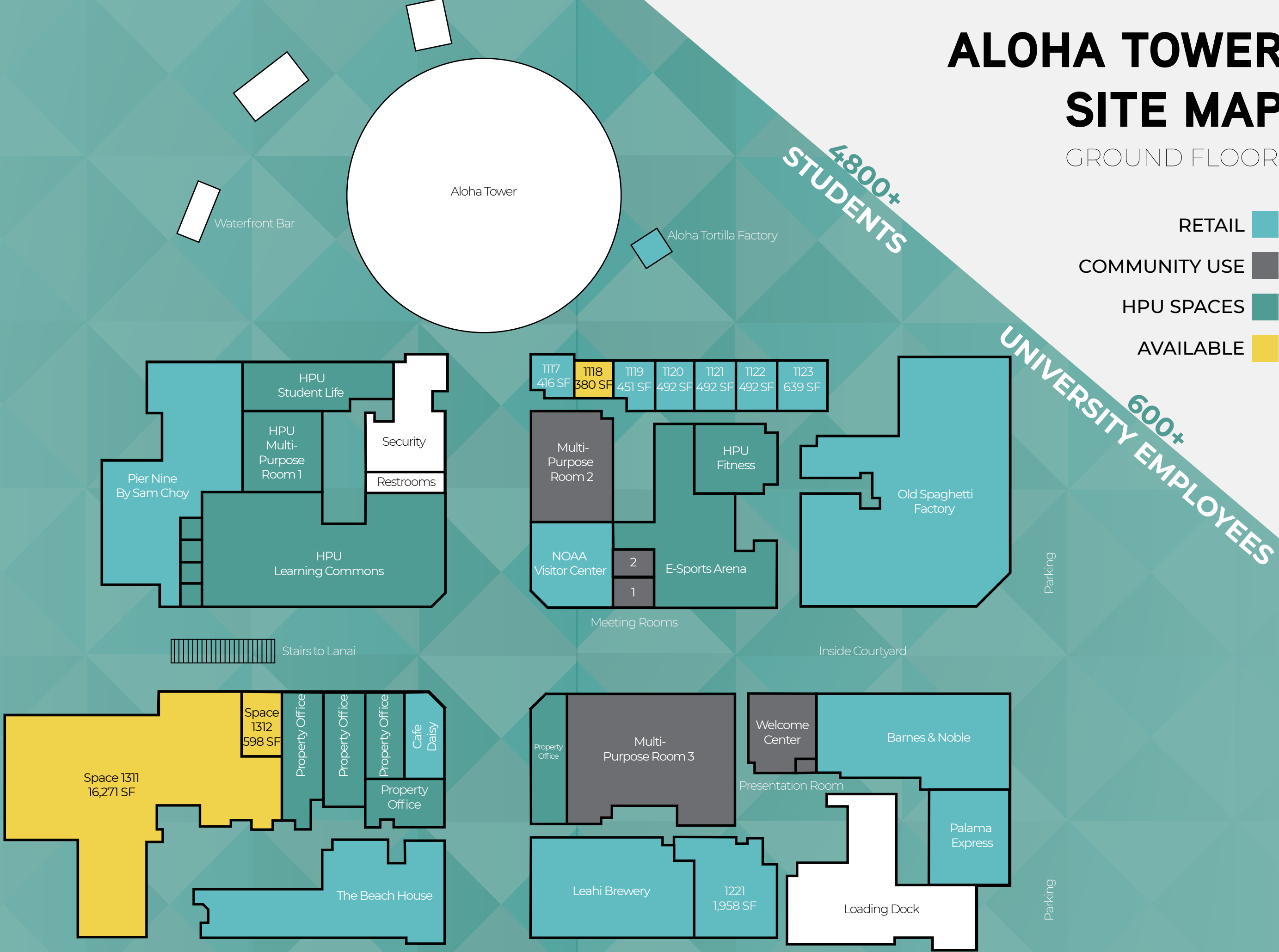



Property Highlights

- Area: Downtown
- Size Available: 1118 380 SF
1311 16,271 SF
1312 598 SF
- Building Size: 166,000 SF
- Base Rent: Negotiable
- Term: 3-5 years
- Features & Benefits:
- > Prime location within Downtown Honolulu and minutes from Waikiki
 - > Flexible floor plans
 - > Ample parking for customers
 - > Anchored by Old Spaghetti Factory
 - > Over 950 University employees and residents





Contact Us

EMALIA PIETSCH (S)

LIC# RS-70893

Retail Services Division

808.523.9710

emalia.pietsch@colliers.com

JANNA FRASH (S)

LIC# RS-80222

Office Services Division

808.230.3794

janna.frash@colliers.com