

# FOR LEASE

Anne Arundel County, MD



## INDUSTRIAL PROPERTY

8223-8225 BALTIMORE  
ANNAPOLIS BOULEVARD  
PASADENA, MD 21122

# FOR LEASE

Anne Arundel County, MD

# INDUSTRIAL PROPERTY

8223-8225 BALTIMORE ANNAPOLIS BOULEVARD | PASADENA, MARYLAND 21122

## AVAILABLE

21,413 sf ± on 3.43 Ac ±

- ▶ 8223: 12,789 sf ± on 1.97 Ac ±
- ▶ 8225: 8,624 sf ± on 1.46 Ac ±

## ZONING

C4 (Commercial - Highway)

## LOADING

- ▶ 8223: Two (2) drive-ins
- ▶ 8225: Five (5) drive-ins

## HIGHLIGHTS

- ▶ Large 3.35 acre property (superior for outside storage)
- ▶ Fully paved and/or graveled
- ▶ Office and warehouse structures in good condition
- ▶ Easy access to Route 100, Route 2/Ritchie Hwy and I-97
- ▶ Ideal for light industrial user with need for outside storage of materials or vehicles, etc.

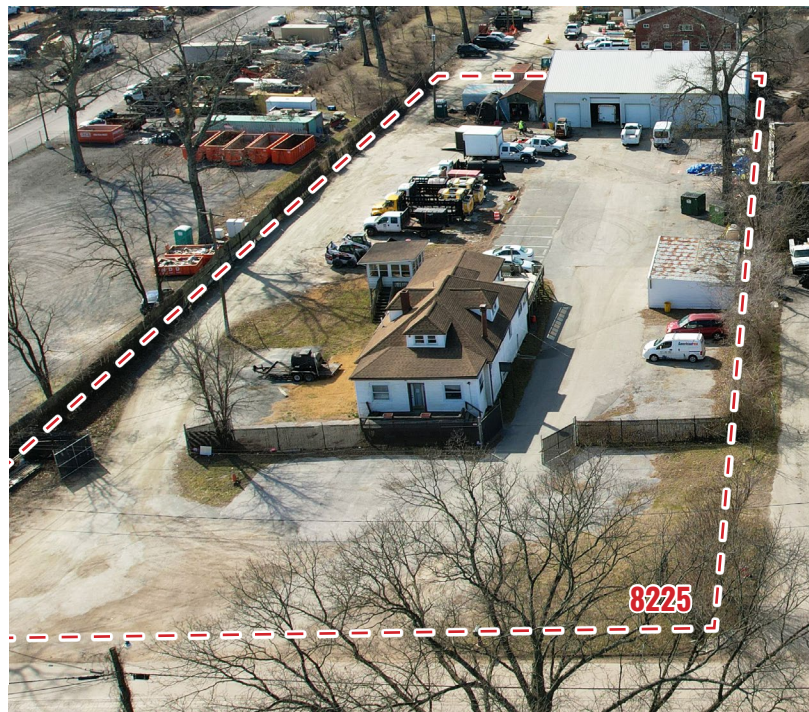

**Matthew Curran, SIOR**

☎ 443.573.3203  
✉ mcurran@mackenziecommercial.com

**Andrew Meeder, SIOR**

☎ 410.494.4881  
✉ ameede@mackenziecommercial.com

**Daniel Hudak, SIOR**

☎ 443.573.3205  
✉ dhudak@mackenziecommercial.com

# FOR LEASE



Anne Arundel County, MD

# AERIAL

8223-8225 BALTIMORE ANNAPOLIS BOULEVARD | PASADENA, MARYLAND 21122



**Matthew Curran, SIOR**

☎ 443.573.3203

✉ [mcurran@mackenziecommercial.com](mailto:mcurran@mackenziecommercial.com)

**Andrew Meeder, SIOR**

☎ 410.494.4881

✉ [ameeder@mackenziecommercial.com](mailto:ameeder@mackenziecommercial.com)

**Daniel Hudak, SIOR**

☎ 443.573.3205

✉ [dhudak@mackenziecommercial.com](mailto:dhudak@mackenziecommercial.com)

MacKenzie Commercial Real Estate Services, LLC • 443-573-3200 • 111 S. Calvert Street, Suite 2800 | Baltimore, Maryland 21202 • [www.MACKENZIECOMMERCIAL.com](http://www.MACKENZIECOMMERCIAL.com)

# FOR LEASE

Anne Arundel County, MD

# LOCAL BIRDSEYE

8223-8225 BALTIMORE ANNAPOLIS BOULEVARD | PASADENA, MARYLAND 21122



# FOR LEASE

Anne Arundel County, MD

# INDUSTRIAL TRADE AREA

8223-8225 BALTIMORE ANNAPOLIS BOULEVARD | PASADENA, MARYLAND 21122





# FOR LEASE

Anne Arundel County, MD

# LOCATION

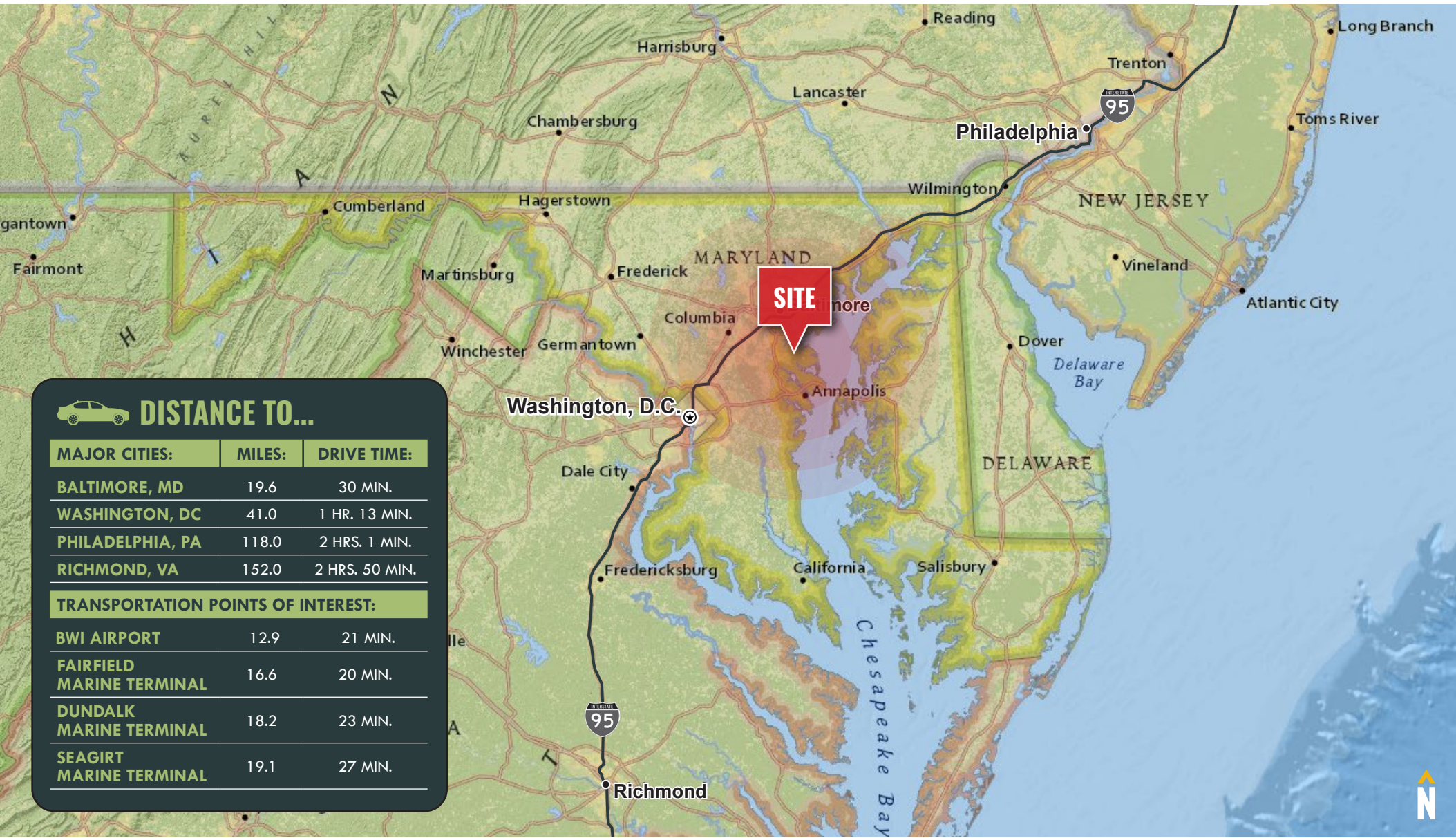
8223-8225 BALTIMORE ANNAPOLIS BOULEVARD | PASADENA, MARYLAND 21122



 **DISTANCE TO...**

MAJOR CITIES:	MILES:	DRIVE TIME:
BALTIMORE, MD	19.6	30 MIN.
WASHINGTON, DC	41.0	1 HR. 13 MIN.
PHILADELPHIA, PA	118.0	2 HRS. 1 MIN.
RICHMOND, VA	152.0	2 HRS. 50 MIN.

**TRANSPORTATION POINTS OF INTEREST:**

BWI AIRPORT	12.9	21 MIN.
FAIRFIELD MARINE TERMINAL	16.6	20 MIN.
DUNDALK MARINE TERMINAL	18.2	23 MIN.
SEAGIRT MARINE TERMINAL	19.1	27 MIN.

**Matthew Curran, SIOR**

443.573.3203  
mcurran@mackenziecommercial.com

MacKenzie Commercial Real Estate Services, LLC • 443-573-3200 • 111 S. Calvert Street, Suite 2800 | Baltimore, Maryland 21202 • www.MACKENZIECOMMERCIAL.com

**Andrew Meeder, SIOR**

410.494.4881  
ameeder@mackenziecommercial.com

**Daniel Hudak, SIOR**

443.573.3205  
dhudak@mackenziecommercial.com



**MATTHEW CURRAN, SIOR**

SENIOR VICE PRESIDENT & PRINCIPAL

MACKENZIE COMMERCIAL REAL ESTATE SERVICES, LLC

443.573.3203

MCURRAN@MACKENZIECOMMERCIAL.COM

**ANDREW MEEDER, SIOR**

SENIOR VICE PRESIDENT & PRINCIPAL

MACKENZIE COMMERCIAL REAL ESTATE SERVICES, LLC

410.494.4881

AMEEDER@MACKENZIECOMMERCIAL.COM

**DANIEL HUDAK, SIOR**

SENIOR VICE PRESIDENT & PRINCIPAL

MACKENZIE COMMERCIAL REAL ESTATE SERVICES, LLC

443.573.3205

DHUDAK@MACKENZIECOMMERCIAL.COM

MacKenzie Commercial Real Estate Services, LLC • 410-821-8585 • 111 S. Calvert Street | Baltimore, Maryland 21202 • [www.MACKENZIECOMMERCIAL.com](http://www.MACKENZIECOMMERCIAL.com)

No warranty or representation, expressed or implied, is made as to the accuracy of the information contained herein, and same is submitted subject to errors, omissions, change of price, rental or other conditions, withdrawal without notice, and to any specific listing conditions imposed by our principals.