

Move-in Ready Midtown Office Space Available

One Midtown Plaza, 1360 Peachtree St,
Suite 900, Atlanta, GA 30309



CARTER HILL



SPACE PROFILE

Negotiable

Rental Rate

2,624 SF

Total SF

April 30, 2026

Term

FOR SUBLEASE

Building Highlights:

- Fitness Center Conference
- Center Onsite Café - Metro Fresh
- Bank / ATM 24-Hour
- Security and card access
- EV charging stations
- Access to I-75/85 and MARTA



Floorplan | Suite 900 | 9th Floor | 2,624 SF

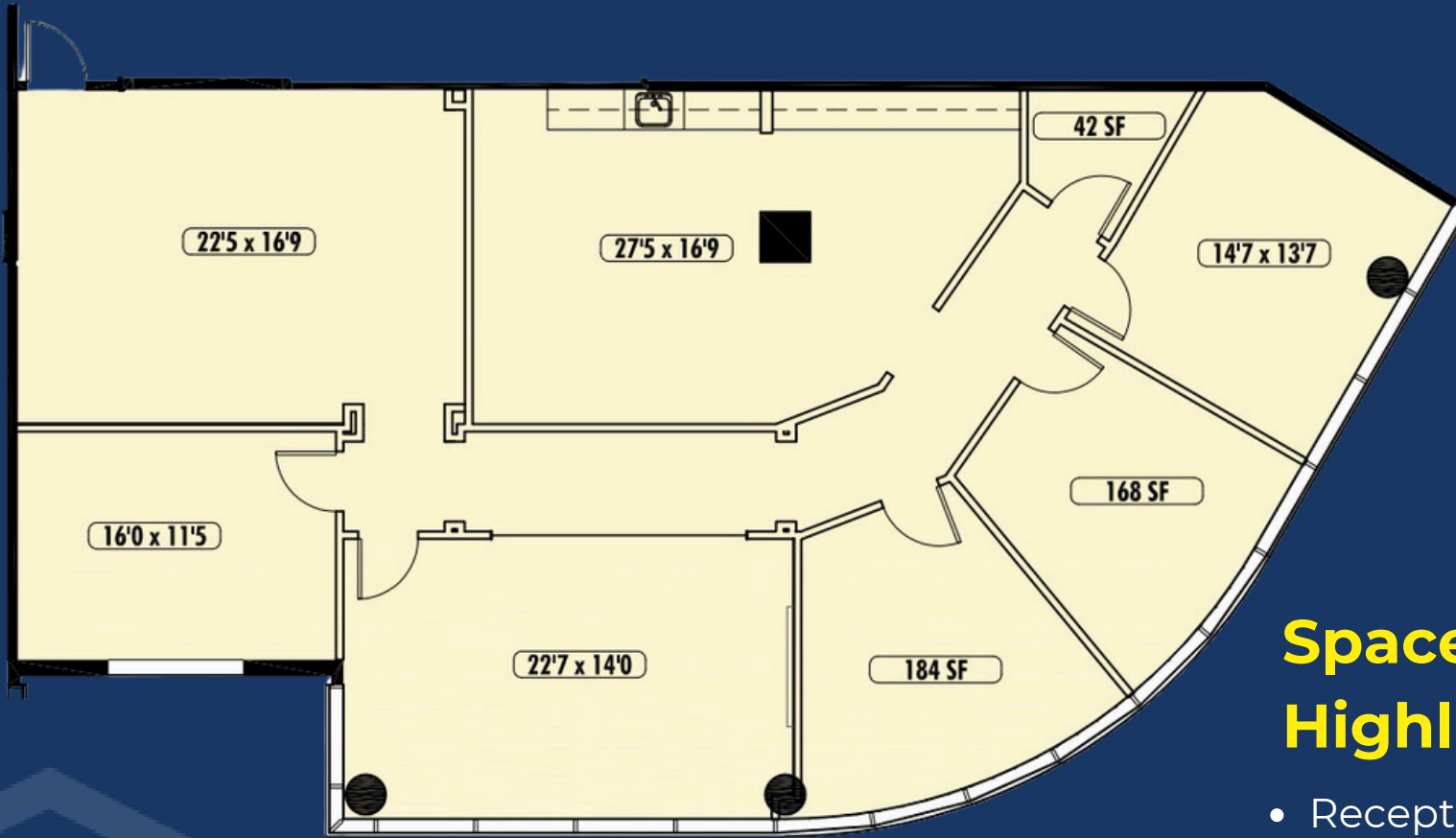

Space Highlights:

- Reception Area
- 4 private offices
- Conference room
- Large Breakroom
- Plenty of Natural Light



Conveniently Located Near:

- Colony Square
- Arts Center Marta Station
- High Museum of Art

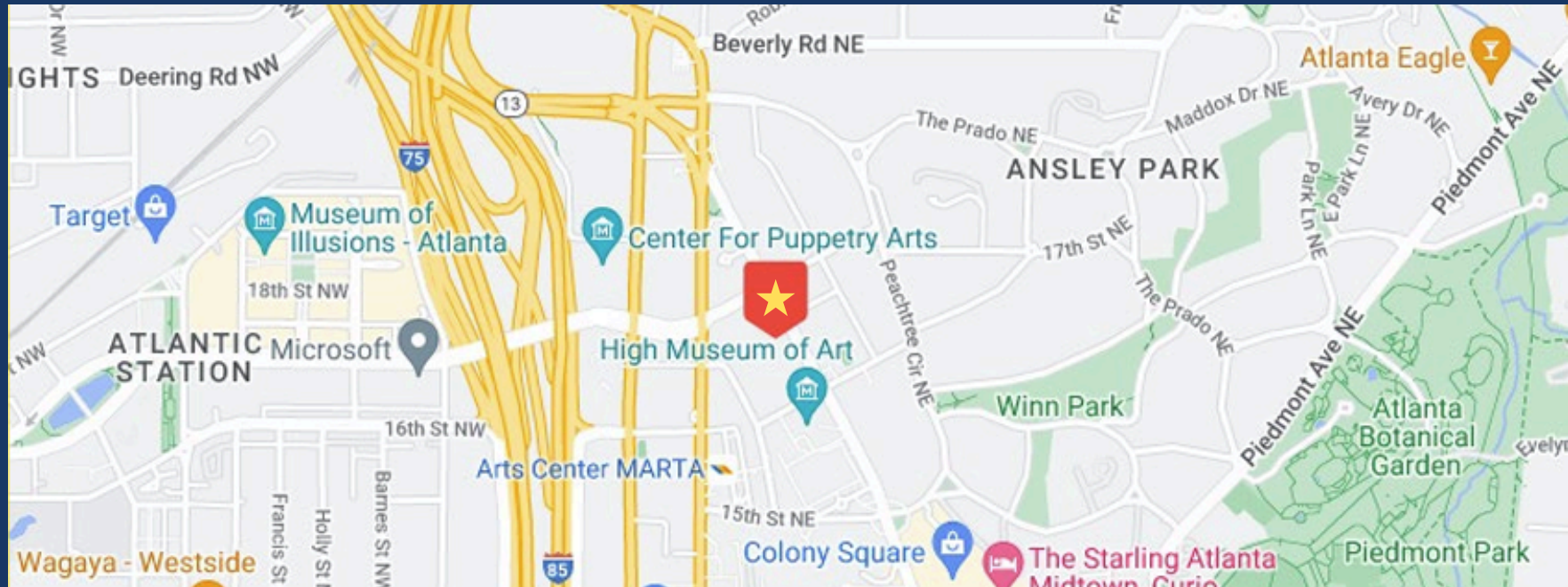

Tony Terrell
Senior Advisor
+1 470 717 4518
Tony@carterhilladvisors.com

Dylan Colter
Advisor
+1 678 899 0168
dylan@carterhilladvisors.com

The information contained in this communication has been obtained from a variety of sources believed to be reliable but has not been verified. NO WARRANTY OR REPRESENTATION, EXPRESS OR IMPLIED, IS MADE AS TO THE CONDITION OF THE PROPERTY OR ACCURACY OR COMPLETENESS OF THE INFORMATION CONTAINED HEREIN AND SAME IS SUBMITTED SUBJECT TO ERRORS OMISSIONS, CHANGE OF PRICE, RENTAL OR OTHER CONDITIONS, WITHDRAWAL WITHOUT NOTICE AND TO ANY SPECIFIC CONDITIONS IMPOSED BY THE PROPERTY OWNER OR LESSOR.