



**F.C. Tucker
Commercial**

AVAILABLE

1800 Lynch Road
EVANSVILLE, IN 47711



- **Lease Price:** \$4.95 / NNN
- **Available SF:** 51,398 SF
 - Warehouse SF: 48,282 SF
 - Office SF: 3,116 SF
- **Lot Size:** 7.254 Acres +/-
- **Year Built:** 1986
- **Zoning:** M-2
- **Ceiling Height:** 18' - 20' Clear Varies
- **Drive-in Doors:** 1
- **Docks:** 5
- **Silos :** 6 80,000 lbs each
- **# of Parking Spaces:** 23 +Trailer Storage
- **Ext. Construction:** Steel

- **Roof:** Membrane/Steel
- **Floor:** Concrete
- **Interior Walls:** Frame/Steel
- **Sprinkler:** Wet
- **Electrical:** Heavy Electric
480, 3-Phase
- **# of Restrooms:** 2
- **Water/Sewer:** City
- **Current Use:** Manufacturing
- **Taxes:** \$19,760.32 (2023 Pay 2024)
- **Showing:** Contact Listing Broker
- **Location:** East of Highway 41

For More Information, Contact:

Aaron Kendall, CCIM

Direct: 812.480.8100

Office: 812.473.6677

AK@fcte.com



7820 Eagle Crest Blvd. Suite 200
Evansville, IN • 47715
812-473-6677 • Fax: 812-473-6684



FCTuckerCommercial.com

AVAILABLE
1800 Lynch Road
 EVANSVILLE, IN 47711

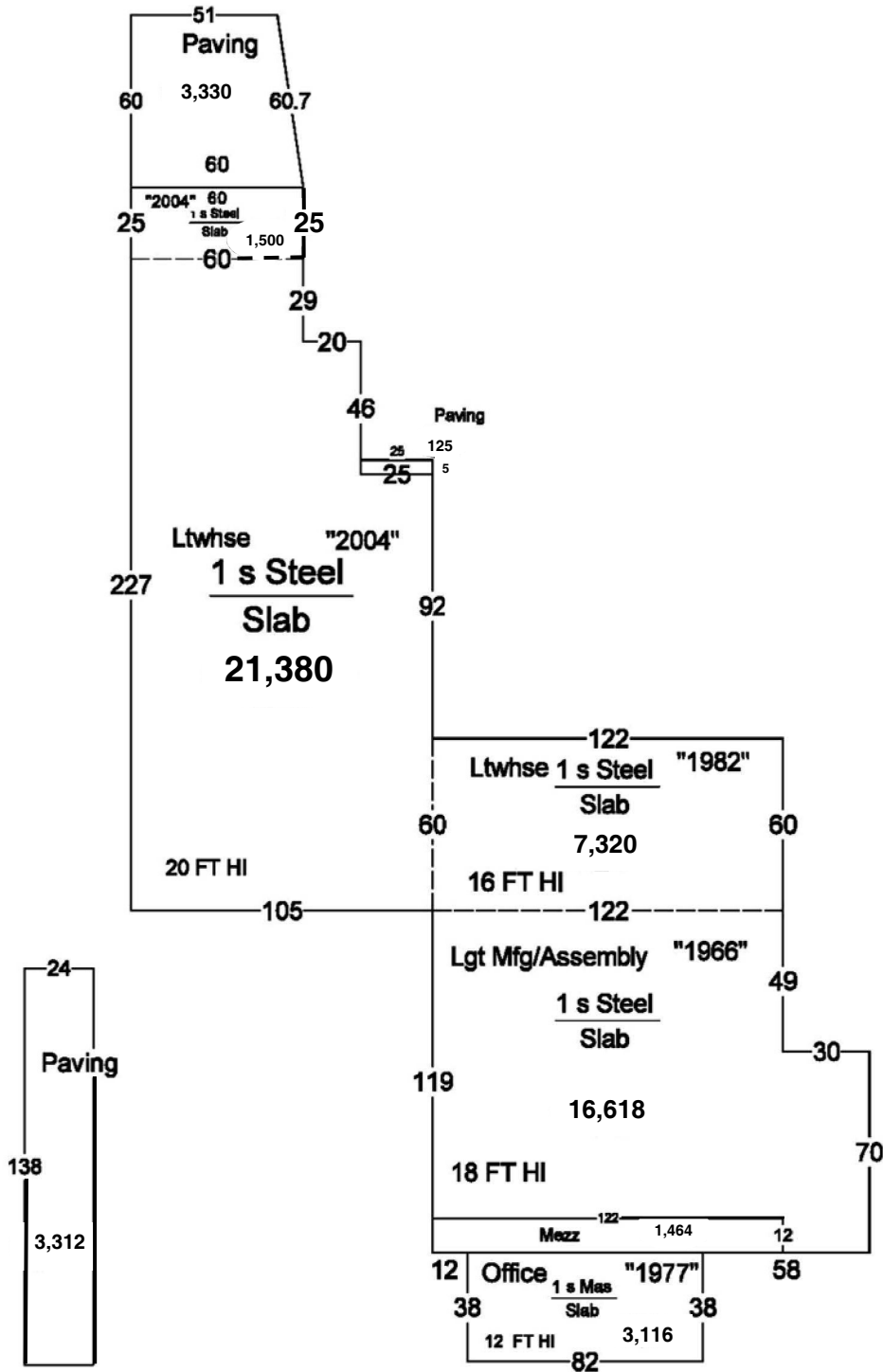

For More Information, Contact:

Aaron Kendall, CCIM
 Direct: 812.480.8100
 Office: 812.473.6677
 AK@fcte.com

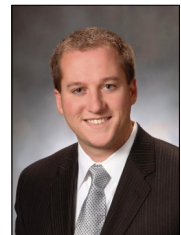

7820 Eagle Crest Blvd. Suite 200
 Evansville, IN • 47715
 812-473-6677 • Fax: 812-473-6684



FCTuckerCommercial.com

The information contained herein was obtained from sources we consider reliable. We cannot be responsible, however, for errors, omissions, prior sale, and withdrawal from the market or change in price.