

1+ ACRE OUTPARCEL

LAND LEASE

Intersection of W. Copans Road and
N. Andrews Avenue/Military Trail

76,500 Combined AADT

2425 N. Andrews Avenue, Pompano
Beach, FL 33064



W. Copans Road

N. Andrews Ave.

PROPERTY HIGHLIGHTS

- Located between I-95 and Florida's Turnpike
- Centrally located in the Tri-Counties of Broward, Miami-Dade, and Palm Beach
- Easy access to serve North and South Florida
- B-4 Zoning Pompano Beach

SAVITAR

SAVITAR PROPERTIES, INC.

Cynthia Herszkovich, Licensed Real Estate Broker
Office 954.979.6730
Cell 305.697.9390

LAND LEASE

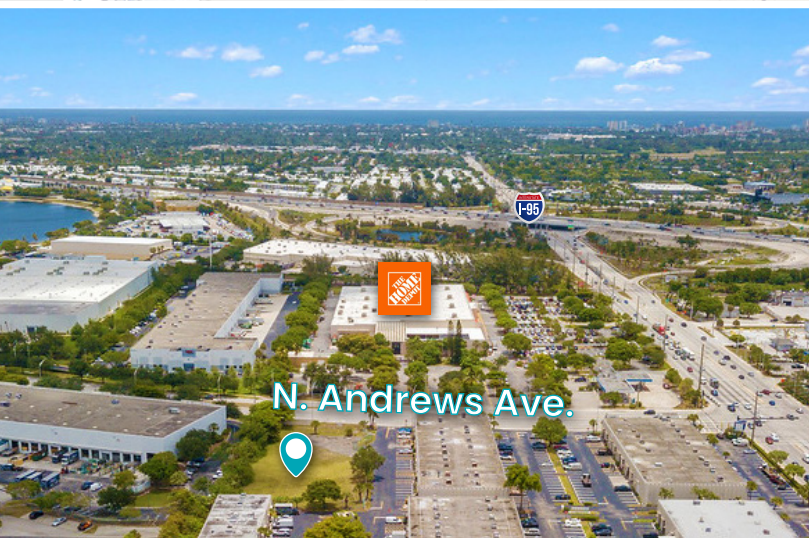

SAVITAR
SAVITAR PROPERTIES, INC.

INDUSTRIAL

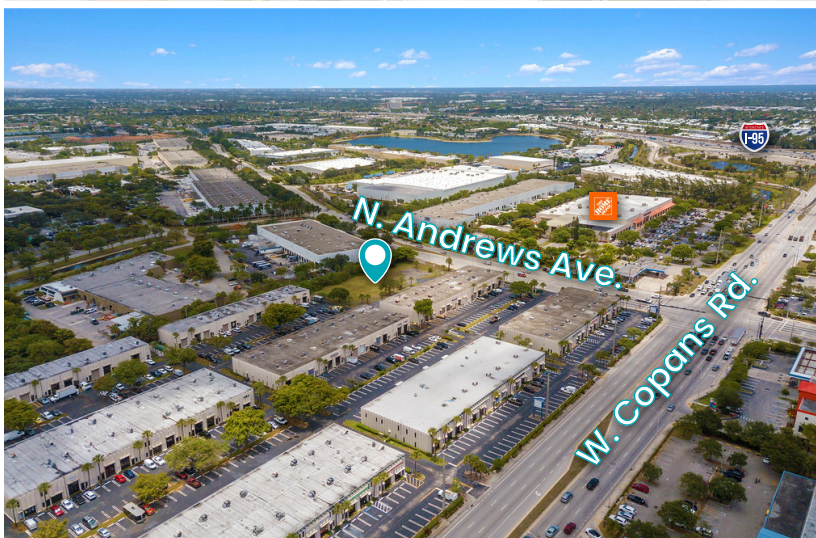

Cynthia Herskovich, Licensed Real Estate Broker
Office 954.979.6730
Cell 305.697.9390



Cynthia Hershkovich, Licensed Real Estate Broker
Office 954.979.6730
Cell 305.697.9390