

82

LUDLOW STREET

BETWEEN BROOME & DELANCEY STREETS
LOWER EAST SIDE



International Center of Photography

82

LUDLOW STREET
BETWEEN BROOME & DELANCEY STREETS
LOWER EAST SIDE

PROPERTY DETAILS

SIZE

Ground Floor: 4,022 SF

(Divisible as shown on plans)

FRONTAGE:

41'

CEILING HEIGHT:

13'

POSSESSION

Immediate

ASKING RENT

Upon Request

TRANSPORTATION:



PROPERTY HIGHLIGHTS

- Space is situated at the base of a luxury condo building
- Located within Essex Crossing with over 1,000 new residential units and 350,000 SF of office space
- Situated in the heart of the Lower East Side amongst dense residential, restaurants, nightlife, and authentic New York retailers
- Space can be divided (see floor plans on next page)
- Restaurant uses welcome

NEIGHBORING TENANTS



 **BondVet**

 **MOSCOT**



TRADER JOE'S

 International Center of Photography



82

LUDLOW STREET

BETWEEN BROOME & DELANCEY STREETS
LOWER EAST SIDE

Current Configuration-4,022 SF

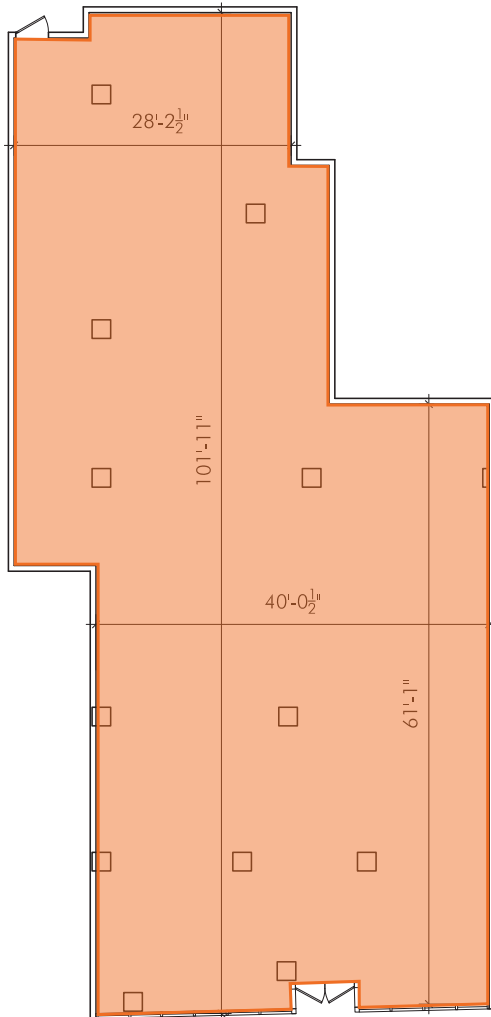

Division Options
Space A: 2,574 SF
Space B: 1,154 SF

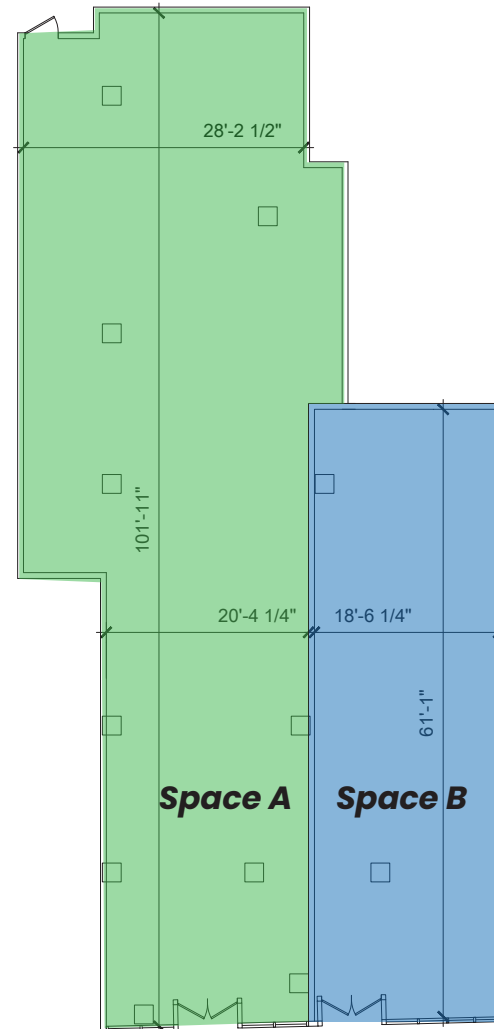

82

LUDLOW STREET
BETWEEN BROOME & DELANCEY
LOWER EAST SIDE

FOR MORE INFORMATION,
PLEASE CONTACT:

BRANDON BERGER

646.236.8525 | BBerger@ksrny.com

ZACH NATHAN

240.731.8333 | ZNathan@ksrny.com

AKRAM MOZEB

646.897.4792 | AMozeb@ksrny.com

