

85,445 SF

FOR LEASE

(DIVISIBLE)



# 329 West 18th Street

Chicago, Illinois 60616

## PROPERTY HIGHLIGHTS

- 85,445 SF available
  - 10th Floor: 34,505 SF
  - 8th Floor: 50,940 SF contiguous
- 9 covered loading docks (shared)
- Shared forklift in loading area
- Zoning: PMD 11B
- 2 passenger and 1 freight elevators  
Freight dimension: 12'w x 6'd x 8'h  
(additional freight delivered Q2 24)
- On site Package Room
- On site Green Tomato Deli, lounge, conference room & terrace
- Abundant amenities within walking distance
- Strong labor pool
- Lease Rate: Subject to Offer



433,168 SF TOTAL BUILDING



85,445 SF AVAILABLE (DIVISIBLE)



9 COVERED LOADING DOCKS (SHARED)



11' CEILING HEIGHT



IMMEDIATE I-90/I-94 HIGHWAY ACCESS



3 DIFFERENT PARKING OPTIONS

## Contact

Alex Sutterer

+1 630 693 0644

asutterer@hiffman.com

Packy Doyle

+1 630 691 0601

pdoyle@hiffman.com

Nick Feczko

+1 630 693 0668

nfeczko@hiffman.com

One Oakbrook Terrace  
Suite 400  
Oakbrook Terrace, Illinois 60181  
+1 630 932 1234

NO WARRANTY OR REPRESENTATION, EXPRESS OR IMPLIED, IS MADE AS TO THE ACCURACY OF THE INFORMATION CONTAINED HEREIN, AND THE SAME IS SUBMITTED SUBJECT TO ERRORS, OMISSIONS, CHANGE OF PRICE, RENTAL OR OTHER CONDITIONS, PRIOR SALE, LEASE OR FINANCING, OR WITHDRAWAL WITHOUT NOTICE, AND OF ANY SPECIAL LISTING CONDITIONS IMPOSED BY OUR PRINCIPALS NO WARRANTIES OR REPRESENTATIONS ARE MADE AS TO THE CONDITION OF THE PROPERTY OR ANY HAZARDS CONTAINED THEREIN ARE ANY TO BE IMPLIED.

10TH FLOOR PLAN  
50,940 SF

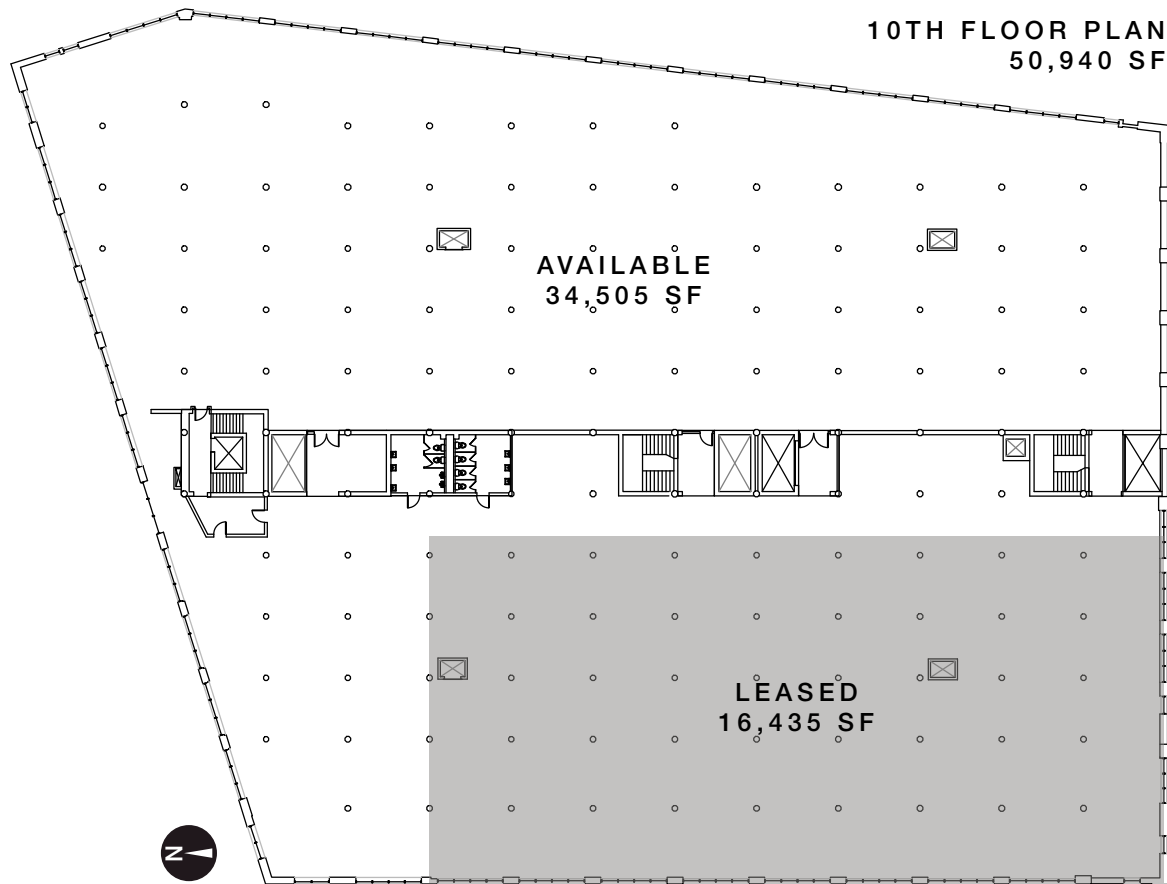

8TH FLOOR PLAN  
50,940 SF

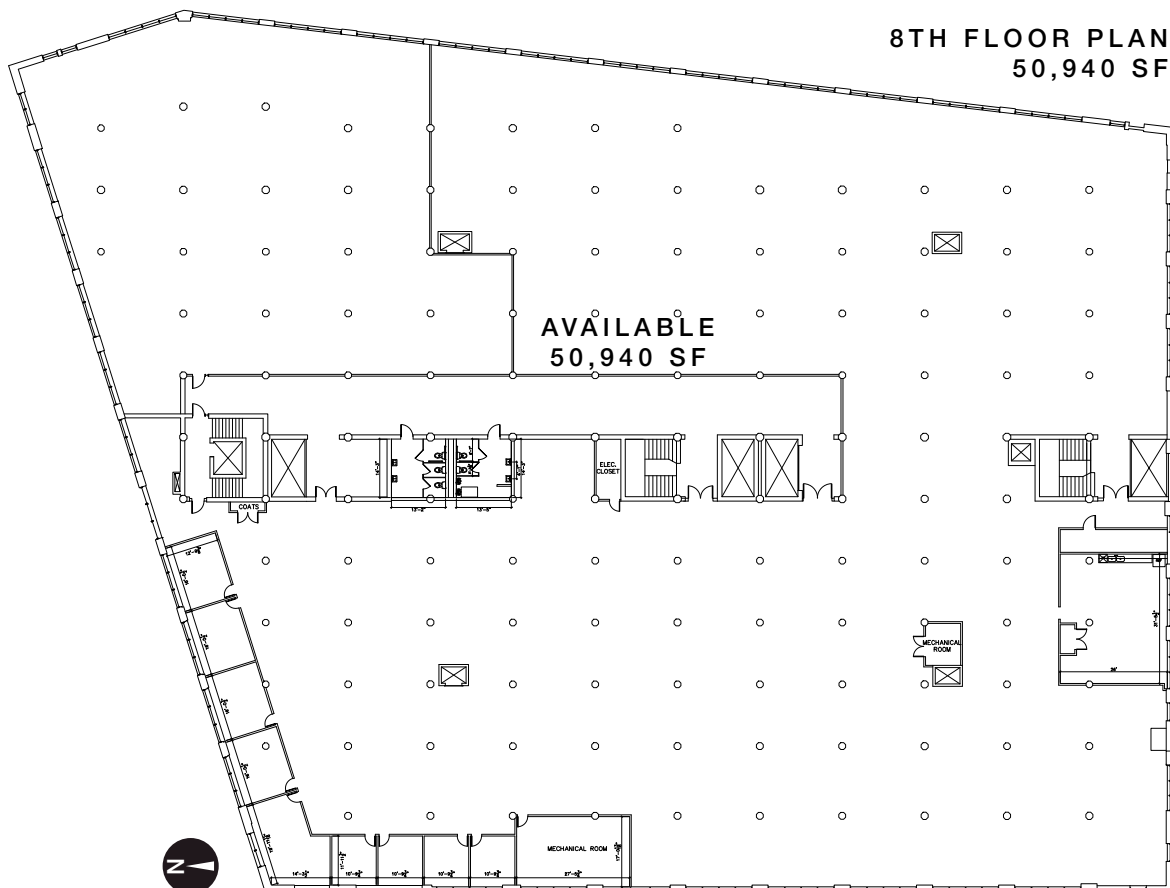



TENANT CONFERENCE ROOM



TENANT LOUNGE



GREEN TOMATO DELI



RECENTLY UPDATED LOBBY



1.1 Miles to I-55 via Canalport/I-90/I-94

The 78



±0.3 MILES TO CTA BUS 18TH/CLARK

0.4 Miles to I-90/I-94 via 18th St

±0.5 MILES TO REDLINE CERMAK/CHINATOWN



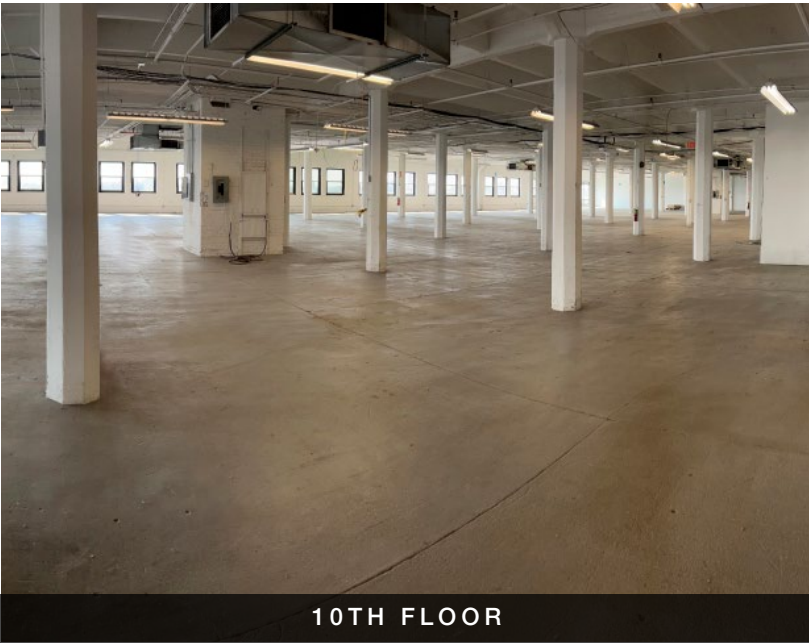

10TH FLOOR

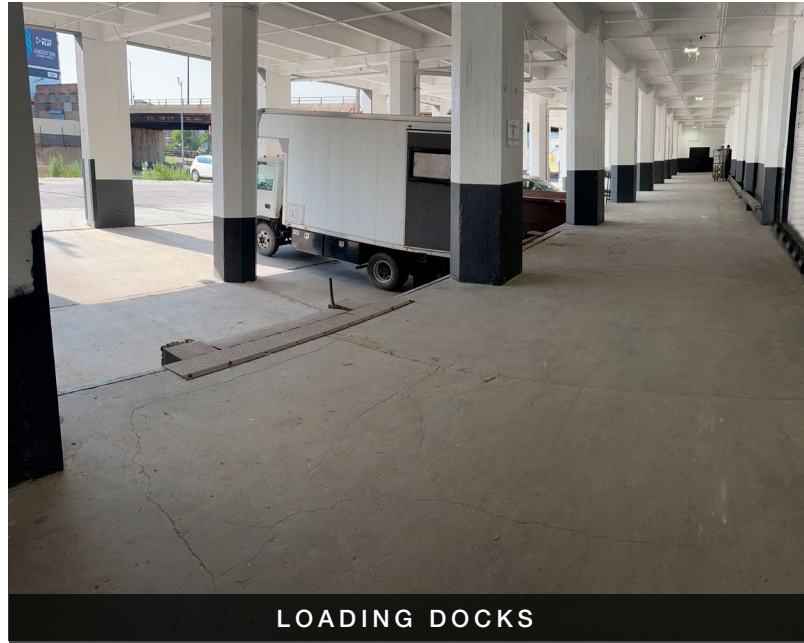

LOADING DOCKS

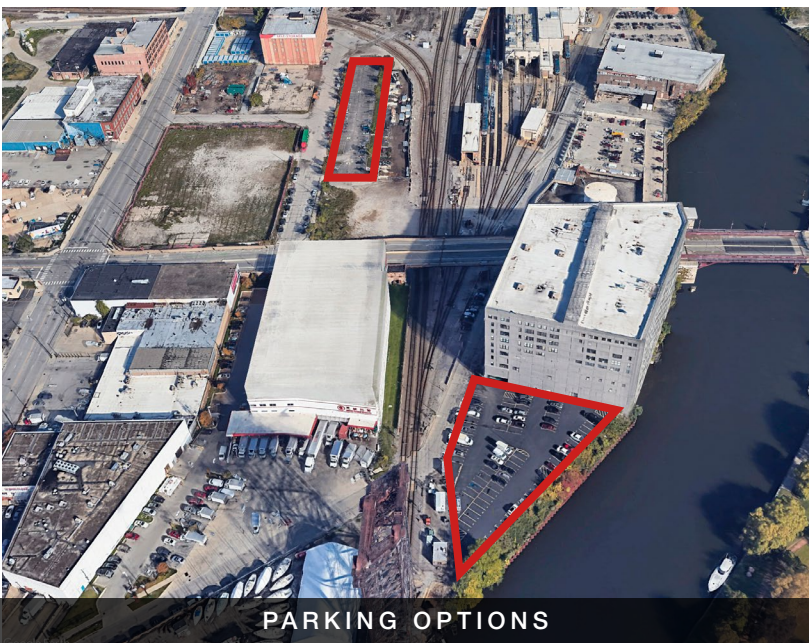

PARKING OPTIONS

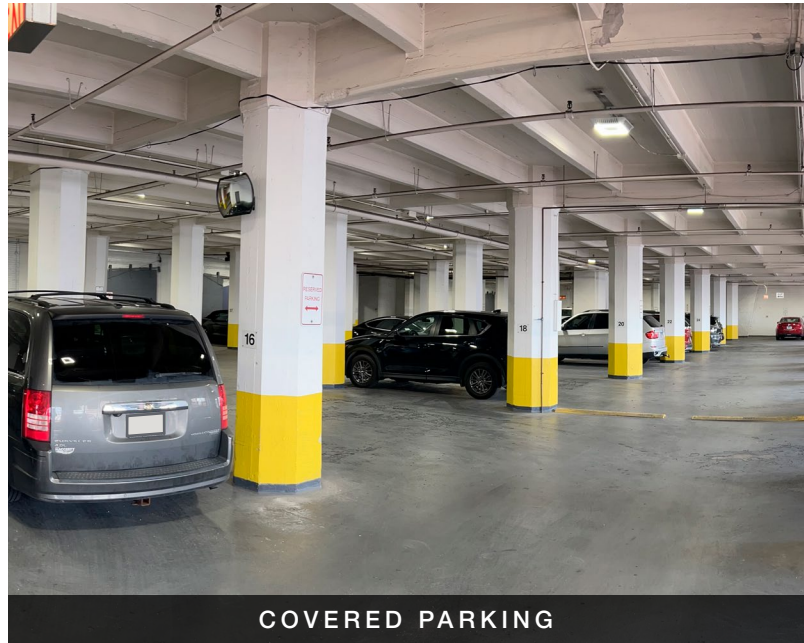

COVERED PARKING

**PARKING OPTIONS**

- Monitored indoor parking garage (\$125/Month)
- Monitored outdoor parking behind the building (\$50/Month)
- Free first come first serve parking on Stewart Avenue (exclusive to building tenants)

**EST. 2024 DEMOGRAPHICS**

ESTIMATES BASED ON A 5-MILE RADIUS



**806,064**  
TOTAL  
POPULATION



**\$142,794**  
AVG. HOUSEHOLD  
INCOME



**28%**  
BACHELOR'S  
DEGREE+



**669,263**  
LABOR  
FORCE