

**For Lease**  
**± 1,790 SF OFFICE/  
WAREHOUSE SPACE**

**12060-12064**

**Woodside Ave**  
Lakeside, CA 92040

± 1,790 SF  
Office/Warehouse



**Nick Mane**

Director - Sales & Leasing  
Nick@PacificCoastCommercial.com  
Lic. 01939391

**Jasmine Golia**

Sales & Leasing Associate  
Jasmine@PacificCoastCommercial.com  
Lic. 02131001



(619) 469-3600 | 10721 Treena St., Ste 200 | San Diego, CA 92131 | www.PacificCoastCommercial.com | Lic. 01209930

# PROPERTY FEATURES

## 12062 Woodside Avenue | Suite 102 & 103

- Approx. 1,790 SF Office / Warehouse
- 2 Private / Open Offices
- Private Restroom
- Warehouse
- Zoning: County of San Diego C-37 ([Download](#))
- Traffic Counts: Approx. 10,000 Cars Per Day
- Building & Monument Signage Available
- Lease Rate: \$2,900 Per Month, Gross

### 1st Floor

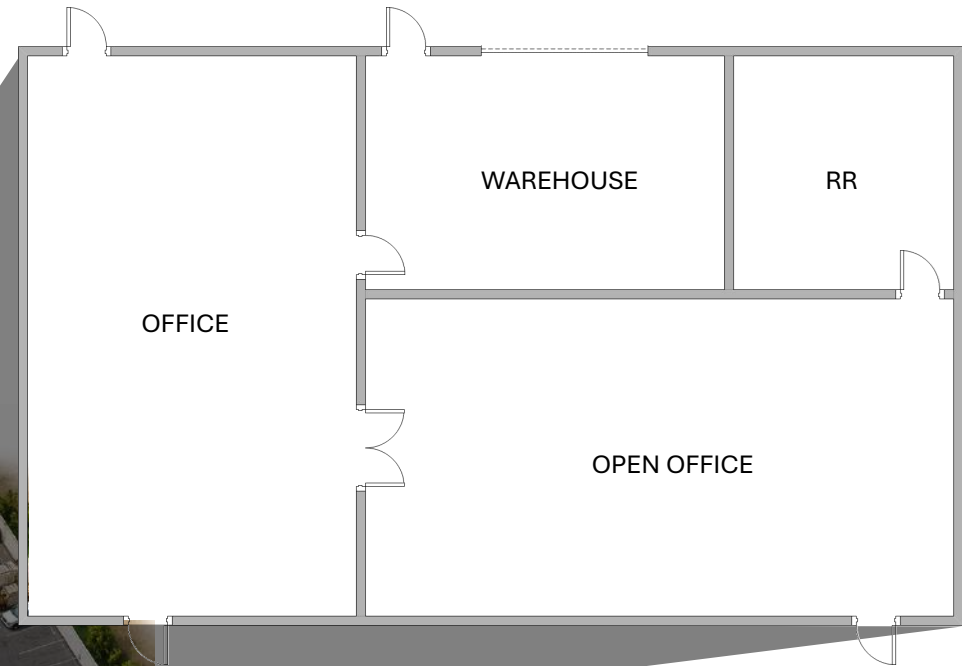

Floor plan is not to scale; for reference purposes only.

The site plan shown is a conceptual rendering generated with the assistance of artificial intelligence and is for illustrative purposes only. While efforts have been made to ensure reasonable accuracy, the depiction may not reflect actual dimensions or features. All information should be verified prior to transaction.

# CONTACT INFORMATION

## NICK MANE

Director - Sales & Leasing  
Nick@PacificCoastCommercial.com  
Lic. 01939391

## JASMINE GOLIA

Sales & Leasing Associate  
Jasmine@PacificCoastCommercial.com  
Lic. 02131001

## OFFICE (619) 469-3600

10721 Trenea Street, Ste 200  
San Diego, CA 92131  
www.PacificCoastCommercial.com  
Lic. # 01209930



The information in this brochure is provided for general marketing purposes only and is believed to be reliable but not guaranteed. Interested parties should verify all details independently, including zoning, measurements, and property condition. The property owner and agents make no warranties or representations and reserve the right to change or withdraw the property or terms at any time without notice. This is not an offer or contract.