



For Sale

# 2220 Centennial Drive

## Gainesville, GA 30504

### Overview

Building Size:	45,100 SF
Lot Size:	9.18 Acres
Year Built:	1987
Doors:	4 Docks, 5 Drive Ins
Zoning:	L-I (Light Industrial)
Parcel Number:	08013 003003
Parking:	51 Surface Spaces
Sale Price:	Inquire
Clear Height:	22'

### Space Specs

- 4,600 SF Office Space
- Wet Sprinkler System
- Heavy Power (3-Phase/600 Amps/480V)
- Large outdoor storage area
- Property is less than a 10-minute drive from I-985. Other major roads nearby include Highway 53, Browns Bridge Road, and McEver Road.

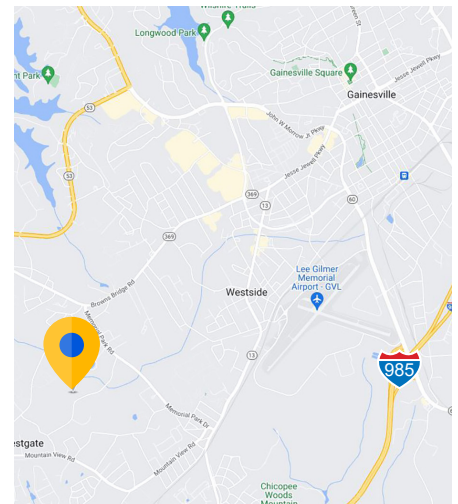

### For more information:



**Michael Bennett**  
770.990.5700  
mbennett@cresa.com



**Matthew Skole**  
678.371.2101  
mskole@cresa.com

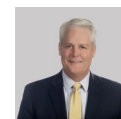

**Jim Bob Taylor**  
404.446.1864  
jbtaylor@cresa.com



For Sale



# 2220 Centennial Drive

Gainesville, GA 30504

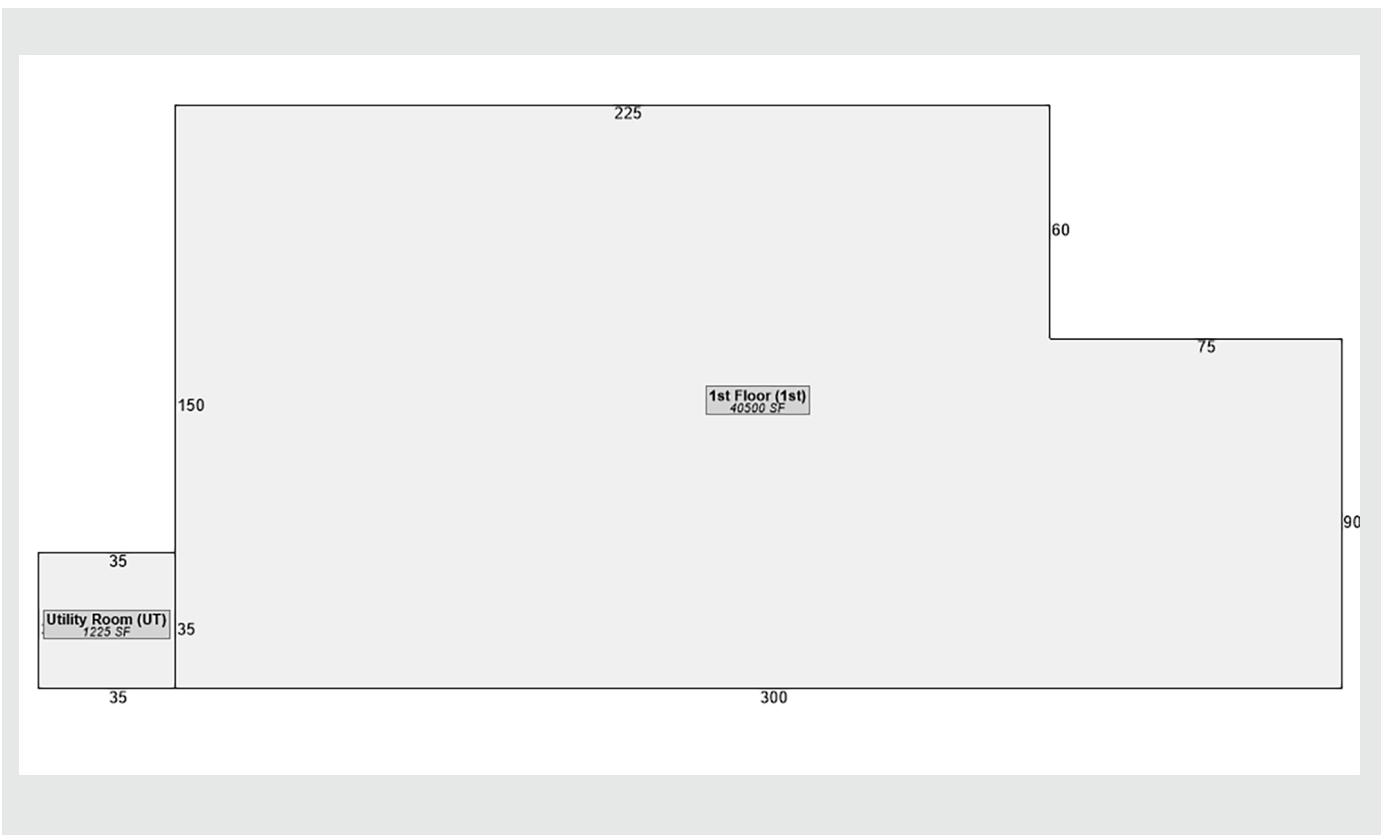



For Sale

cresa

# 2220 Centennial Drive

Gainesville, GA 30504

