



438 McLaws Circle

Williamsburg, VA 23185

PROPERTY HIGHLIGHTS

- Suite 100 (7,000 SF) and Suite 101 (3,000 SF) available
- Suites can be combined for a total of 10,000 SF
- Stand-alone building for lease: \$17.50/SF, Modified Gross
- Offering a functional floor plan design with a combination of large private offices and collaboration area
- A bright space with high ceiling and generous natural light
- Unique feature of a dock-high loading available at the rear of the building
- Located with close proximity to Kingsmill Golf Resort, Riverside Doctor's Hospital and Quarterpath Mixed-Use Development
- Less than 2 miles from I-64 at Exit #242
- Exterior building signage available

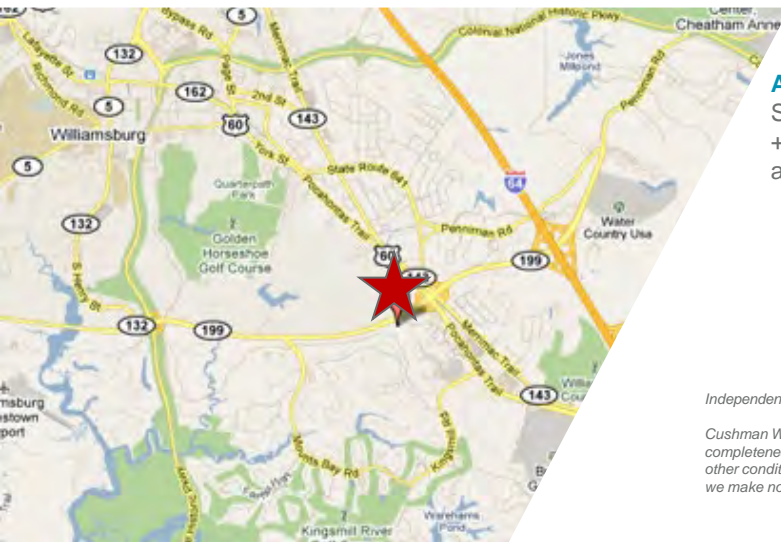

ANDY DALLAS, CCIM, SIOR

Senior Vice President
+1 757 873 3661
andy.dallas@thalhimer.com

ROBERT L. PHILLIPS, JR., SIOR

First Vice President
+1 757 873 4124
bobby.phillips@thalhimer.com

One BayPort Way, Suite 100
Newport News, Virginia
Main +1 757 873 2900
thalhimer.com

Independently Owned and Operated / A Member of the Cushman & Wakefield Alliance

Cushman Wakefield | Thalhimer © 2024. No warranty or representation, express or implied, is made to the accuracy or completeness of the information contained herein, and same is submitted subject to errors, omissions, change of price, rental or other conditions, withdrawal without notice, and to any special listing conditions, imposed by the property owner(s). As applicable, we make no representation as to the condition of the property (or properties) in question.

438 McLaws Circle

Williamsburg, VA 23185



Independently Owned and Operated / A Member of the Cushman & Wakefield Alliance

Cushman Wakefield | Thalhimer © 2024. No warranty or representation, express or implied, is made to the accuracy or completeness of the information contained herein, and same is submitted subject to errors, omissions, change of price, rental or other conditions, withdrawal without notice, and to any special listing conditions, imposed by the property owner(s). As applicable, we make no representation as to the condition of the property (or properties) in question.

438 McLaws Circle

Williamsburg, VA 23185

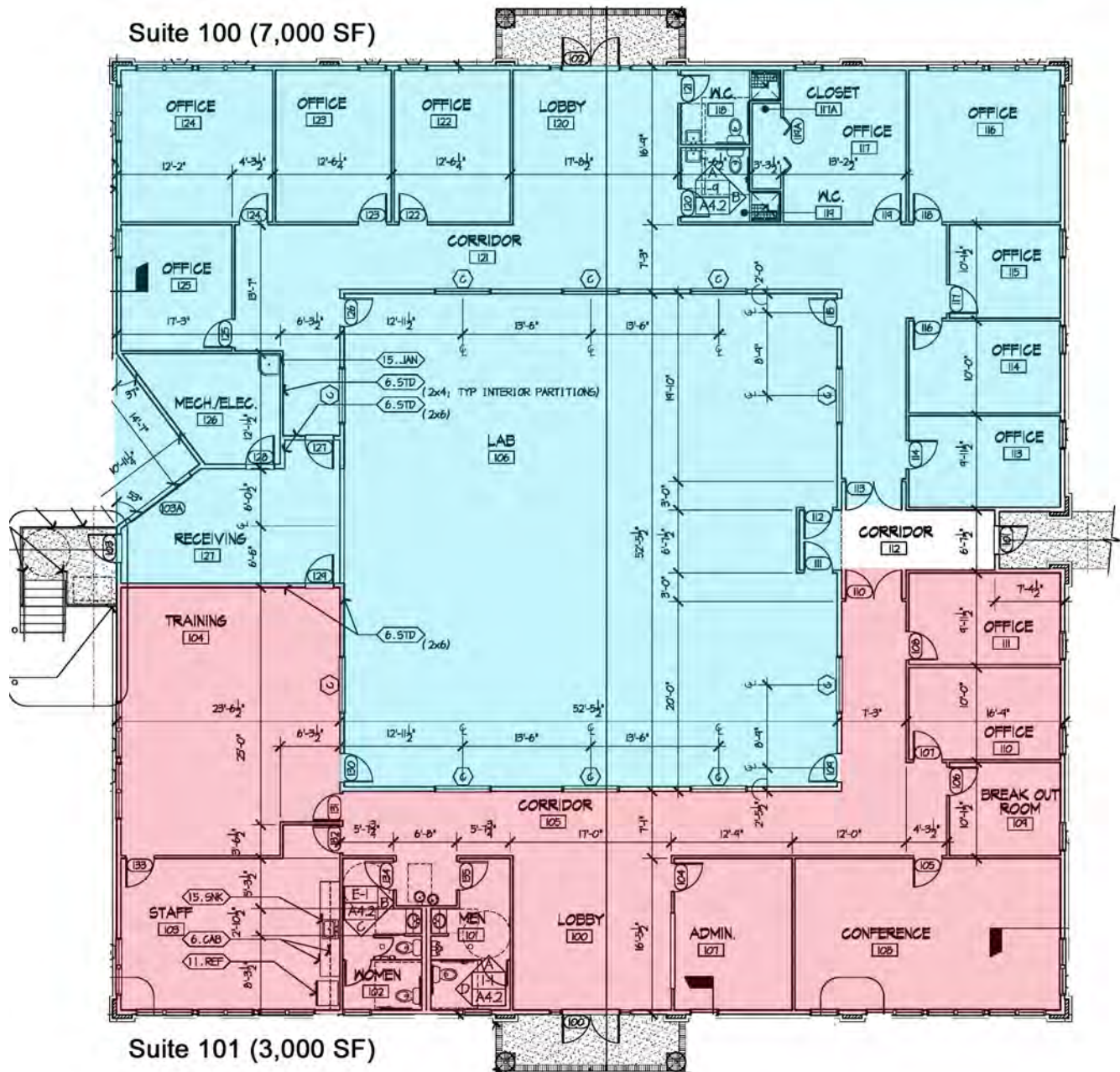

438 McLaws Circle

Williamsburg, VA 23185



SITE PLAN

