

# FOR LEASE

# Freeway Frontage Industrial/Retail Unit E, 8,286 SF

110 N. WASHBURN CIRCLE | CORONA | CA | 92882



## PROPERTY FEATURES

- Rare Freeway Frontage Industrial Unit
- Divisible into Two (2) Units
- Five Ground Level Roll-Up Doors, Four (4) on One Side and One (1) on the Interior Unit
- Fenced Yard
- 15'-17' Interior Warehouse Clear Height
- 100 Amps Power (verify)
- Ample Parking
- Great Access to the 91 and 15 Freeways
- Offices with Restrooms
- Vacant
- Call to Tour

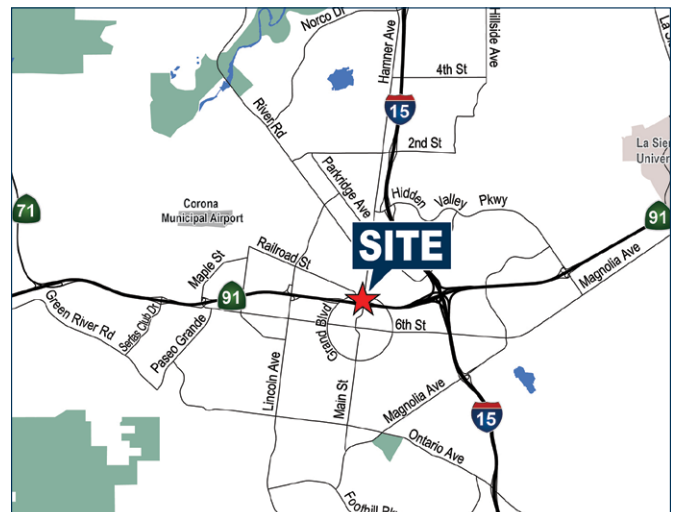

### JACK FARIS

Senior Vice President | Partner

License #00912766

(949) 400-0957

jfaris@voitco.com

### DREW ZAVALA

Associate

License #02173846

(949) 263-5314

dzavala@voitco.com

## Voit

REAL ESTATE SERVICES

2400 E. Katella Ave., Suite 750  
Anaheim, CA 92806  
714.978.7880 • 714.978.9431 Fax  
www.VoitCo.com

# FOR LEASE

## Freeway Frontage Industrial/Retail Unit E, 8,286 SF

110 N. WASHBURN CIRCLE | CORONA | CA | 92882

### SITE PLAN

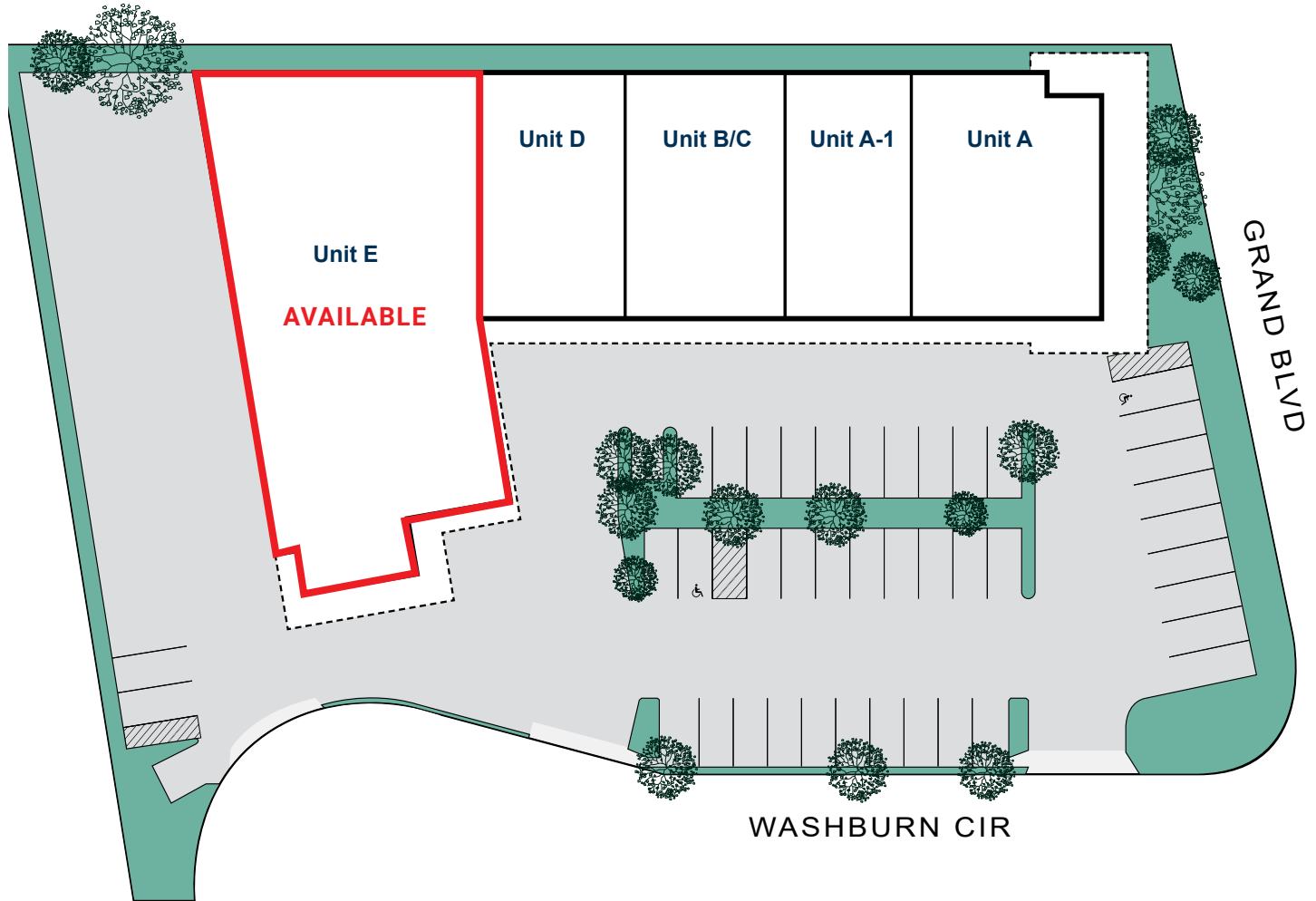

Please Note: Site Plan may not be to scale.

#### JACK FARIS

Senior Vice President | Partner  
License #00912766  
(949) 400-0957  
jfaris@voitco.com

#### DREW ZAVALA

Associate  
License #02173846  
(949) 263-5314  
dzavala@voitco.com

### Voit

REAL ESTATE SERVICES

2400 E. Katella Ave., Suite 750  
Anaheim, CA 92806  
714.978.7880 • 714.978.9431 Fax  
www.VoitCo.com

# FOR LEASE

Freeway Frontage  
Industrial/Retail Unit E, 8,286 SF

110 N. WASHBURN CIRCLE | CORONA | CA | 92882



**JACK FARIS**  
Senior Vice President | Partner  
License #00912766  
(949) 400-0957  
jfaris@voitco.com

**DREW ZAVALA**  
Associate  
License #02173846  
(949) 263-5314  
dzavala@voitco.com

**Voit**  
REAL ESTATE SERVICES

2400 E. Katella Ave., Suite 750  
Anaheim, CA 92806  
714.978.7880 • 714.978.9431 Fax  
www.VoitCo.com

# FOR LEASE

# Freeway Frontage Industrial/Retail Unit E, 8,286 SF

110 N. WASHBURN CIRCLE | CORONA | CA | 92882

## AERIAL



### JACK FARIS

Senior Vice President | Partner

License #00912766

(949) 400-0957

[jfaris@voitco.com](mailto:jfaris@voitco.com)

### DREW ZAVALA

Associate

License #02173846

(949) 263-5314

[dzavala@voitco.com](mailto:dzavala@voitco.com)

## Voit

REAL ESTATE SERVICES

2400 E. Katella Ave., Suite 750  
Anaheim, CA 92806  
714.978.7880 • 714.978.9431 Fax  
[www.VoitCo.com](http://www.VoitCo.com)