



CONTACT US

Jimmy Martin, SIOR

Senior Vice President
+1 804 267 7218
jimmy.martin@colliers.com

Rob Dirom

Senior Vice President
+1 804 334 0987
rob.dirom@colliers.com

2221 Edward Holland Dr
Suite 600 | Richmond, VA
P: +1 804 320 5500
colliers.com/richmond

FOR SALE/LEASE

12195 Harley Club Dr., Ashland, VA

**Rare opportunity, up to 34,800 SF industrial
with 3 acres of outdoor storage**

17,400 – 34,800 SF available

- 34,800 SF precast construction warehouse building
 - 7,200 SF of office
 - 27,600 SF of warehouse
- 3 acres of fenced and graveled outdoor storage
- 24' clear in the warehouse
- 3 docks with one pit leveler
- 2, 16'x20' grade doors with immediate access to the outdoor storage yard
- 30'x40' column spacing
- LED lights in the warehouse
- Excellent access to I-95
- Extremely rare opportunity with building size and yard offered
- **\$20.50 PSF, NNN**
- **Purchase price: call for pricing**

12195 Harley Club Dr.

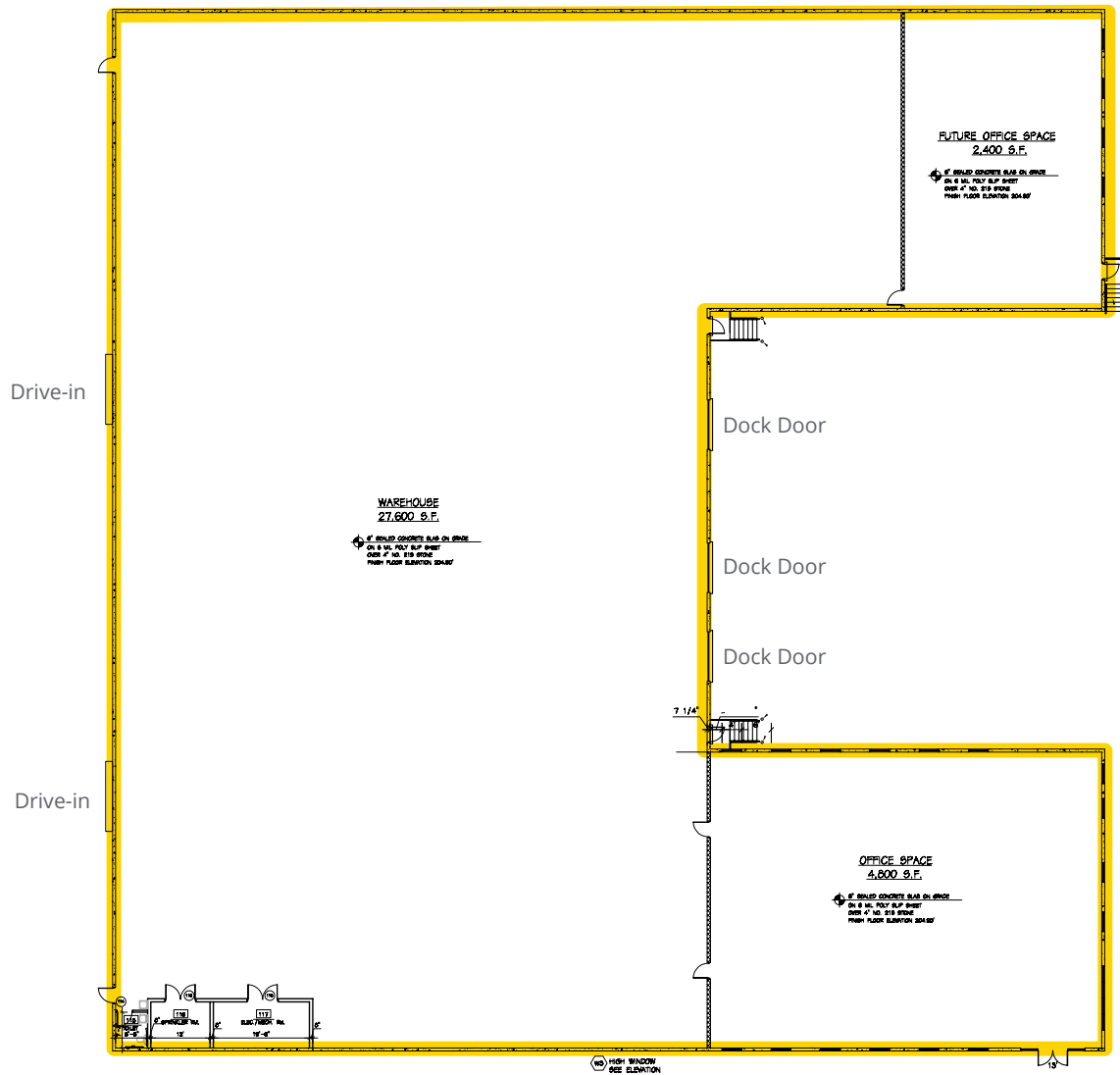

12195 Harley Club Dr.



12195 Harley Club Dr.

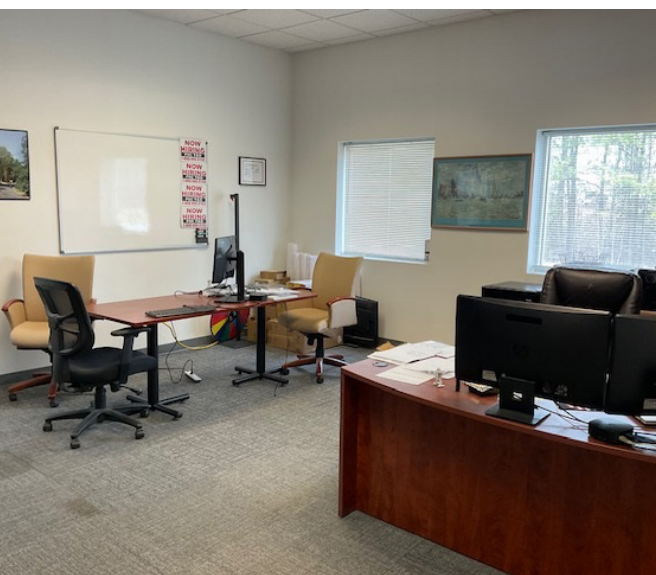

12195 Harley Club Dr.

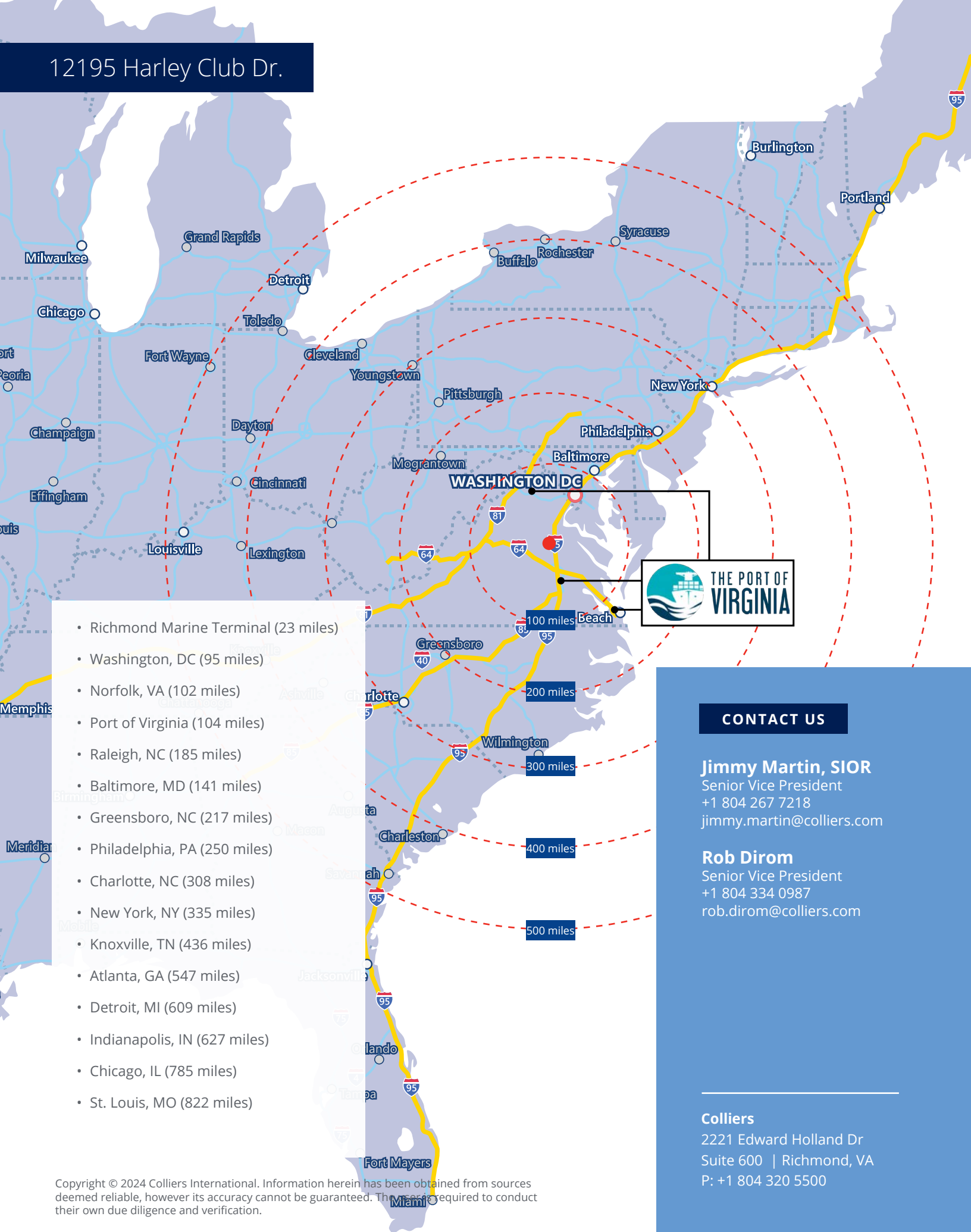

- Richmond Marine Terminal (23 miles)
- Washington, DC (95 miles)
- Norfolk, VA (102 miles)
- Port of Virginia (104 miles)
- Raleigh, NC (185 miles)
- Baltimore, MD (141 miles)
- Greensboro, NC (217 miles)
- Philadelphia, PA (250 miles)
- Charlotte, NC (308 miles)
- New York, NY (335 miles)
- Knoxville, TN (436 miles)
- Atlanta, GA (547 miles)
- Detroit, MI (609 miles)
- Indianapolis, IN (627 miles)
- Chicago, IL (785 miles)
- St. Louis, MO (822 miles)



CONTACT US

Jimmy Martin, SIOR
Senior Vice President
+1 804 267 7218
jimmy.martin@colliers.com

Rob Dirom
Senior Vice President
+1 804 334 0987
rob.dirom@colliers.com

Colliers

2221 Edward Holland Dr
Suite 600 | Richmond, VA
P: +1 804 320 5500