

THE STATION
urban offices



THE ULTIMATE WORKSPACE SOLUTION

WORK SMARTER, NOT HARDER

ABOUT US

We offer workspace solutions for entrepreneurs, startups, and companies of all sizes. We welcome local companies as well as foreign looking to establish a presence in El Paso. The Station has a modern concept of all-inclusive workspaces. It is specially designed to increase your productivity and creativity.

LOCATED DOWNTOWN EL PASO

500 W Overland Ste. 250

El Paso, Texas, 79901

(915) 730 3800

thestationep.com

LARGE OFFICE 286 SF

AVAILABLE: 2

SERVICES INCLUDED



BUSINESS ADDRESS



LISTING BOARD



MAIL HANDLING TO YOUR MAILBOX



24/7 ACCESS



WI-FI, FIBER OPTIC INTERNET



UNLIMITED COFFEE, WATER & BEER



FULL CONFERENCE ROOM ACCESS



HERMAN MILLER FURNITURE



ON-SITE MANAGEMENT



24/7 SECURITY GUARD



ADD-ONS

- VOICE IP/PHONES AND CALL TRANSFERENCE
- MONTHLY PARKING SPACE
- PRINTING SERVICES
- EXTRA FURNITURE (under availability)
- COMPANY LOGO ON DOOR

FLEXIBLE LEASES

- ONE MONTH SECURITY DEPOSIT
- LEASE TERM 3+ MONTH

*Furniture and layout may vary from the picture

CUSTOMIZED LAYOUTS UNDER FURNITURE INVENTORY

MOVE-IN READY AND LOCKABLE SPACE TO ACCOMMODATE 1-12 PEOPLE.

BUSINESS PARTNERS



DISCOVER PREMIUM, ADAPTABLE OFFICE ENVIRONMENTS. CONNECT WITH US!



sf@thestationep.com



www.thestationep.com



(915) 730-3800

LARGE OFFICE 286 SF

TOTAL OFFICES: 1 MAX
CONTIGUOUS: 1

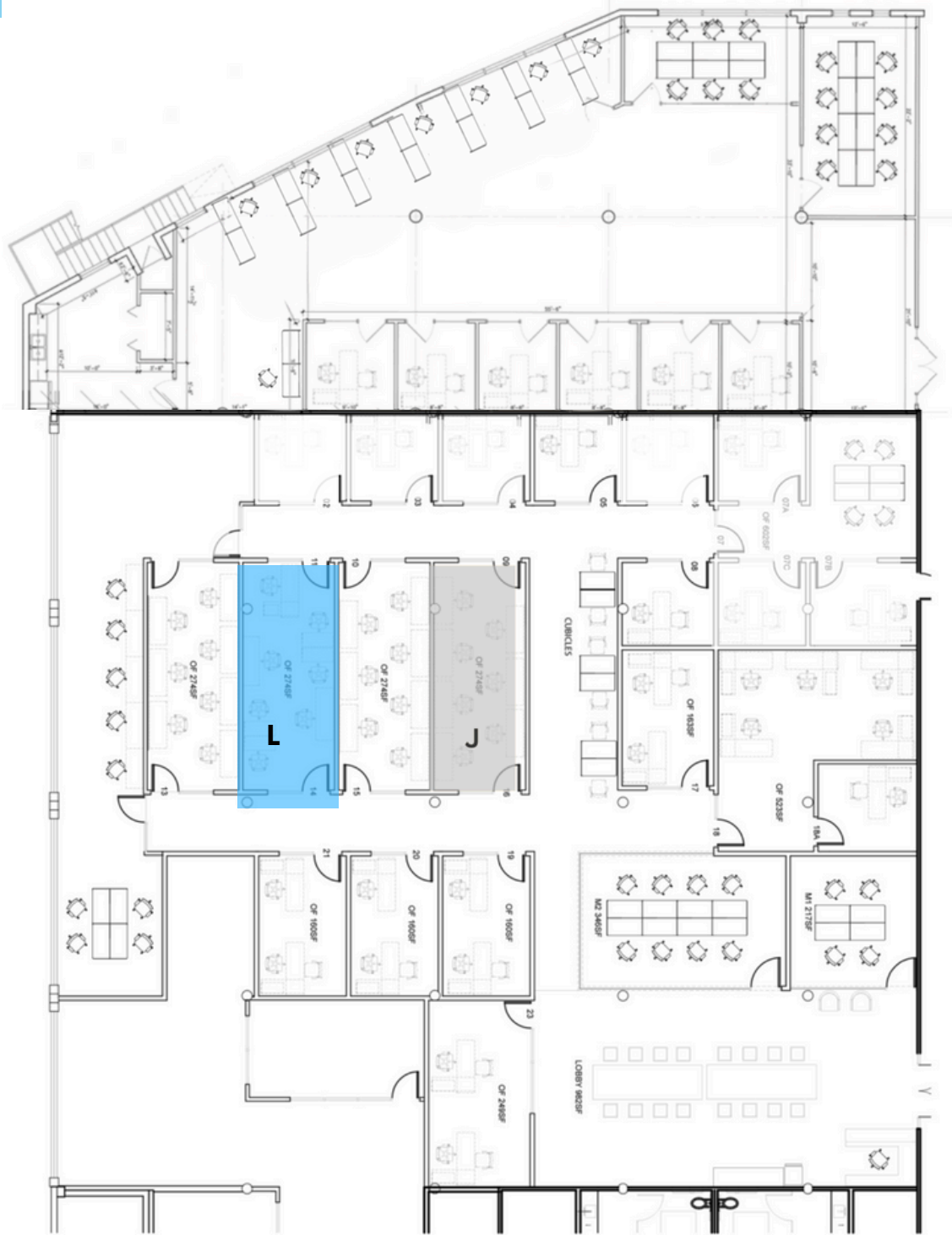

DISCOVER PREMIUM, ADAPTABLE OFFICE ENVIRONMENTS. CONNECT WITH US!



THE ULTIMATE WORKING SOLUTION

DISCOVER PREMIUM, ADAPTABLE OFFICE ENVIRONMENTS. CONNECT WITH US!