

For Lease
OFFICE SUITES
Lanham, MD 20706



4550 Forbes Boulevard

Lanham, Prince George's County, MD

Property Features

- 58,729 sf total
- Suites available
 - 2nd floor - 4,914 sf
 - 3rd floor - 2,710 sf and 3,344 sf
- Excellent location, 1/2 mile to Capital Beltway (I-495) & Rt. 50 interchange
- **RENTAL RATE: \$16.95*- \$19.95 PSF, Full Service (*Certain 3rd floor suites).**
(Rate based on TI \$ amount needed)

For more information:

Andy Mayr, CCIM
+1 301 918 2919
amayr@naimichael.com

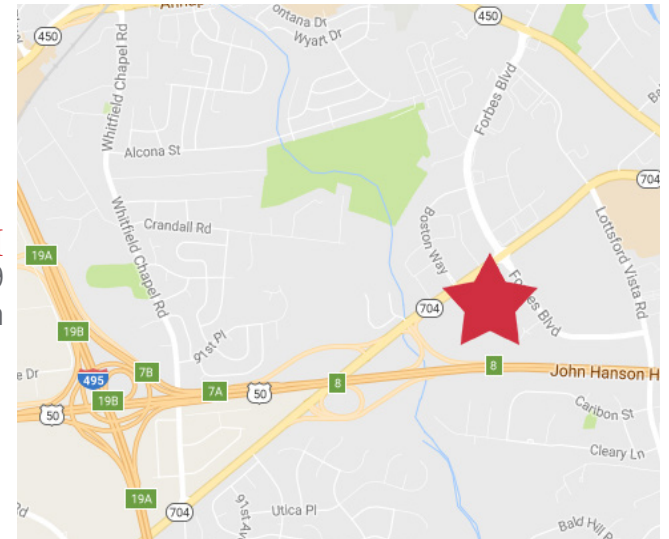

The information contained herein has been given to us by the owner of the property or other sources we deem reliable. We have no reason to doubt its accuracy, but we do not guarantee it. Floor plans, site plans and other graphic representations of this property have been reduced and reproduced, and are not necessarily to scale. All information should be verified prior to purchase or lease.

10100 Business Parkway
Lanham, Maryland 20706
+1 301 459 4400
naimichael.com

For Lease
4550 Forbes Boulevard
Lanham, MD 20706

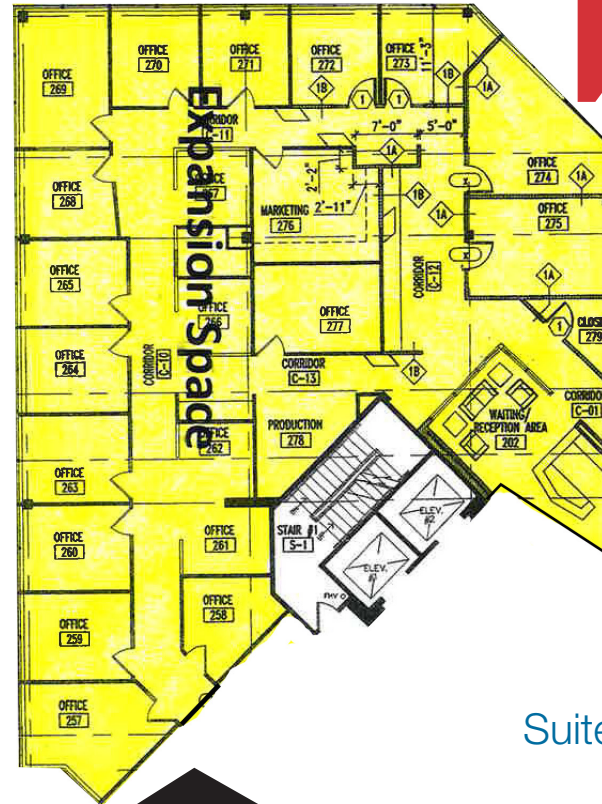

Suite (2nd Floor)

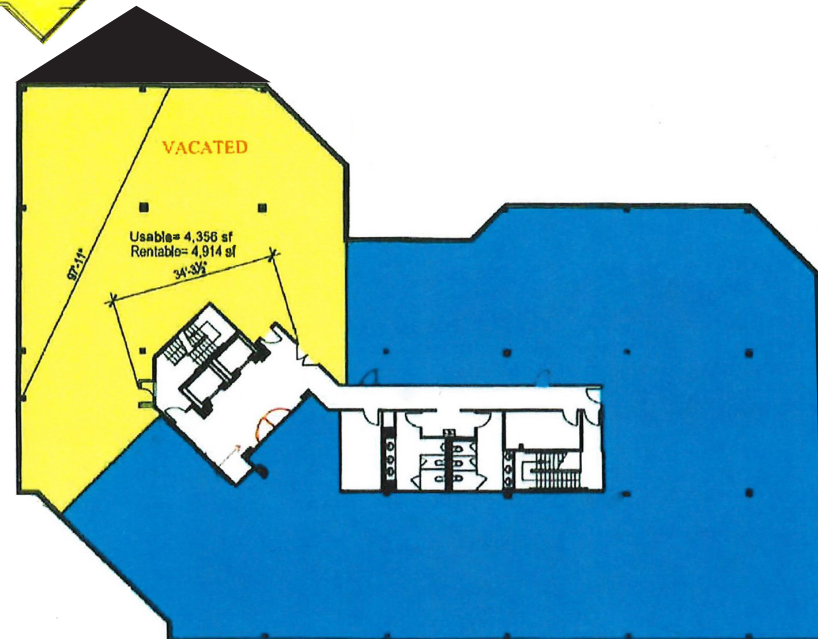

10100 Business Parkway
Lanham, Maryland 20706
+1 301 459 4400
naimichael.com

For Lease
4550 Forbes Boulevard
Lanham, MD 20706

Suite 310 - 2,710 sf

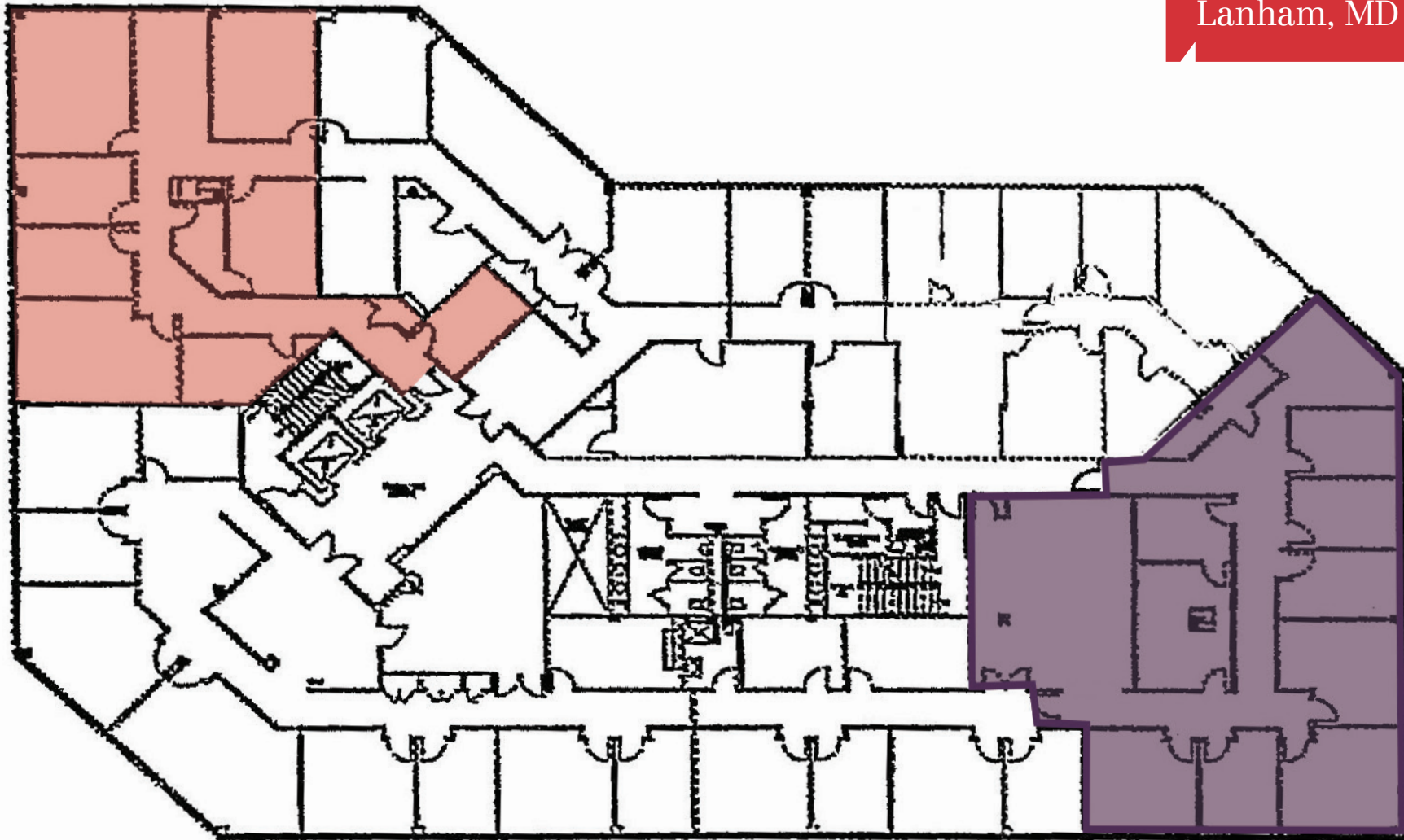

Suite 340 - 3,344 sf

Multiple Suites (3rd Floor)



10100 Business Parkway
Lanham, Maryland 20706
+1 301 459 4400
naimichael.com

For more information, please contact:

Andy Mayr, CCIM

+1 301 918 2919 | amayr@naimichael.com