

FOR LEASE

BELMONT SQUARE

3100 E. Lake Mead Blvd. & 3029 Thomas
North Las Vegas, NV 89030

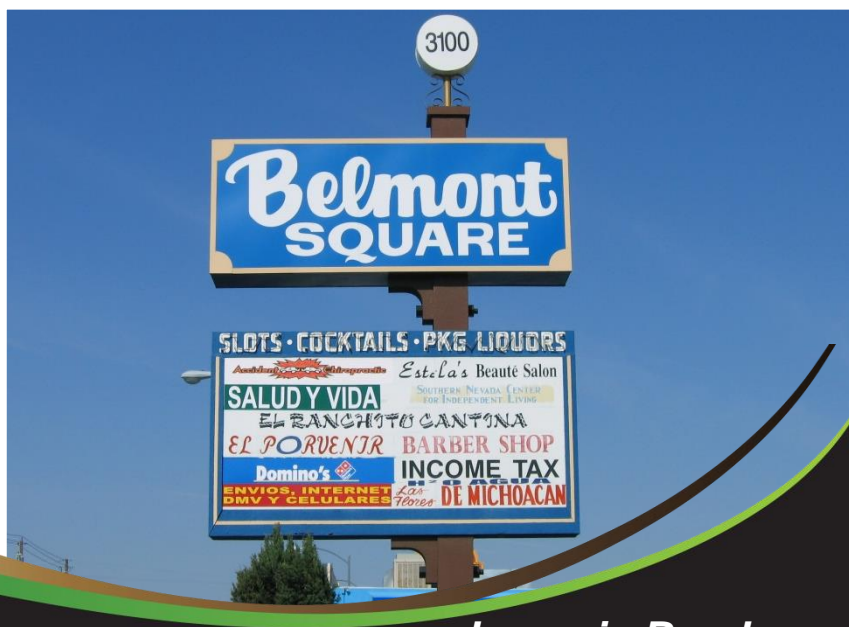

Brenda Olson

Senior Associate, Brokerage Services
NRE License # S.0175952
(702) 765-8880

brenda@gatskicommercial.com

Laramie Bracken

Senior Vice President, Brokerage Services
NRE License # S.0065576
(702) 765-8888

laramie@gatskicommercial.com

FOR LEASE

BELMONT SQUARE
3100 E. Lake Mead Blvd. & 3029 Thomas
North Las Vegas, NV 89030

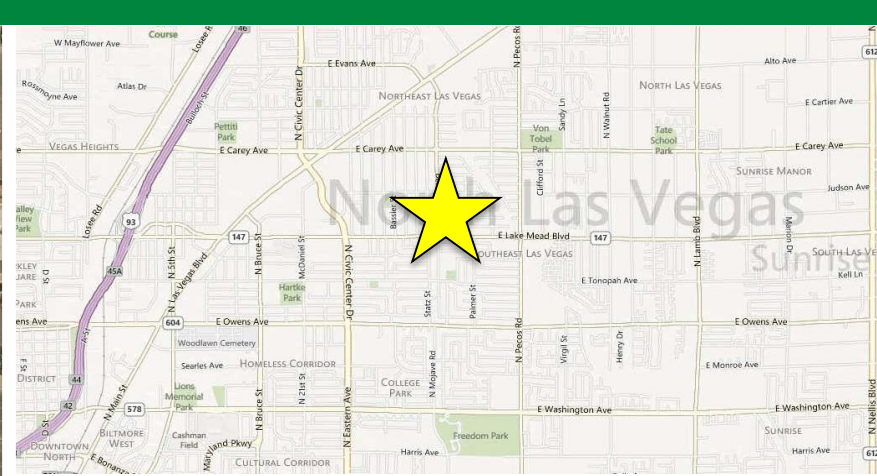

Belmont Square is in a well established area of North Las Vegas surrounded by other small business and residential rooftops. The portion of Lake Mead between Pecos and Civic Center has great traffic counts and a high density population that drive traffic to the center. The location also offers convenient access to freeways and the commercial center in N. Las Vegas. Join Domino's Pizza, and the \$0.99 store.

- **Rates from \$0.85 NNN**
- 1,000 SF available
- Well established center
- High traffic count on Lake Mead
- Easy access to US-95 & I-95
- Ample Parking

Demographics	1 mile	3 miles	5 miles
Population	36,295	215,804	515,188
Avg. Household Income	\$33,473	\$29,402	\$38,146
Total Housing Units	9,221	34,069	163,246

Traffic Counts		
E. Lake Mead Blvd.	N. Pecos Rd.	28,828 VPD
E. Lake Mead Blvd.	N. Daley St.	40,419 VPD
N. Pecos Rd.	Hickey Ave.	23,514 VPD

Suite	Square Feet	Space Description
9	1,000	This space is wide open. It will work well for a variety of retail users, a church, Insurance Agency, etc.
12	1,000	This space is wide open. It will work well for a variety of retail users, a church, Insurance Agency, etc.