



6195 TRI COUNTY COMMERCE WAY  
FORT MYERS, FL 33905

TRI-COUNTY 75

CBRE



# PROPERTY OVERVIEW

---

- + Lease Rate: \$16.00/SF NNN
- + OPEX: \$4.03/SF
- + Immediate access to I-75
- + Centrally located within Southwest Florida with the ability to reach 4.4 million people within a 120 minute drive time
- + Close proximity to Retail, Restaurants and Lodging





# BUILDING SPECIFICATIONS

## Space Highlights

6195 TRI COUNTY COMMERCE WAY  
FORT MYERS, FL 33905

Building Size	120,722
Available Size	22,524 SF (Building 4- Suite 420)
Office	1,013 SF
Year Built	2023
Clear Height	32'
Building Depth	140'
Dock Doors	6
Drive-In Ramp	1
Truck Court Depth	130'
Auto Parking	31



# BUILDING 4:SUITE 420

22,524 SF AVAILABLE  
WITH 1,013 SF OFFICE SPACE

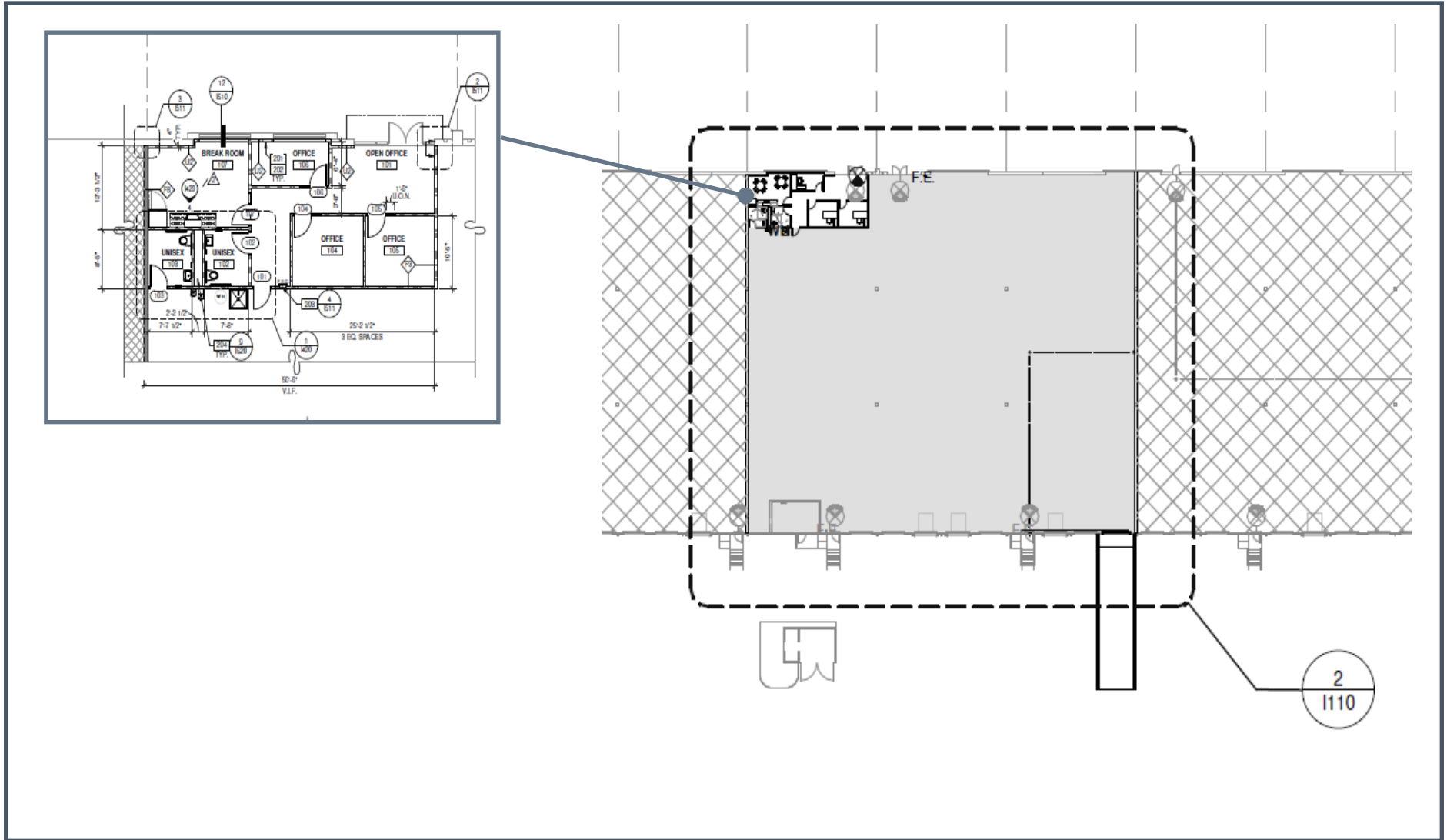



## TRI-COUNTY 75





# AERIAL MAP







6195 TRI COUNTY COMMERCE WAY  
FORT MYERS, FL 33905

## TRI- COUNTY 75

22,524 SF  
AVAILABLE FOR LEASE

Derek Bornhorst, SIOR, CCIm  
Senior Vice President

+1 239 898 7987  
derek.bornhorst@cbre.com

**CBRE**

©2025 CBRE, Inc. All rights reserved. This information has been obtained from sources believed reliable but has not been verified for accuracy or completeness. CBRE, Inc. makes no guarantee, representation or warranty and accepts no responsibility or liability as to the accuracy, completeness, or reliability of the information contained herein. You should conduct a careful, independent investigation of the property and verify all information. Any reliance on this information is solely at your own risk. CBRE and the CBRE logo are service marks of CBRE, Inc. All other marks displayed on this document are the property of their respective owners, and the use of such marks does not imply any affiliation with or endorsement of CBRE. Photos herein are the property of their respective owners. Use of these images without the express written consent of the owner is prohibited.