



FOR LEASE

THE SKY IS THE LIMIT.

4320 MAIN STREET, DALLAS, TX

THE LAYOUT

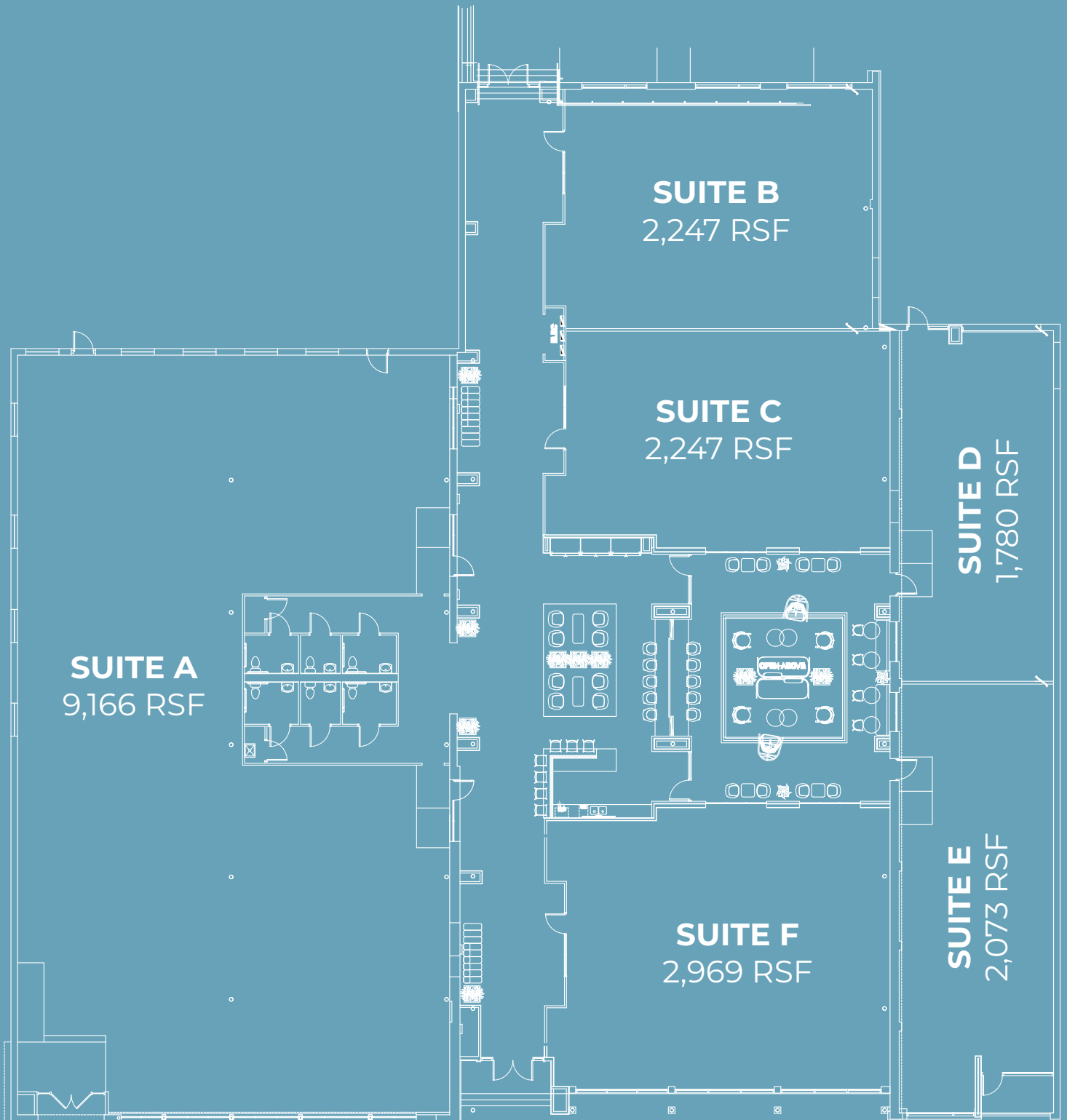

THE DETAILS

BUILDING

Under Redevelopment Construction
Expected Delivery April 2024

COMMON AREA CORRIDOR

Restrooms, Kitchen, Breakroom, and
Outdoor Courtyard

ARCHITECTURAL FEATURES

Skylights and Large Windows
Abundance of Natural Light
Authentic Creative Elements
Exposed Brick

TENANT BENEFITS

Tenant Improvement Allowance Available
Landlord Can Provide a Turnkey Build Out

AVAILABLE

2,500 - 21,000 SF Suites

AREA

Tower 22 District

PARKING

Ample Reserved Parking
Street Parking on Eastside Avenue

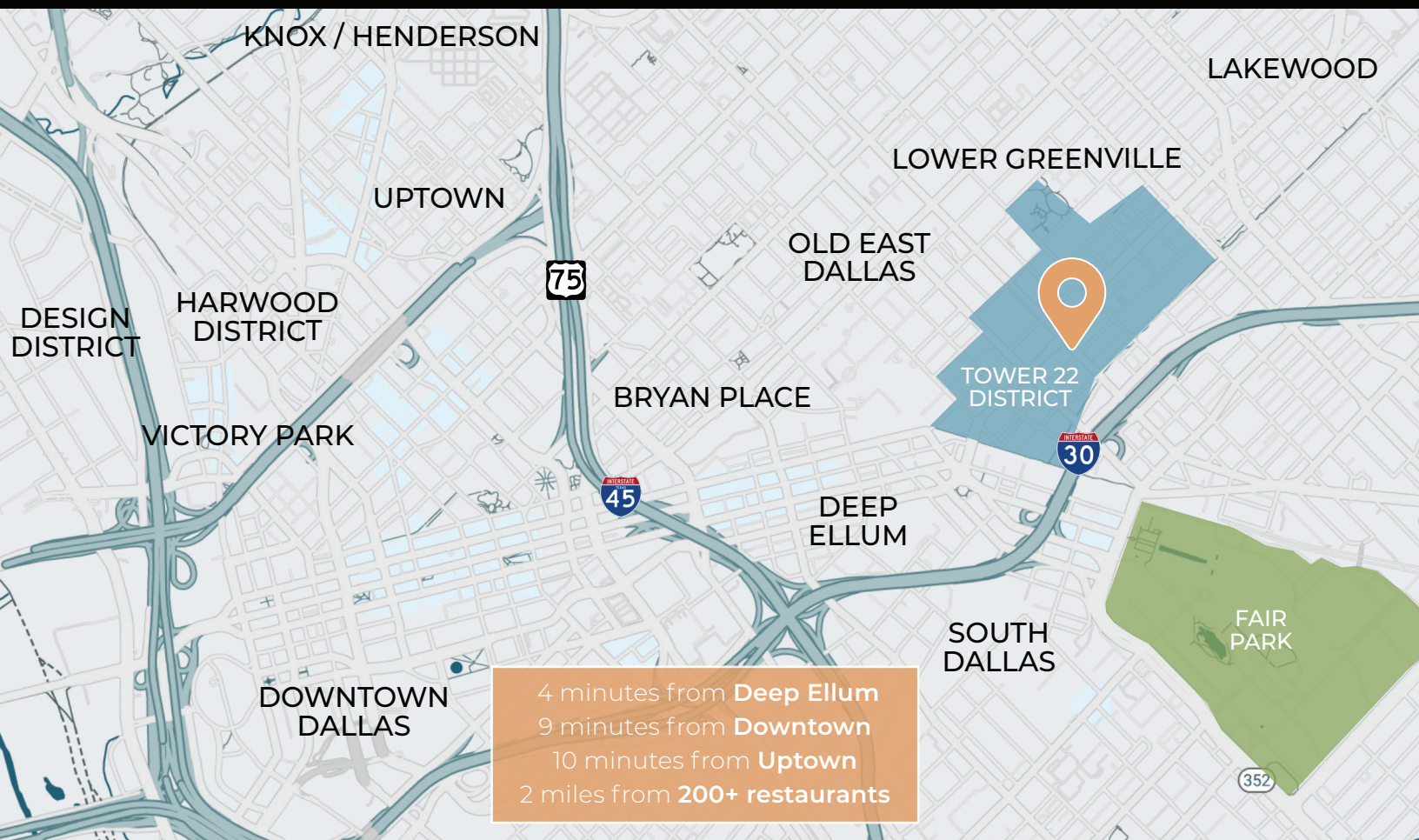



THE SPACE

