

FOR LEASE

TURNKEY ANN ARBOR RESTAURANT SPACE

3365 WASHTENAW AVE, ANN ARBOR, MI 48104

1,650 SF
AVAILABLE



PROPERTY DETAILS

\$26.00/SF NNN

\$7.00/SF

RENT

NNN

LOCATION: 3365 Washtenaw Ave,
Ann Arbor, MI 48104

PROPERTY TYPE: Shopping Center/ Restaurant

DATE AVAILABLE: Immediately

RENT: \$26.00/SF NNN

NNN EXPENSE: \$7.00/SF

AVAILABLE SPACE: 1,650 SF

IMPROVEMENTS: All equipment is one year old:

- Walk-In Freezer and Cooler
- Under-Counter Freezer and Refrigerator
- Stainless Table Tops
- Three-Door Glass Merchandiser
- Captive Air Hood
- High-End Hot Water Heater

*More Details Provided Upon Request

TRAFFIC COUNT: Washtenaw Ave (29,583 CPD)
Huron Pkwy (13,537 CPD)

HIGHLIGHTS

- Turnkey Restaurant Space for Sublease
- All Equipment is Included (Full List Available Upon Request)
- Excellent Visibility from the Heavily Trafficked Washtenaw Ave.
- Close Proximity to Downtown Ann Arbor and the University of Michigan
- Notable Surrounding National Retailers include Whole Foods, Nordstrom Rack, Arhaus, Shake Shack, Lulu Lemon, Sweetgreen, and a newly announced Chic-Fil-A.

EXCLUSIVELY LISTED BY:



ANTHONY J. VITALE

Director
avitale@landmarkcres.com
248 488 2620

MICRO AERIAL

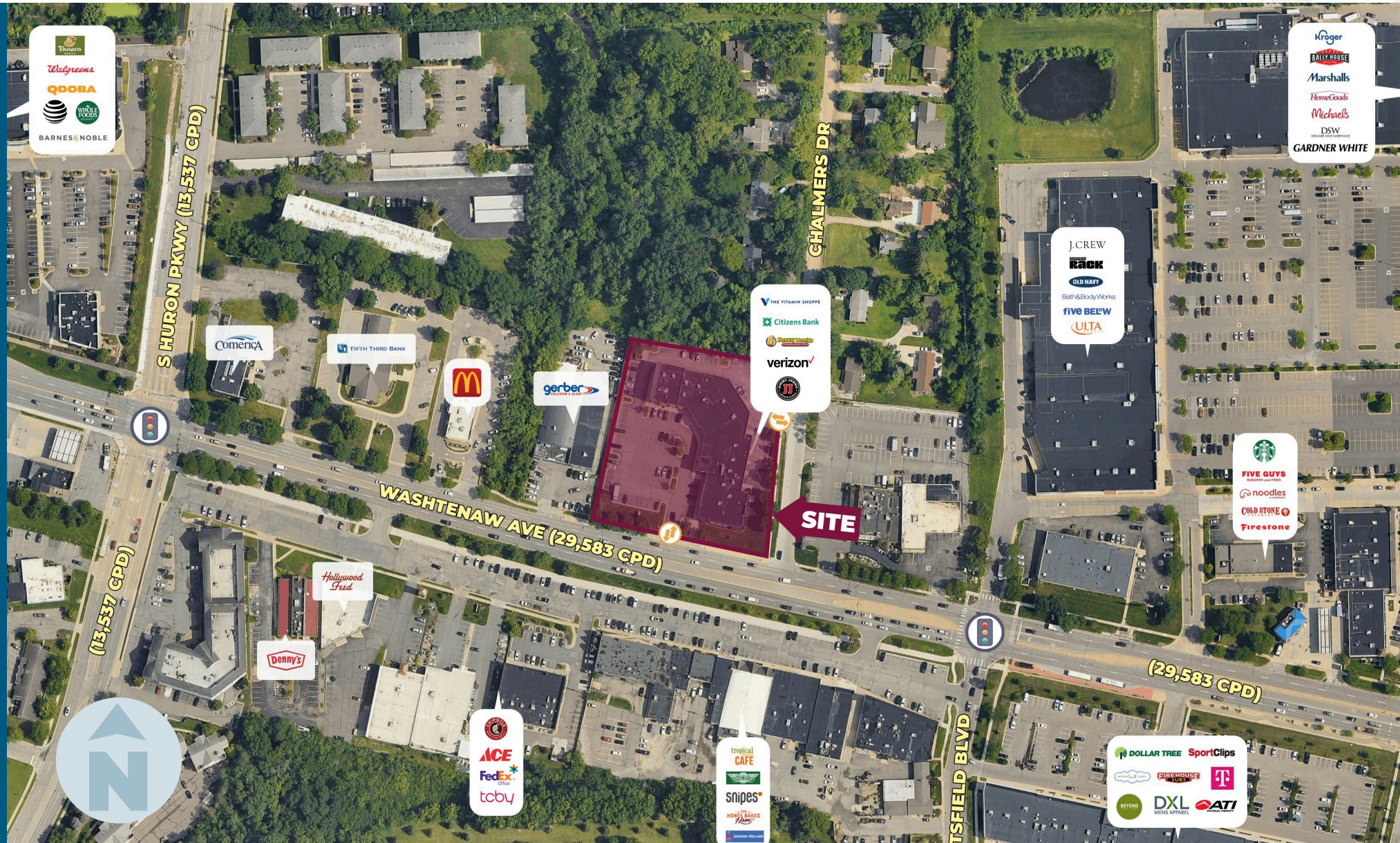

INTERIOR PHOTOS



INTERIOR PHOTOS



INTERIOR PHOTOS



DEMOGRAPHICS

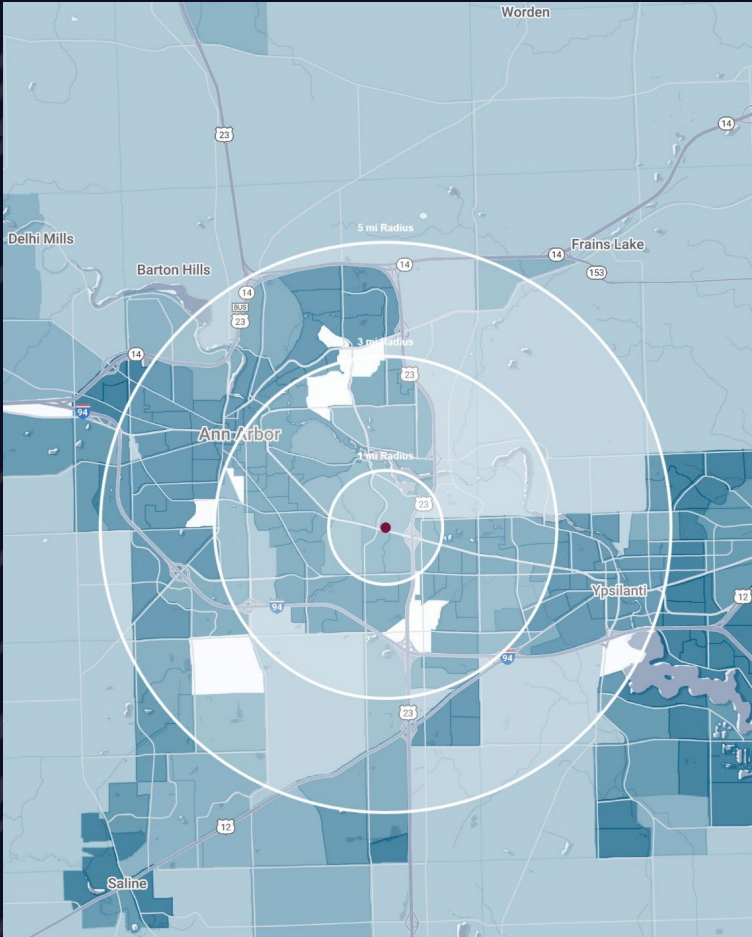

**TURNKEY ANN ARBOR
RESTAURANT SPACE**
3365 Washtenaw Ave, Ann Arbor, MI 48104

DEMOGRAPHICS

| POPULATION | 1 MILE | 3 MILE | 5 MILE |
|--|---------------|---------------|---------------|
| 2024 Estimated Population | 7,276 | 86,272 | 190,959 |
| 2029 Projected Population | 7,290 | 85,273 | 189,751 |
| 2020 Census Population | 7,258 | 88,841 | 195,289 |
| 2010 Census Population | 7,454 | 82,231 | 179,523 |
| Projected Annual Growth 2024 to 2029 | - | -0.2% | -0.1% |
| Historical Annual Growth 2010 to 2024 | -0.2% | 0.4% | 0.5% |
| HOUSEHOLDS | | | |
| 2024 Estimated Households | 3,348 | 34,377 | 80,887 |
| 2029 Projected Households | 3,471 | 34,974 | 83,080 |
| 2020 Census Households | 3,289 | 34,397 | 80,203 |
| 2010 Census Households | 3,279 | 32,441 | 74,317 |
| Projected Annual Growth 2024 to 2029 | 0.7% | 0.3% | 0.5% |
| Historical Annual Growth 2010 to 2024 | 0.2% | 0.4% | 0.6% |
| RACE | | | |
| 2024 Est. White | 67.6% | 65.7% | 65.8% |
| 2024 Est. Black | 12.3% | 12.6% | 12.6% |
| 2024 Est. Asian or Pacific Islander | 12.1% | 13.7% | 13.9% |
| 2024 Est. American Indian or Alaska Native | 0.3% | 0.2% | 0.2% |
| 2024 Est. Other Races | 7.6% | 7.9% | 7.6% |
| INCOME | | | |
| 2024 Est. Average Household Income | \$125,656 | \$103,192 | \$111,333 |
| 2024 Est. Median Household Income | \$77,102 | \$73,528 | \$79,170 |
| 2024 Est. Per Capita Income | \$57,862 | \$42,931 | \$48,342 |
| BUSINESS | | | |
| 2024 Est. Total Businesses | 558 | 3,672 | 8,405 |
| 2024 Est. Total Employees | 5,045 | 51,874 | 108,884 |

CONTACT US



**ANTHONY J.
VITALE**

Director

avitale@landmarkcres.com

248 488 2620

LANDMARK
COMMERCIAL ▲ REAL ESTATE ▲ SERVICES

30500 Northwestern Hwy, Suite 200
Farmington Hills, MI 48334
248.488.2620
landmarkcres.com

LANDMARK COMMERCIAL REAL ESTATE SERVICES – Licensed Real Estate Brokers. The information above has been obtained from sources believed reliable. While we do not doubt its accuracy, we have not verified it and make no guarantee, warranty or representation about it. It is your responsibility to independently confirm its accuracy and completeness. Any projections, opinions, assumptions or estimates are used for example only and do not represent the current or future performance of the property. The value of this transaction to you depends on tax and other factors which should be evaluated by your tax, financial and legal advisors. You and your advisors should conduct a careful, independent investigation of the property to determine to your satisfaction, the suitability of the property for your needs.